

SISTEMA®



DL-BM



BH



B6



30S



40S



60S



OMSJ

Elettropompe Sommerse
Submersed Electropump

Catalogue 2024

3OS series 3" oil-filled submersible motors

DL-BM series 3" submersible electric pumps

4OS series 4" oil-filled submersible motors

BH series 4" submersible electric pumps

BM series 4" submersible electric pumps

6OS series 6" oil-filled submersible motors

OMSY6 series 6" water-filled submersible motors

OMSJ6 series 6" water-filled submersible motors

B series 6" submersible pumps

- The state-of-art design and choice of component materials ensure optimum operating performances, superior quality, reliability and ease of installation.

SPECIFICATIONS

- Rewindable stator.
- Winding insulation: Class F .
- Protection grade: IP68.
- Filling fluid in compliance with standards concerning oils contact with foodstuffs and with the purity requirements specified by the annex to G.U. no. 104 of 20/04/1973; it also complies with F.D.A. (FOOD AND DRUG ADMINISTRATION) standards.
- Large compensation bellows for the expansion of the internal liquid.
- Mechanical seal with sand protection.
- Removable cable connector.
- Maximum immersion depth: 150 m.
- Maximum number of starts per hour at regular intervals: 30 for direct start.
- Maximum allowable voltage fluctuations over the rated voltage: 220 V \pm 10 %.

MODELS

- Single-phase:
from 0,25 to 1,5 kW, 220 V, 50 Hz.

OPTIONAL FEATURES

- Different voltage and frequency.
- Different materials.



IDENTIFICATION CODE

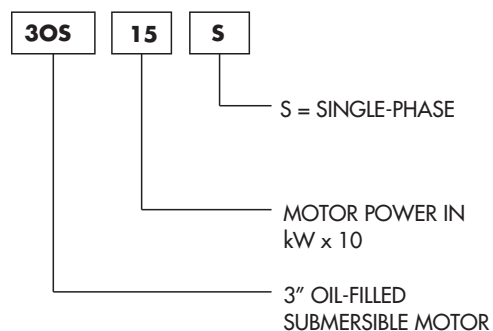

EXAMPLE OF MOTOR TYPE

30S15S

3" oil-filled submersible motor, single-phase,
1,5kW (2,0 Hp).

3OS SERIES MOTOR CROSS SECTION AND TABLE OF MATERIAL

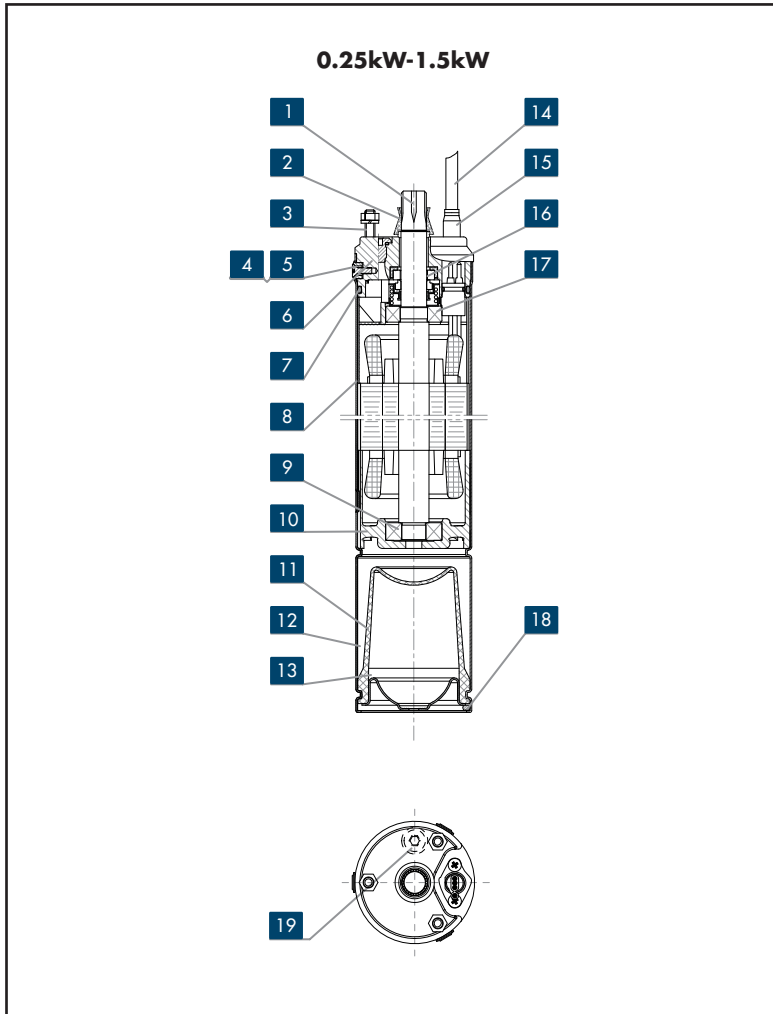

REF.N.	PART	MATERIAL	STANDARD
1	Shaft extension	Stainless steel	AISI 420
2	Sand protection	NBR	-----
3	Screw	Stainless steel	AISI 304
4	Pin	Stainless steel	AISI 304
5	Screw	Stainless steel	AISI 304
6	Upper support	Cast iron & Stainless steel	ASTM 200A & AISI304
7	O-ring	NBR	-----
8	Motor shell	Stainless steel	AISI 304
9	Ball bearing	-----	-----
10	Lower support	Cast iron	ASTM 200A
11	Compensation bellow	NBR	-----
12	Cooling liquid	Non toxic oil	-----
13	Lower protection	Stainless steel	AISI 304
14	Cable	-----	-----
15	Cable connector sleeve	Stainless steel	AISI 304
16	Mechanical seal	Carbon/Ceramic	-----
17	Ball bearing	-----	-----
18	Snap ring	Stainless steel	AISI 304
19	Filling screw	Stainless steel	AISI 304

DIMENSIONS AND WEIGHTS AT 50 Hz

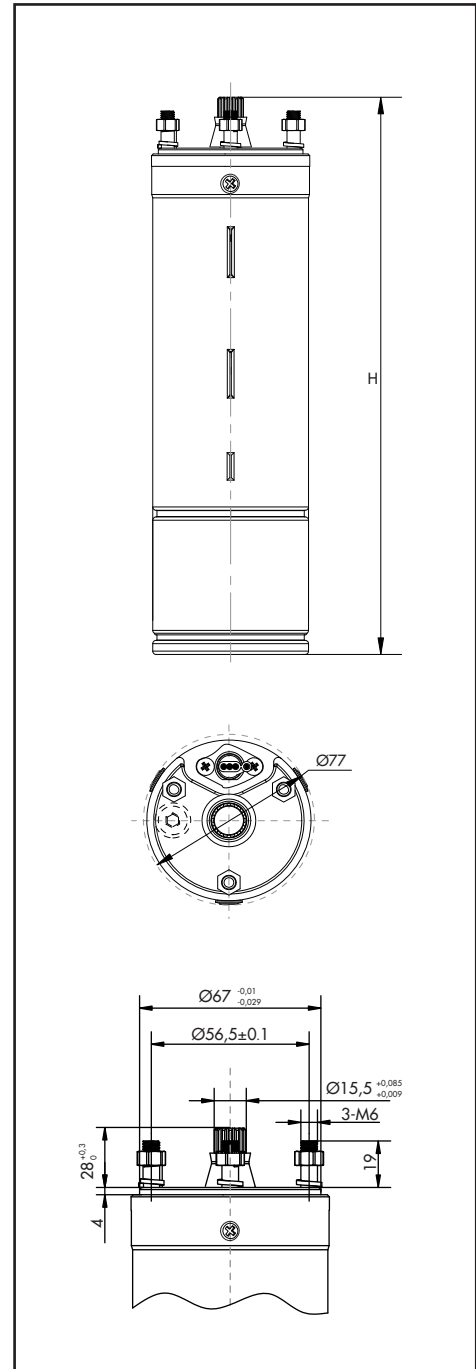

MOTOR TYPE	POWER		H mm	WEIGHT kg
	kW	Hp		
3OS02S	0,25	0,33	374,5	6,5
3OS03S	0,37	0,5	404,5	7,3
3OS05S	0,55	0,75	439,5	8
3OS07S	0,75	1	474,5	9
3OS11S	1,1	1,5	559,5	11
3OS15S	1,5	2	599,5	12,5

***COST-EFFECTIVE VERSION**

- Cost-effective submersible electric pumps ensure low cost, high efficiency, better performance and reliability.

APPLICATIONS

- Water supply from deep well.
- Agricultural irrigation.
- Pressure boosting.
- Industrial application.

SPECIFICATIONS

- Delivery: up to 4,2 m³/h at 2850 rpm.
- Head: up to 140 m at 2850 rpm.
- Maximum pump overall diameter (cable cover included): 80 mm.
- Maximum permissible quantity of sand: 150 g/m³.
- Delivery port Rp1" , Rp 1"1/4 .

MOTOR

- 3OS single-phase version:
from 0,25 to 1,5 kW, 220 V, 50 Hz.
- Horizontal operation: 3OS up to 1,5 kW.
- Maximum temperature of water in contact with motor: 35°C .

CONSTRUCTION & CHARACTERISTICS

- Cost-effective construction ensures low cost, high efficiency, better performance and reliability.
- Abrasion resistant construction, floating impellers ensure optimum resistance to abrasion.
- The hexagonal pump shaft guarantees an effective impeller driving.
- A non-return valve is fitted at the discharge to prevent back flow of water and alleviate water hammer to the pump, safeguarding impellers and diffusers.
- The DL-BM series pumps can be coupled with the 3OS motors.
- Vertical and horizontal installation .
- Standard and special versions available.

OPTIONAL FEATURES

- Different voltage and frequency.
- Different materials.



DL-BM SERIES

HYDRAULIC PERFORMANCE RANGE AT 50 Hz

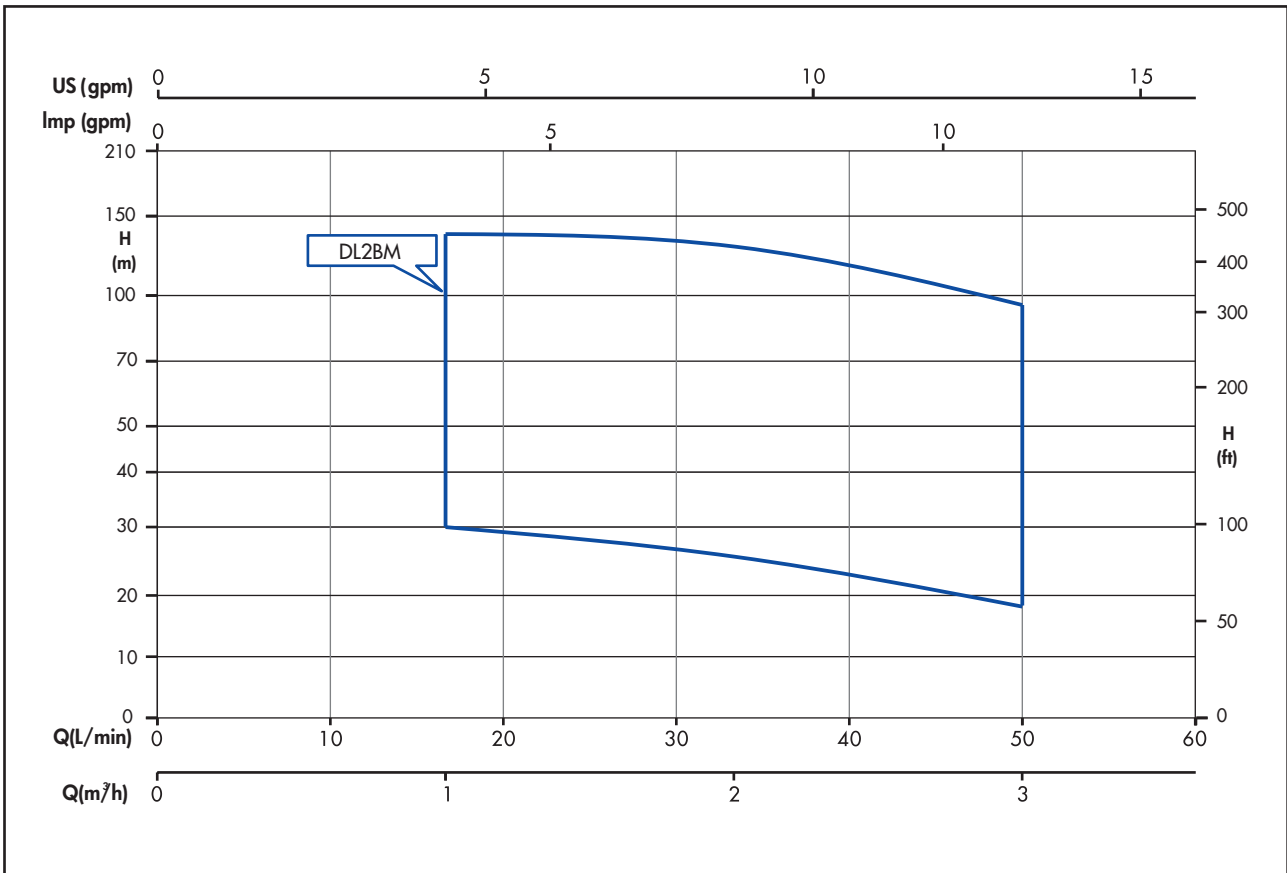

IDENTIFICATION CODE

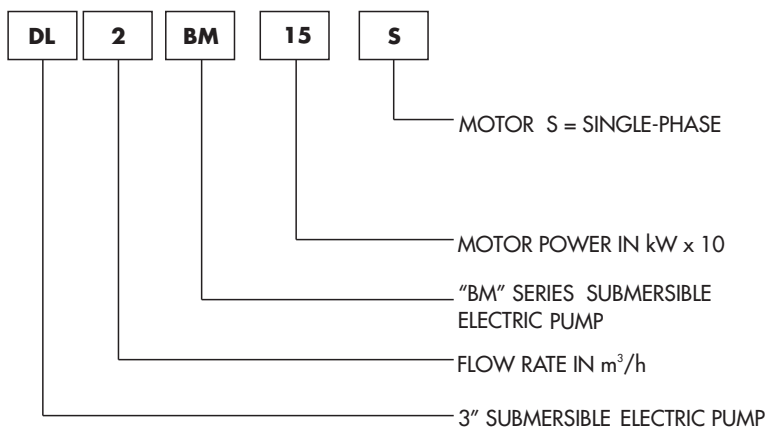

EXAMPLE OF PUMP TYPE

DL2BM15S

DL-BM series 3" submersible electric pump with flow rate of 2 m³/h; and single-phase 1,5 kW (2,0 Hp) motor.



PUMP SECTION AND LIST OF MAIN COMPONENTS MATERIAL

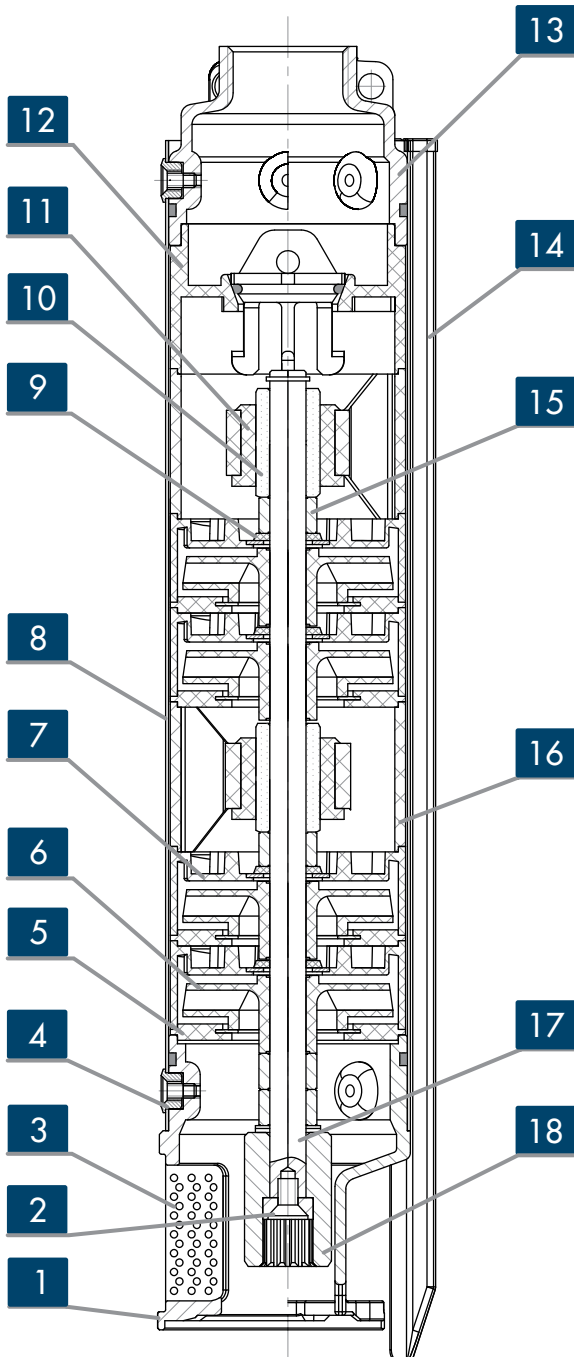

REF.N.	PART	MATERIAL	STANDARD
1	Lower support	Precision-cast stainless steel	AISI 304
2	Screw	Stainless steel	AISI 304
3	Filter	Stainless steel	AISI 304
4	Pin	Stainless steel	AISI 304
5	Guide plate	ABS	-----
6	Impeller	ABS	-----
7	Diffuser	ABS	-----
8	Outer sleeve	Stainless steel	AISI 304
9	Wearing gasket	NBR	-----
10	Shaft sleeve	Stainless steel	AISI 304
11	Bush bearing	TPU	-----
12	Upper support	ABS	-----
13	Delivery port	Precision-cast stainless steel	AISI 304
14	Cable guard	Stainless steel	AISI 304
15	Shaft sleeve	Stainless steel	AISI 304
16	Intermediate support	ABS	-----
17	Shaft	Stainless steel	AISI 420
18	Coupling	Stainless steel	AISI 304

DL-BM SERIES

OPERATING CHARACTERISTICS AT 50 Hz

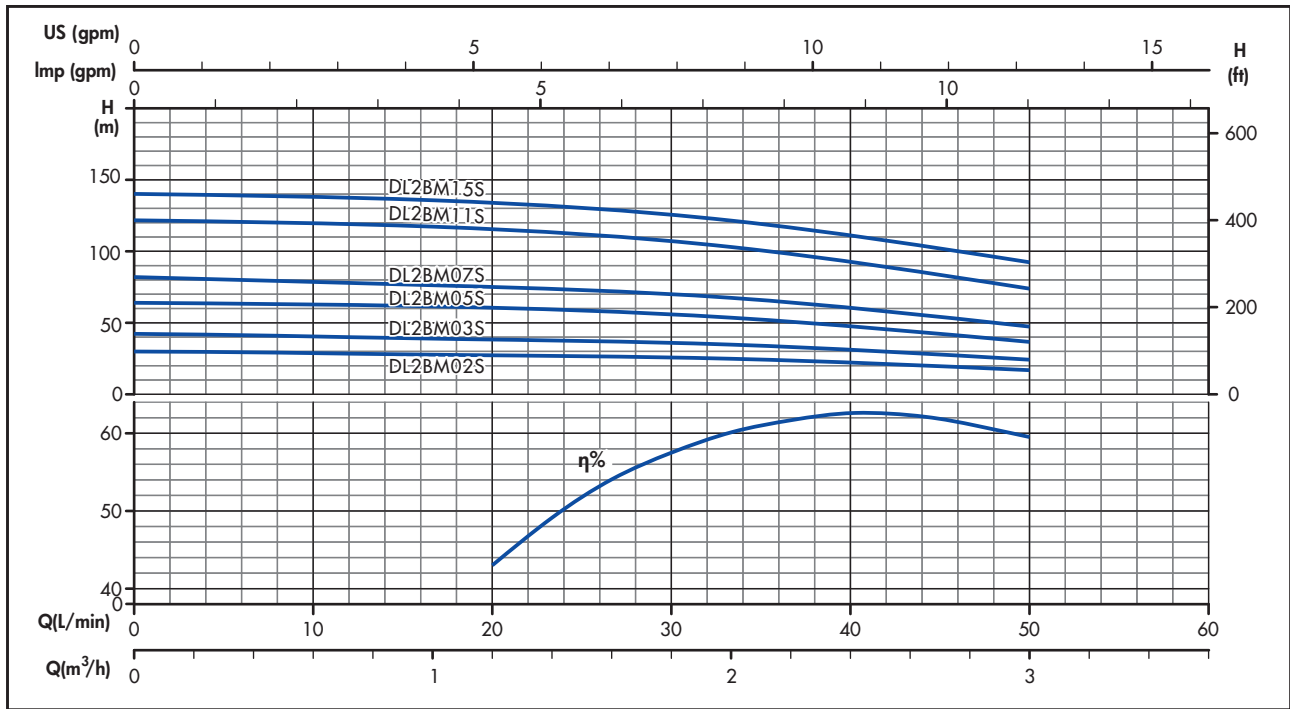

OPERATING CHARACTERISTICS AT 50 Hz

PUMP TYPE	N.OF STAGES	kW	Hp	Q=DELIVERY			
				l/min 0	17	33	50
				m³/h 0	1	2	3
H=TOTAL HEAD METERS COLUMN OF WATER							
DL2BM02S	8	0,25	0,33	30	28	25	18
DL2BM03S	11	0,37	0,5	42	40	35	25
DL2BM05S	16	0,55	0,75	64	60	53	37
DL2BM07S	21	0,75	1	81	78	68	48
DL2BM11S	31	1,1	1,5	121	116	103	75
DL2BM15S	37	1,5	2	140	138	123	90

DIMENSIONS AND WEIGHTS AT 50 Hz

PUMP TYPE	N.OF STAGES	DN	L1 mm	L mm	PUMP WEIGHT kg	ELECTRIC PUMP WEIGHT kg
DL2BM02S	8	Rp1"1/4	419	791	2,1	8,6
DL2BM03S	11		497	899	2,4	9,7
DL2BM05S	16		626	1063	3	11
DL2BM07S	21		796	1268	3,8	12,8
DL2BM11S	31		1096	1653	5,4	16,4
DL2BM15S	37		1251	1848	6,5	19,0

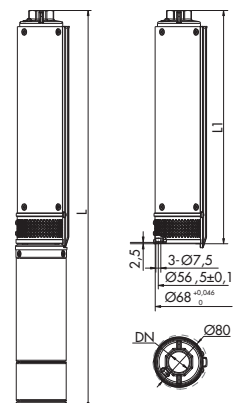

- The state-of-art design and choice of component materials ensure optimum operating performances, superior quality, reliability and ease of installation.

SPECIFICATIONS

- Shaft extension and couplings meet NEMA standards.
- Rewindable stator.
- Winding insulation: Class F .
- Protection grade: IP68.
- Filling fluid in compliance with standards concerning oils contact with foodstuffs and with the purity requirements specified by the annex to G.U. no. 104 of 20/04/1973; it also complies with F.D.A. (FOOD AND DRUG ADMINISTRATION) standards.
- Large compensation bellows for the expansion of the internal liquid.
- Oversized thrust bearings: Shaft supported by oversized angular bearings which can support thrust load up to 6500 N.
- Mechanical seal with sand protection.
- Removable cable connector.
- Maximum immersion depth: 150 m.
- Maximum number of starts per hour at regular intervals: 30 for direct start.
- Maximum allowable voltage fluctuations over the rated voltage:
 - 220 V \pm 10 %
 - 380 V \pm 10 %

MODELS

- Single-phase:
 - from 0,25 to 2,2 kW, 220 V, 50 Hz.
- Three-phase:
 - from 0,37 to 2,2 kW, 220 V, 50 Hz.
 - from 0,37 to 7,5 kW, 380 V, 50 Hz.

OPTIONAL FEATURES

- Different voltage and frequency.
- Different materials.



IDENTIFICATION CODE

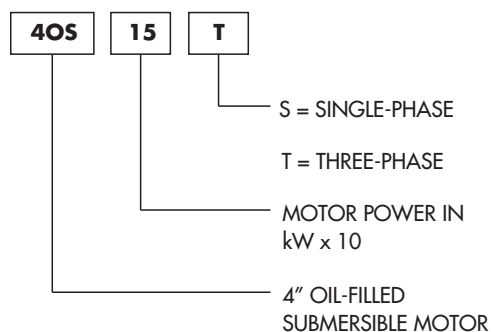

EXAMPLE OF MOTOR TYPE

4OS15T

4" oil-filled submersible motor, three-phase
1,5kW (2 Hp).

4OS SERIES MOTOR CROSS SECTION AND TABLE OF MATERIAL

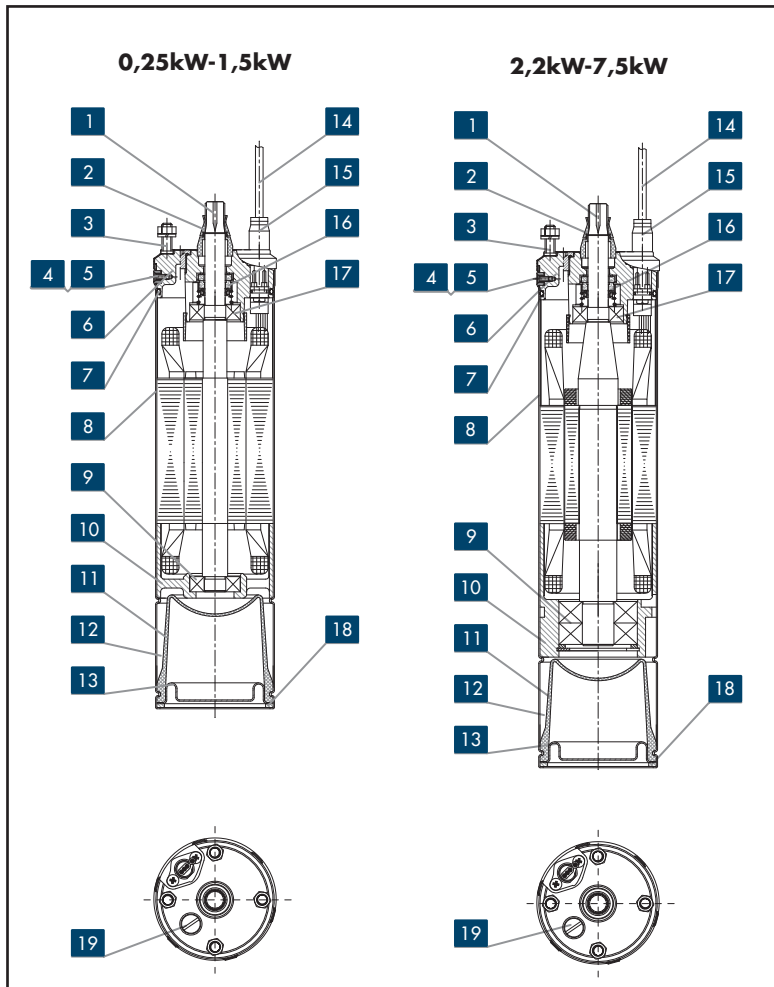

DIMENSIONS AND WEIGHTS AT 50 Hz

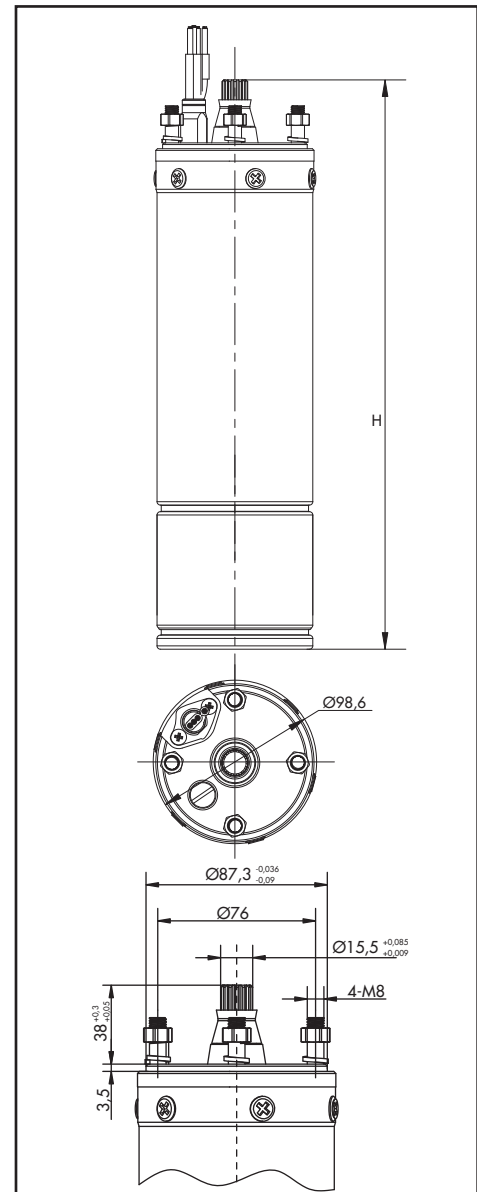

REF.N.	PART	MATERIAL	STANDARD
1	Shaft extension	Stainless steel	AIST 420(P≤1,5kW) AISI 630(2,2kW ≤ P ≤ 7,5kW)
2	Sand protection	NBR	-----
3	Double ends studs	Stainless steel	AISI 304
4	Pin	Stainless steel	AISI 304
5	Screw	Stainless steel	AISI 304
6	Upper support	Cast iron & Stainless steel/Brass	ASTM 200A & AISI304/ASTM 37700
7	O-ring	NBR	-----
8	Motor shell	Stainless steel	AISI 304
9	Angular bearing	-----	-----
10	Lower support	Cast iron	ASTM 200A
11	Compensation bellow	NBR	-----
12	Cooling liquid	Non toxic oil	-----
13	Lower protection	Stainless steel	AISI 304
14	Cable	-----	-----
15	Cable connector sleeve	Stainless steel	AISI 304
16	Mechanical seal	Carbon/Ceramic	-----
17	Ball bearing	-----	-----
18	Snap ring	Stainless steel	AISI 304
19	Filling screw	Stainless steel	AISI 304

MOTOR TYPE	POWER		H mm	WEIGHT kg
	kW	Hp		
4OS02S	0,25	0,33	356,5	7,4
4OS03S	0,37	0,5	366,5	7,8
4OS03T			366,5	7,4
4OS05S	0,55	0,75	381,5	8,5
4OS05T			376,5	7,6
4OS07S	0,75	1	401,5	9,4
4OS07T			396,5	8,5
4OS11S	1,1	1,5	432,5	10,7
4OS11T			432,5	10
4OS15S	1,5	2	472,5	12,6
4OS15T			457,5	11,1
4OS22S	2,2	3	585	17,3
4OS22T			510	13,7
4OS30T	3	4	560	16
4OS40T	4	5,5	634	20,9
4OS55T	5,5	7,5	744	27,2
4OS75T	7,5	10	829	32,1



- State-of-art hydraulic design and the choice of best material ensure high efficiency, best performance and reliability.

APPLICATIONS

- Water supply from deep well.
- Agricultural irrigation.
- Pressure boosting.
- Fire-fighting.
- Industrial application.

SPECIFICATIONS

- Delivery: up to 22 m³/h at 2850 rpm.
- Head: up to 347 m at 2850 rpm.
- Maximum pump overall diameter (cable cover included): 99 mm.
- Maximum permissible quantity of sand: 150 g/m³.
- 1BH , 2BH , 3BH, 4BH , 6BH versions: delivery port Rp1"1/4.
- 8BH , 12BH , 16BH versions: delivery port Rp2" .

MOTOR

- 4OS single-phase version:
from 0,25 to 2,2 kW, 220 V, 50 Hz.
- 4OS three-phase version:
from 0,37 to 2,2 kW, 220 V, 50 Hz.
from 0,37 to 7,5 kW, 380 V, 50 Hz.
- Horizontal operation: 4OS up to 2,2 kW.
- Maximum temperature of water in contact with motor: 35 °C .

CONSTRUCTION & CHARACTERISTICS

- Easy to maintain and rapid to install.
- Abrasion resistant construction, floating impellers ensure optimum resistance to abrasion.
- The delivery port and suction support are made of precision-cast stainless steel, guarantee resistance to corrosion, durability and a sturdy coupling to the motor.
- The hexagonal pump shaft guarantees an effective impeller driving.
- A stainless steel non-return valve is fitted at the discharge to prevent back flow of water and alleviate water hammer to the pump, safeguarding impellers and diffusers.
- The BH series pumps can be coupled with the 4OS motors.
- Vertical and horizontal installation.
- Standard and special versions available.

OPTIONAL FEATURES

- Different voltage and frequency.
- Different materials.

BH SERIES

HYDRAULIC PERFORMANCE RANGE AT 50 Hz

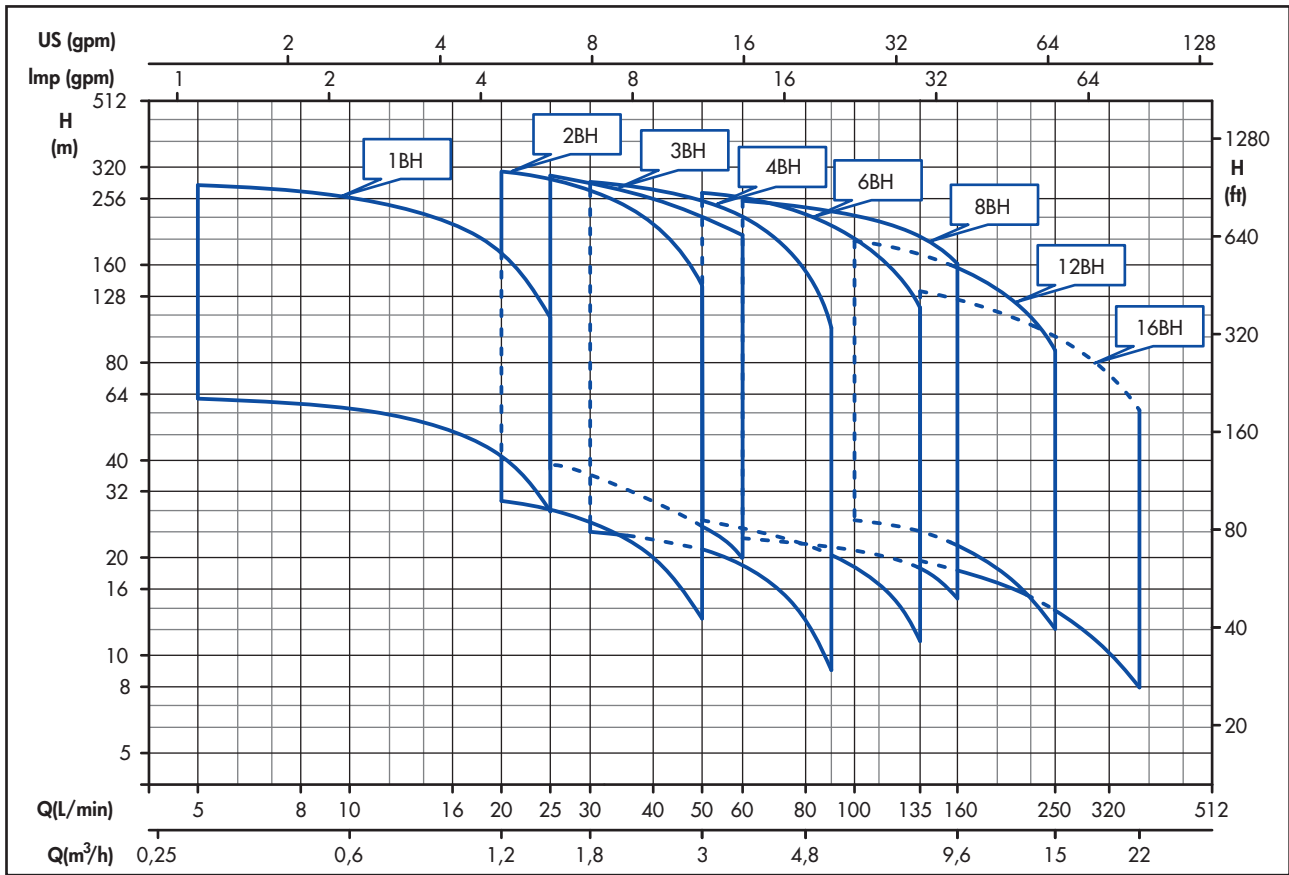

IDENTIFICATION CODE

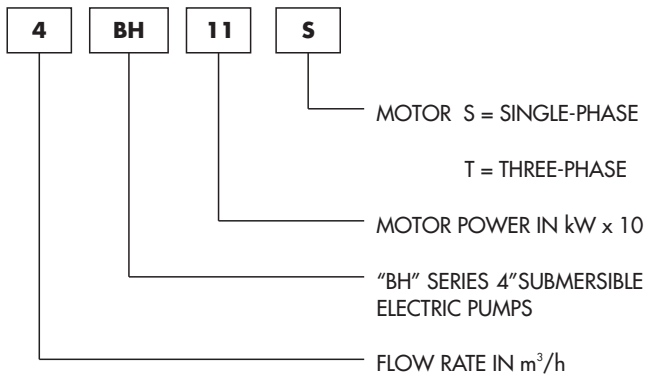

EXAMPLE OF PUMP TYPE

4BH11S

BH series 4" submersible electric pump with flow rate of $4 m^3/h$; and single-phase 1,1 kW (1,5 Hp) motor.



1BH-4BH SERIES

PUMP SECTION AND LIST OF MAIN COMPONENTS MATERIAL

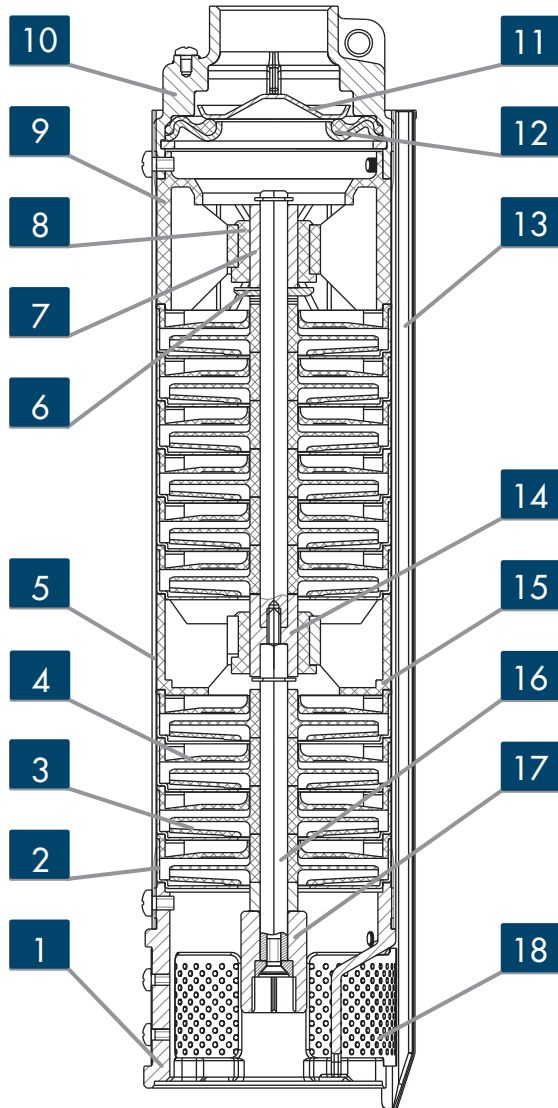

REF.N.	PART	MATERIAL	STANDARD
1	Lower support	Precision-cast stainless steel	AISI 304
2	Stage housing	Stainless steel	AISI 304
3	Impeller	Noryl® PPO	-----
4	Diffuser	Noryl® PPO	-----
5	Outer sleeve	Stainless steel	AISI 304
6	Thrust bearing	Stainless steel	AISI 304
7	Shaft sleeve	Stainless steel	AISI 304
8	Bush bearing	TPU	-----
9	Upper support	Noryl® PPO	-----
10	Delivery port	Precision-cast stainless steel	AISI 304
11	Non-return valve	Stainless steel	AISI 304
12	Valve support with gasket	Stainless steel & NBR	AISI 304 & -----
13	Cable guard	Stainless steel	AISI 304
14	Intermediate shaft sleeve	Stainless steel	AISI 304
15	Intermediate support	Noryl® PPO	-----
16	Shaft	Stainless steel	AISI 420
17	Coupling	Stainless steel	AISI 304
18	Filter	Stainless steel	AISI 304

6BH-8BH SERIES

PUMP SECTION AND LIST OF MAIN COMPONENTS MATERIAL

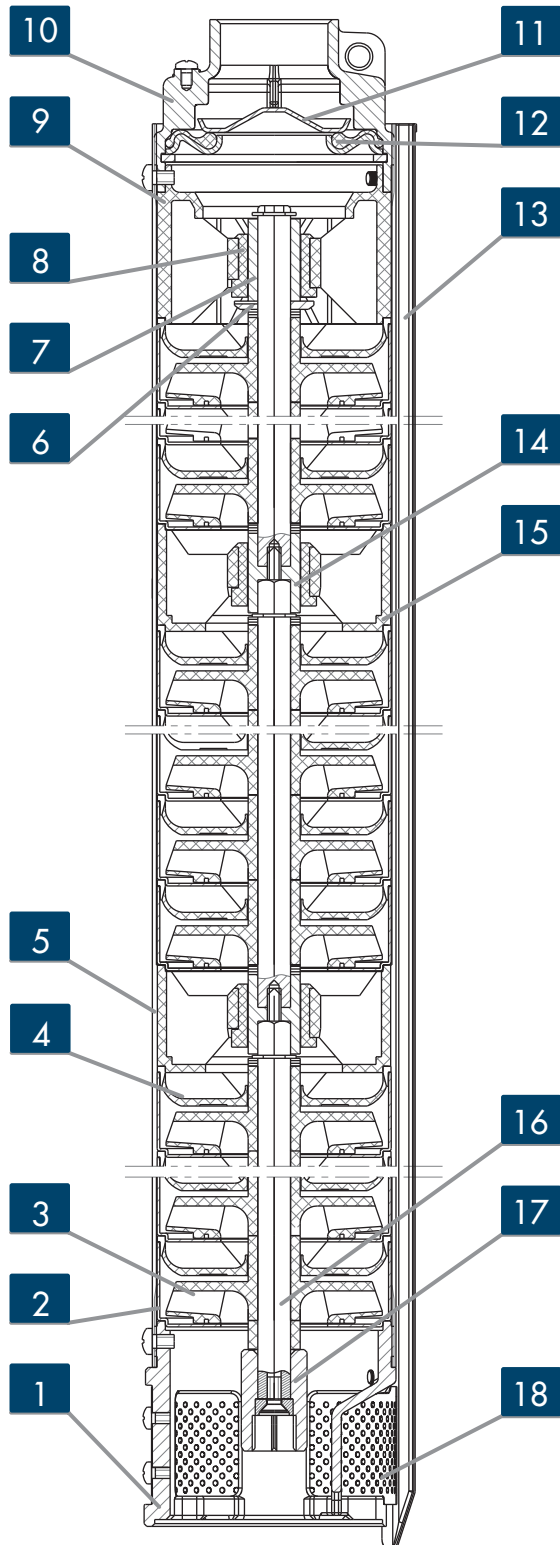

REF.N.	PART	MATERIAL	STANDARD
1	Lower support	Precision-cast stainless steel	AISI 304
2	Stage housing	Stainless steel	AISI 304
3	Impeller	Noryl® PPO	-----
4	Diffuser	Noryl® PPO	-----
5	Outer sleeve	Stainless steel	AISI 304
6	Thrust bearing	Stainless steel	AISI 304
7	Shaft sleeve	Stainless steel	AISI 304
8	Bush bearing	TPU	-----
9	Upper support	Noryl® PPO	-----
10	Delivery port	Precision-cast stainless steel	AISI 304
11	Non-return valve	Stainless steel	AISI 304
12	Valve support with gasket	Stainless steel & NBR	AISI 304& -----
13	Cable guard	Stainless steel	AISI 304
14	Intermediate shaft sleeve	Stainless steel	AISI 304
15	Intermediate support	Noryl® PPO	-----
16	Shaft	Stainless steel	AISI 420
17	Coupling	Stainless steel	AISI 304
18	Filter	Stainless steel	AISI 304

12BH SERIES

PUMP SECTION AND LIST OF MAIN COMPONENTS MATERIAL

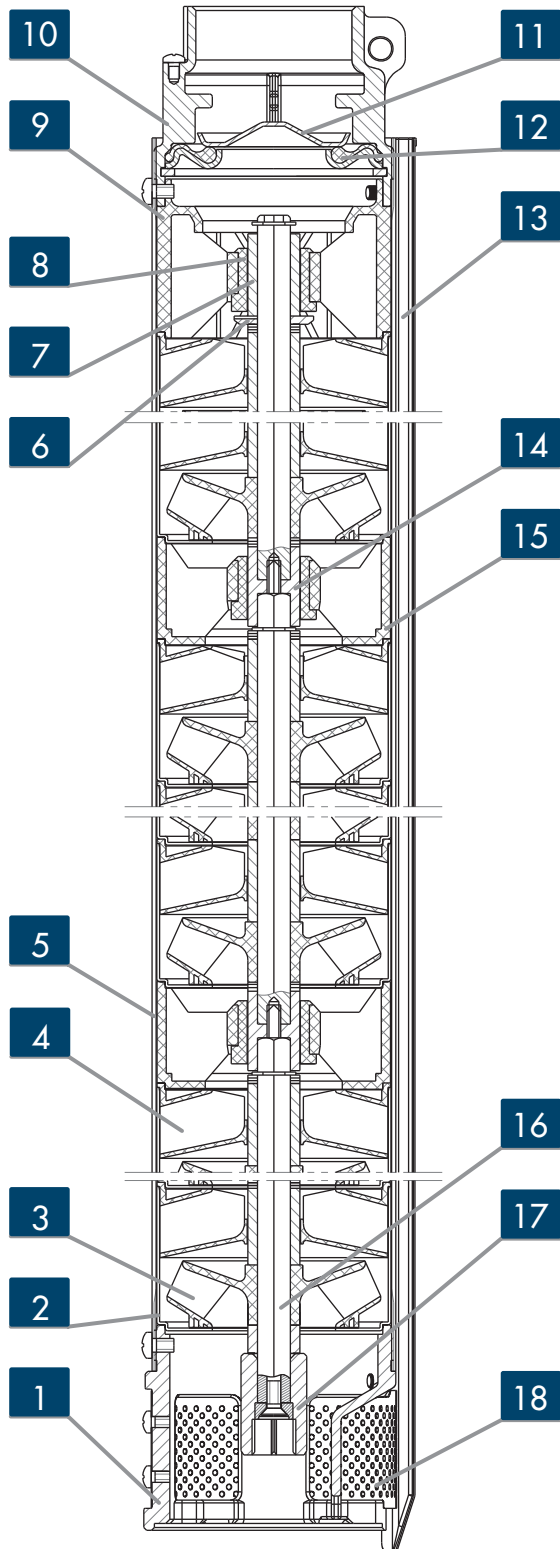

REF.N.	PART	MATERIAL	STANDARD
1	Lower support	Precision-cast stainless steel	AISI 304
2	Stage housing	Stainless steel	AISI 304
3	Impeller	Noryl® PPO	-----
4	Diffuser	Noryl® PPO	-----
5	Outer sleeve	Stainless steel	AISI 304
6	Thrust bearing	Stainless steel	AISI 304
7	Shaft sleeve	Stainless steel	AISI 304
8	Bush bearing	TPU	-----
9	Upper support	Noryl® PPO	-----
10	Delivery port	Precision-cast stainless steel	AISI 304
11	Non-return valve	Stainless steel	AISI 304
12	Valve support with gasket	Stainless steel & NBR	AISI 304 & -----
13	Cable guard	Stainless steel	AISI 304
14	Intermediate shaft sleeve	Stainless steel	AISI 304
15	Intermediate support	Noryl® PPO	-----
16	Shaft	Stainless steel	AISI 420
17	Coupling	Stainless steel	AISI 304
18	Filter	Stainless steel	AISI 304

16BH SERIES

PUMP SECTION AND LIST OF MAIN COMPONENTS MATERIAL

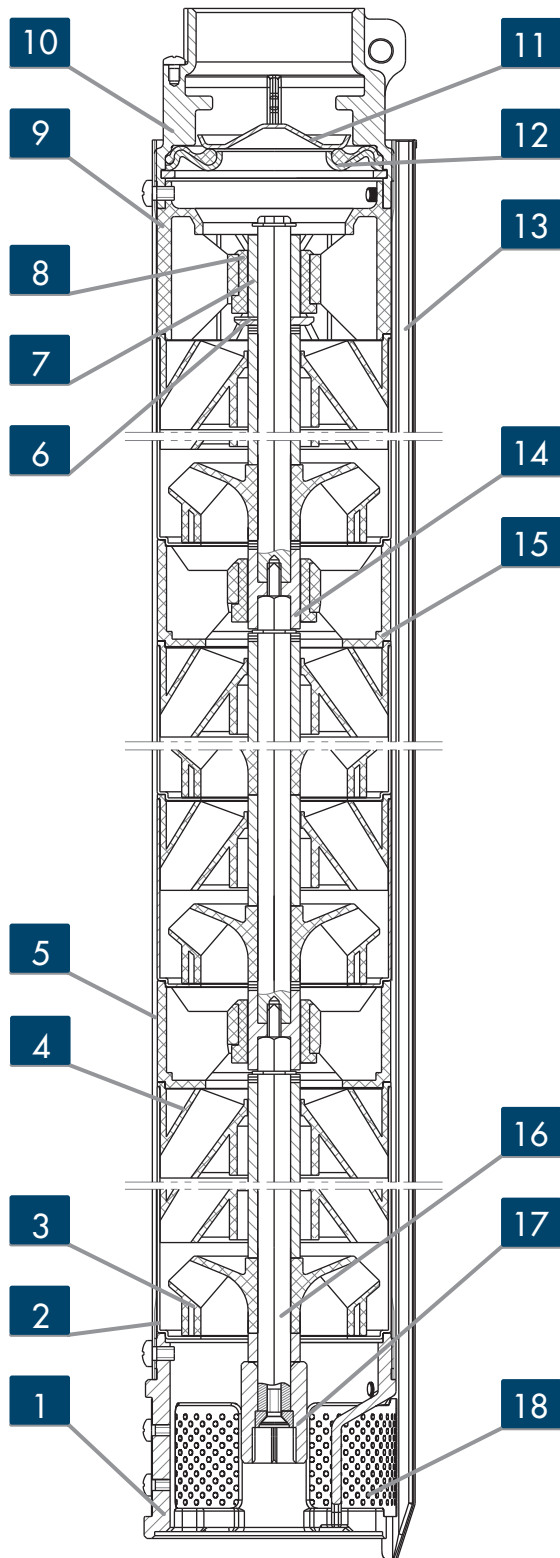

REF.N.	PART	MATERIAL	STANDARD
1	Lower support	Precision-cast stainless steel	AISI 304
2	Stage housing	Stainless steel	AISI 304
3	Impeller	Noryl® PPO	-----
4	Diffuser	Noryl® PPO	-----
5	Outer sleeve	Stainless steel	AISI 304
6	Thrust bearing	Stainless steel	AISI 304
7	Shaft sleeve	Stainless steel	AISI 304
8	Bush bearing	TPU	-----
9	Upper support	Noryl® PPO	-----
10	Delivery port	Precision-cast stainless steel	AISI 304
11	Non-return valve	Stainless steel	AISI 304
12	Valve support with gasket	Stainless steel & NBR	AISI 304& -----
13	Cable guard	Stainless steel	AISI 304
14	Intermediate shaft sleeve	Stainless steel	AISI 304
15	Intermediate support	Noryl® PPO	-----
16	Shaft	Stainless steel	AISI 420
17	Coupling	Stainless steel	AISI 304
18	Filter	Stainless steel	AISI 304

1BH SERIES

OPERATING CHARACTERISTICS AT 50 Hz

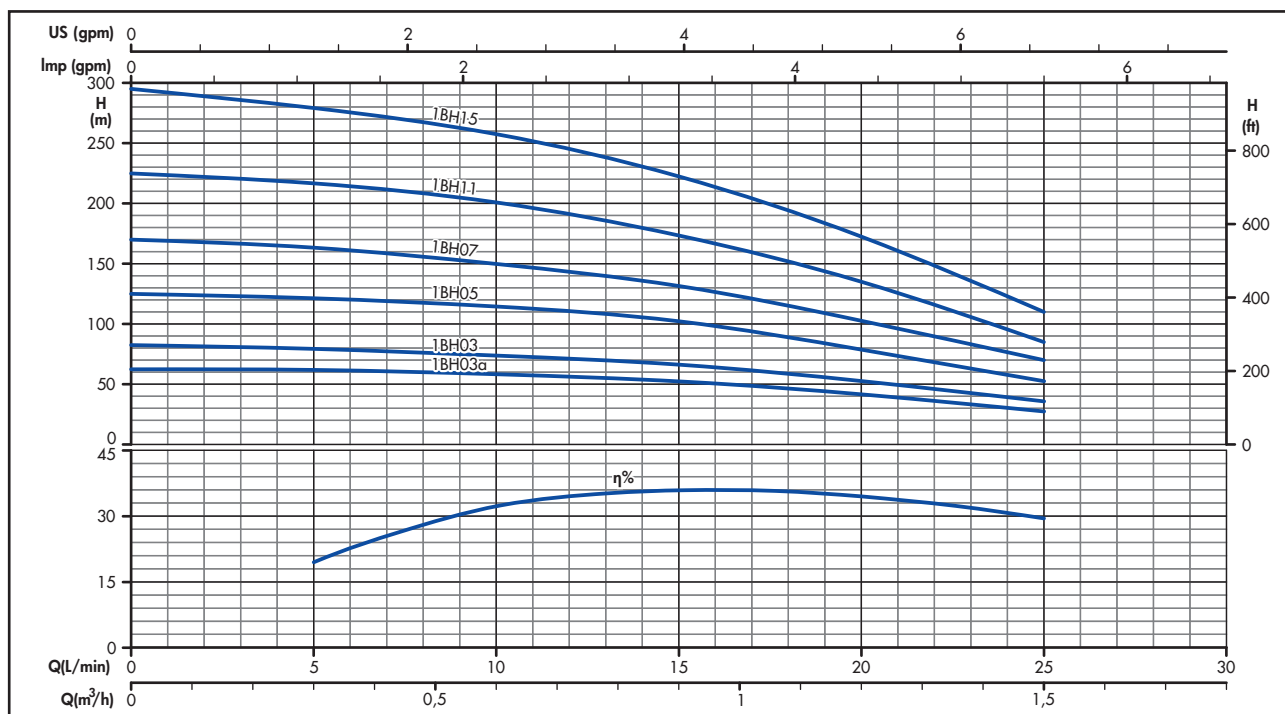

OPERATING CHARACTERISTICS AT 50 Hz

PUMP TYPE	N.OF STAGES	kW	Hp	Q=DELIVERY					
				l/min 0	5	10	15	20	25
				m³/h 0					
				0,3	0,6	0,9	1,2	1,5	
				H=TOTAL HEAD METERS COLUMN OF WATER					
1BH03S _a	10	0,37	0,5	64	62	57	52	40	28
1BH 03S	13	0,37	0,5	82	80	73	68	52	36
1BH 03T									
1BH 05S	19	0,55	0,75	125	120	110	102	76	54
1BH 05T									
1BH 07S	26	0,75	1	169	163	149	131	100	70
1BH 07T									
1BH 11S	37	1,1	1,5	225	218	200	172	135	85
1BH 11T									
1BH 15S	48	1,5	2	291	282	259	223	175	110
1BH 15T									

DIMENSIONS AND WEIGHTS AT 50 Hz

PUMP TYPE	N.OF STAGES	DN	L1 mm	L mm	PUMP WEIGHT kg	ELECTRIC PUMP WEIGHT kg
1BH03S _a	10	Rp1"1/4	321	647	3,5	11,7
1BH03S	13		367	693	4	12,2
1BH03T				693		11,8
1BH05S	19		460	801	5,1	14
1BH05T				796		13,1
1BH07S	26		567	928	6,4	16,2
1BH07T				923		15,3
1BH11S	37		774	1166	8,6	19,7
1BH11T				1166		19
1BH15S	48		943	1375	10,6	23,6
1BH15T				1360		22,1

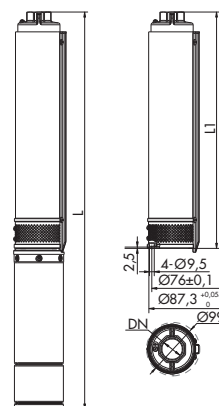

2BH SERIES

OPERATING CHARACTERISTICS AT 50 Hz

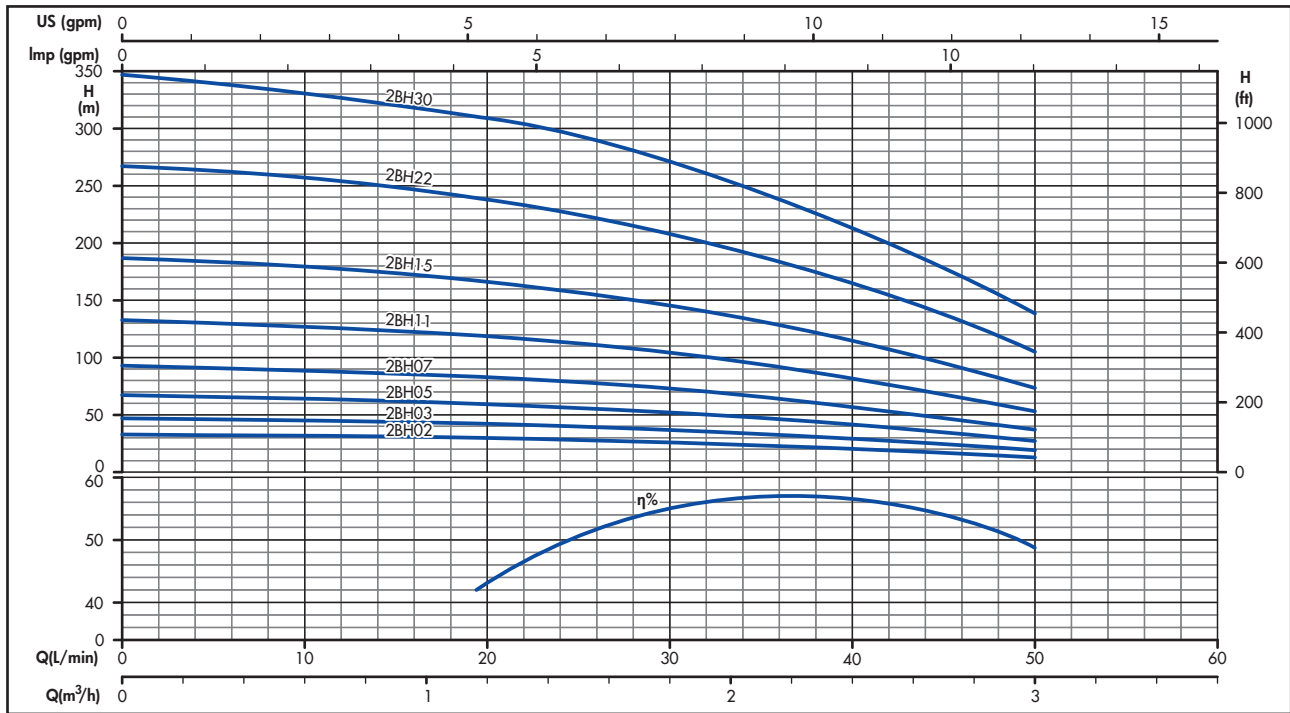

OPERATING CHARACTERISTICS AT 50 Hz

PUMP TYPE	N.OF STAGES	kW	Hp	Q=DELIVERY					
				l/min 0	20	25	30	40	50
				m³/h 0 1,2 1,5 1,8 2,4 3					
H=TOTAL HEAD METERS COLUMN OF WATER									
2BH02S	5	0,25	0,33	33	30	28	26	20	13
2BH03S	7	0,37	0,5	47	42	40	36	29	19
2BH03T									
2BH05S				67	60	56	52	41	27
2BH05T	10	0,55	0,75	93	83	79	73	57	37
2BH07S									
2BH07T									
2BH11S	20	1,1	1,5	133	119	113	104	82	53
2BH11T									
2BH15S				187	167	158	146	115	74
2BH15T	28	1,5	2	267	238	226	208	164	106
2BH22S									
2BH22T									
2BH30T	52	3	4	347	309	294	271	213	138

DIMENSIONS AND WEIGHTS AT 50 Hz

PUMP TYPE	N.OF STAGES	DN	L1 mm	L mm	PUMP WEIGHT kg	ELECTRIC PUMP WEIGHT kg
2BH02S	5	Rp1"1/4	258	574	2,3	10,1
2BH03S	7		294	620	2,7	10,9
2BH03T				620		10,5
2BH05S	10		348	689	3,2	12,1
2BH05T				684		11,2
2BH07S	14		421	782	3,9	13,7
2BH07T				777		12,8
2BH11S	20		529	921	5	16,1
2BH11T				921		15,4
2BH15S	28		673	1105	6,4	19,4
2BH15T				1090		17,9
2BH22S	40		927	1472	9,1	26,8
2BH22T				1397		23,2
2BH30T	52		1143	1663	11,2	27,7

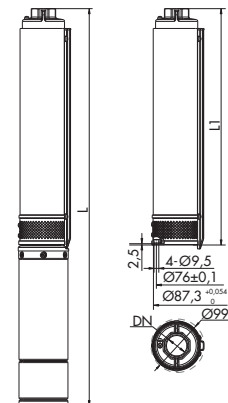

3BH SERIES

OPERATING CHARACTERISTICS AT 50 Hz

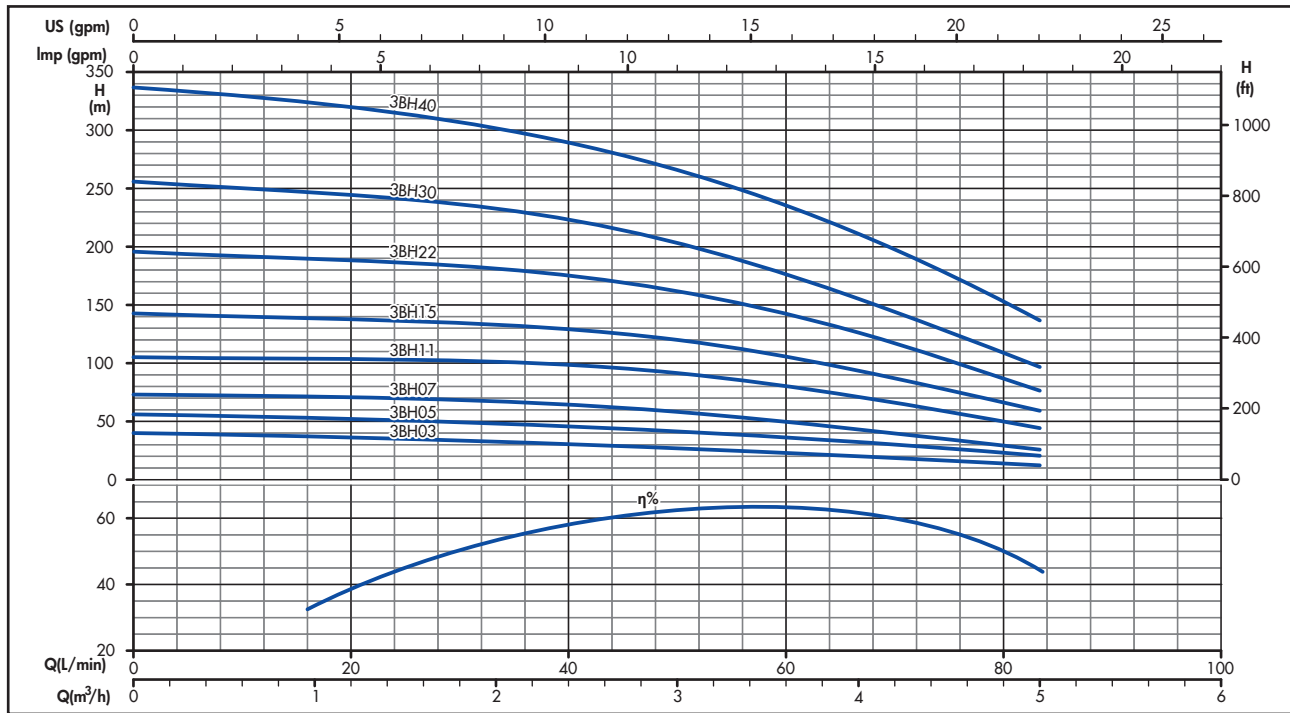

OPERATING CHARACTERISTICS AT 50 Hz

PUMP TYPE	N.OF STAGES	kW	Hp	Q=DELIVERY						
				l/min 0	17	33	50	67	84	
				m³/h 0	1	2	3	4	5	
H=TOTAL HEAD METERS COLUMN OF WATER										
3BH03S	6	0,37	0,5	40	39	37	33	25	15	
3BH03T										
3BH05S										
3BH05T	8	0,55	0,75	53	52	50	43	33	19	
3BH07S	11	0,75	1	72	71	67	59	44	24	
3BH07T										
3BH11S	16	1,1	1,5	108	107	103	90	69	43	
3BH11T										
3BH15S	21	1,5	2	142	141	136	121	96	63	
3BH15T										
3BH22S	30	2,2	3	196	195	185	164	126	78	
3BH22T										
3BH30T	40	3	4	253	251	237	208	155	87	
3BH40T	53	4	5,5	337	335	317	278	212	126	

DIMENSIONS AND WEIGHTS AT 50 Hz

PUMP TYPE	N.OF STAGES	DN	L1 mm	L mm	PUMP WEIGHT kg	ELECTRIC PUMP WEIGHT kg
3BH03S	6	Rp1"1/4	298	624	2,7	10,9
3BH03T				624		10,5
3BH05S				682		12,1
3BH05T	8		341	677	3,2	11,2
3BH07S				767	4	13,8
3BH07T	11		406	762	4	12,9
3BH11S	16		515	907	4,9	16
3BH11T				907		15,3
3BH15S	21		623	1055	5,9	18,9
3BH15T				1040		17,4
3BH22S	30		855	1400	8,1	25,8
3BH22T				1325		22,2
3BH30T	40		1072	1592	10,3	26,8
3BH40T	53		1355	1949	12,9	33,3

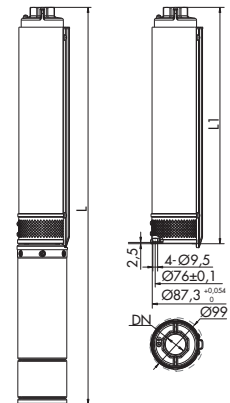

4BH SERIES

OPERATING CHARACTERISTICS AT 50 Hz

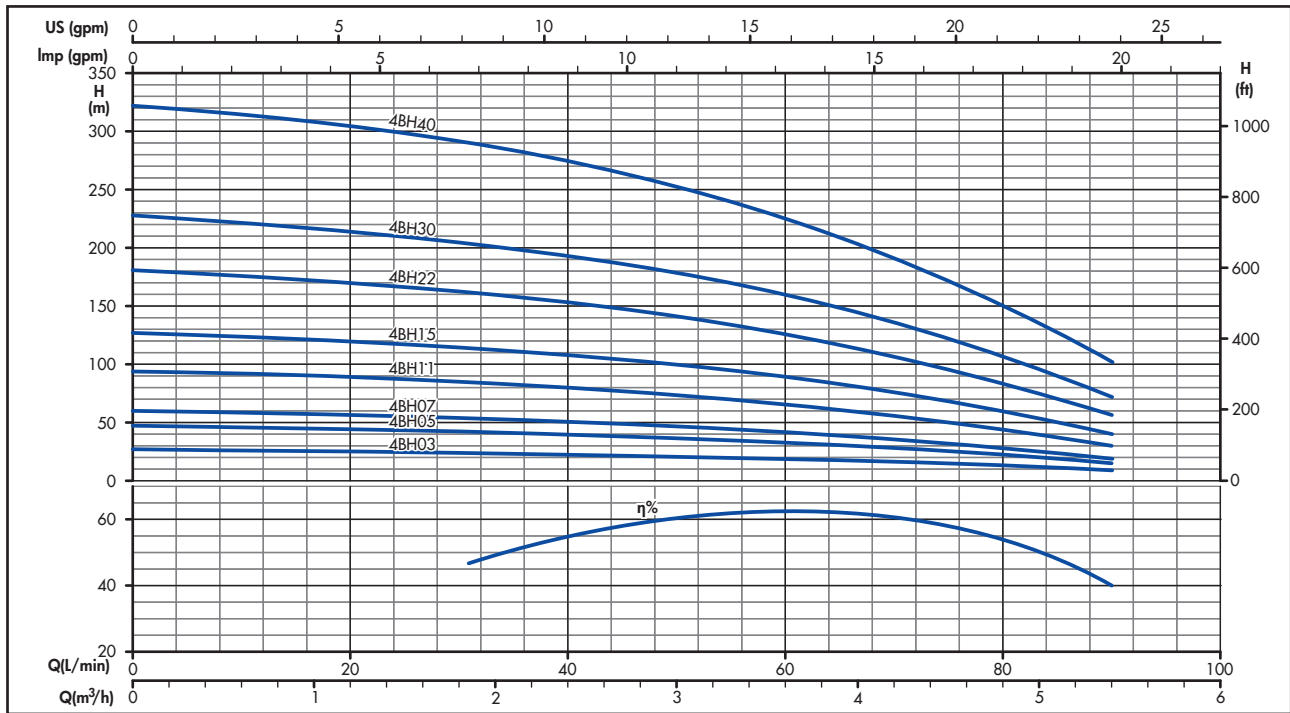

OPERATING CHARACTERISTICS AT 50 Hz

PUMP TYPE	N.OF STAGES	kW	Hp	Q=DELIVERY							
				l/min 0	30	40	50	60	80	90	
				m³/h 0 1,8 2,4 3 3,6 4,8 5,4							
H=TOTAL HEAD METERS COLUMN OF WATER											
4BH03S	4	0,37	0,5	27	24	23	21	19	13	9	
4BH03T											
4BH05S				7	0,55	0,75	47	42	40	37	33
4BH05T											
4BH07S	9	0,75	1				60	54	51	47	42
4BH07T											
4BH11S				14	1,1	1,5	94	84	80	74	66
4BH11T											
4BH15S	19	1,5	2				127	114	108	100	89
4BH15T											
4BH22S				27	2,2	3	181	162	154	142	127
4BH22T											
4BH30T	35	3	4				228	204	194	179	160
4BH40T	48	4	5,5	322	288	274	252	226	151	102	

DIMENSIONS AND WEIGHTS AT 50 Hz

PUMP TYPE	N.OF STAGES	DN	L1 mm	L mm	PUMP WEIGHT kg	ELECTRIC PUMP WEIGHT kg
4BH03S	4	Rp1"1/4	254	580	2,2	10,4
4BH03T				580		10
4BH05S	7		319	660	2,8	11,7
4BH05T				655		10,8
4BH07S	9		362	723	3,2	13
4BH07T				718		12,1
4BH11S	14		471	863	4,2	15,3
4BH11T				863		14,6
4BH15S	19		579	1011	5,2	18,2
4BH15T				996		16,7
4BH22S	27		790	1335	7,4	25,1
4BH22T				1260		21,5
4BH30T	35	964	1484	9	25,5	
4BH40T	48	1246	1840	11,6	33	

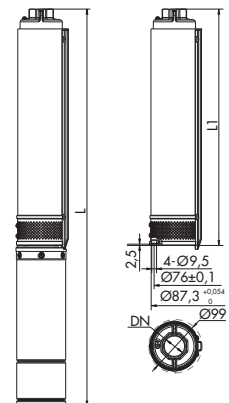

6BH SERIES

OPERATING CHARACTERISTICS AT 50 Hz

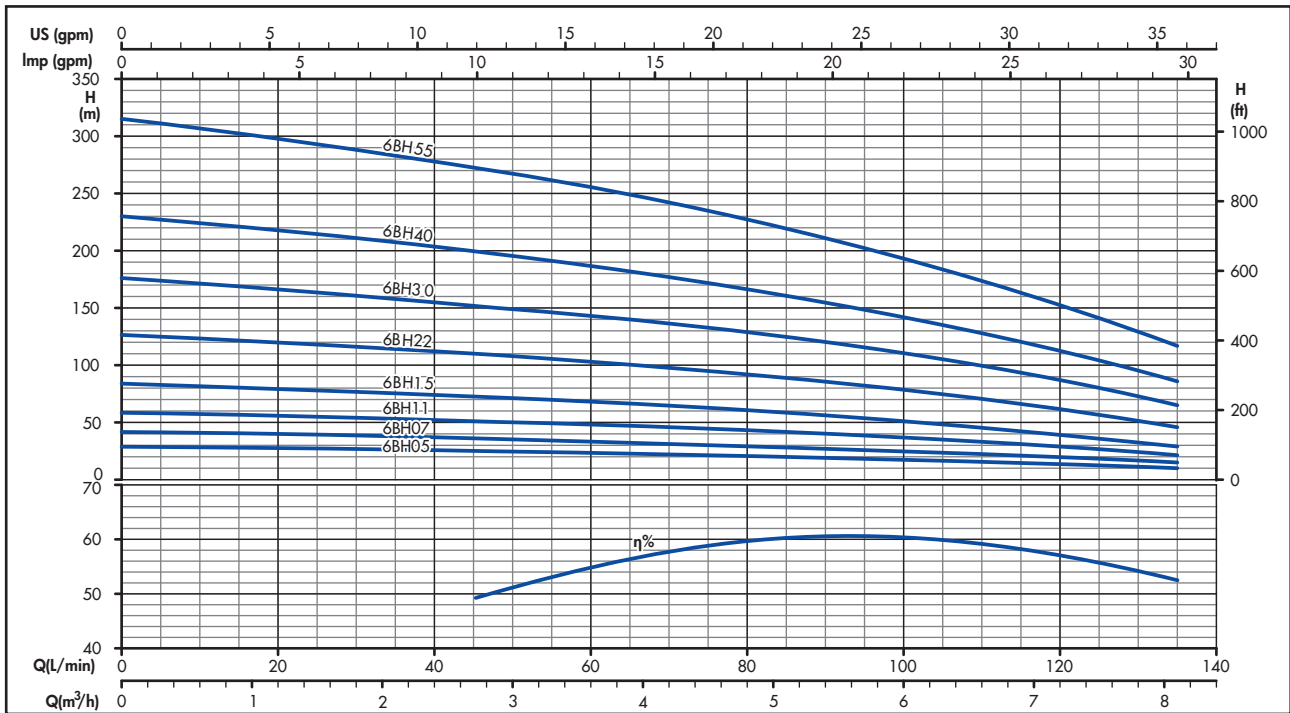

OPERATING CHARACTERISTICS AT 50 Hz

PUMP TYPE	N.OF STAGES	kW	Hp	Q=DELIVERY						
				l/min 0	60	75	90	105	120	135
				m³/h 0						
				3,6	4,5	5,4	6,3	7,2	8,1	
H=TOTAL HEAD METERS COLUMN OF WATER										
6BH05S	5	0,55	0,75	30	25	23	20	18	15	11
6BH05T										
6BH07S	7	0,75	1	43	35	32	28	24	20	15
6BH07T										
6BH11S	10	1,1	1,5	61	49	46	41	35	30	22
6BH11T										
6BH15S	14	1,5	2	85	69	64	57	50	41	31
6BH15T										
6BH22S	21	2,2	3	128	104	97	87	76	61	47
6BH22T										
6BH30T	29	3	4	177	143	132	119	105	85	66
6BH40T	38	4	5,5	232	188	172	156	136	112	86
6BH55T	52	5,5	7,5	317	257	235	213	185	152	118

DIMENSIONS AND WEIGHTS AT 50 Hz

PUMP TYPE	N.OF STAGES	DN	L1 mm	L mm	PUMP WEIGHT kg	ELECTRIC PUMP WEIGHT kg
6BH05S	5	Rp1"1/4	322	663	2,8	11,7
6BH05T				658		10,8
6BH07S	7		384	745	3,4	13,2
6BH07T				740		12,3
6BH11S	10		477	869	4,2	15,3
6BH11T				869		14,6
6BH15S	14		601	1033	5,2	18,2
6BH15T				1018		16,7
6BH22S	21		856	1401	7,6	25,3
6BH22T				1326		21,7
6BH30T	29		1104	1624	9,7	26,2
6BH40T	38		1383	1977	12,1	33,5
6BH55T	52		1854	2558	16,3	44

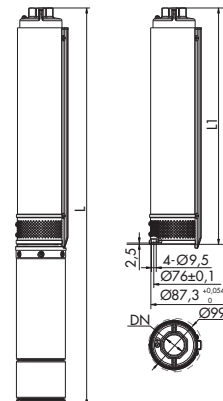

8BH SERIES

OPERATING CHARACTERISTICS AT 50 Hz

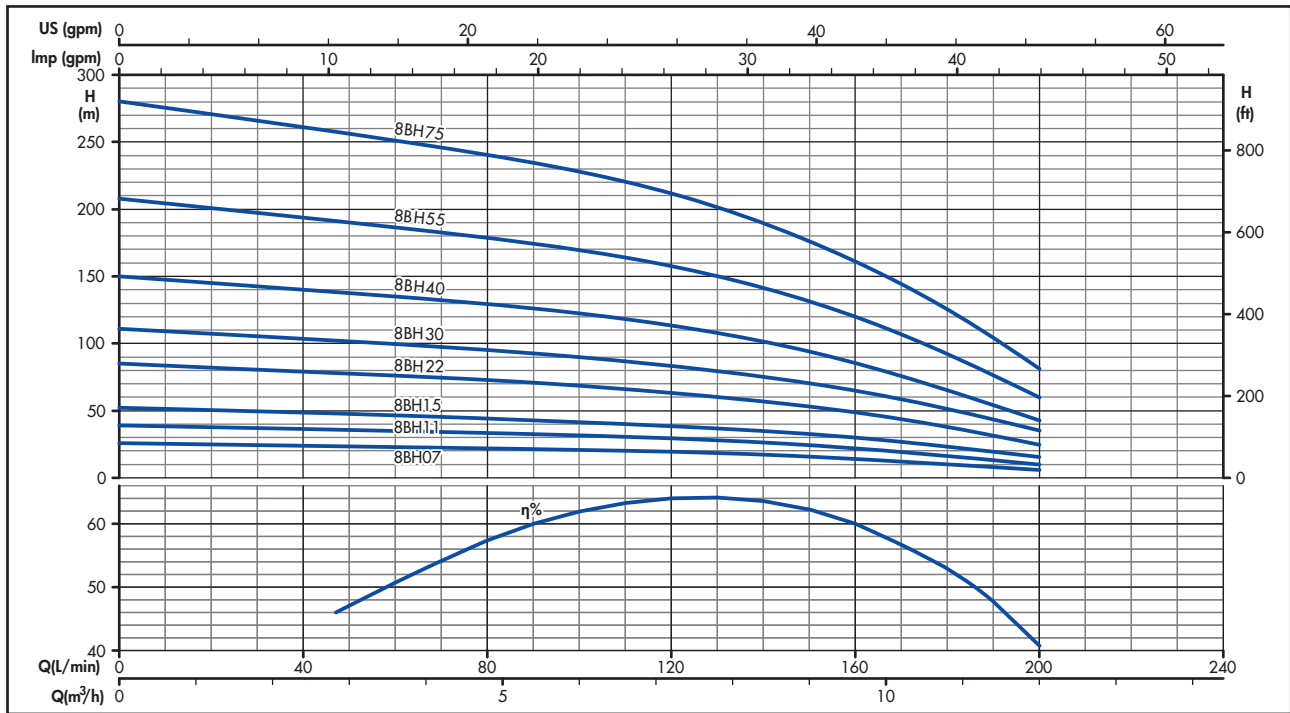

OPERATING CHARACTERISTICS AT 50 Hz

PUMP TYPE	N.OF STAGES	kW	Hp	Q=DELIVERY					
				l/min 0	40	80	120	160	200
				m³/h 0 2,4 4,8 7,2 9,6 12					
H=TOTAL HEAD METERS COLUMN OF WATER									
8BH07S	4	0,75	1	26	24	22	20	15	6
8BH07T									
8BH11S	6	1,1	1,5	39	36	34	29	22	10
8BH11T									
8BH15S	8	1,5	2	52	49	45	39	30	15
8BH15T									
8BH22S	13	2,2	3	85	79	73	64	49	25
8BH22T									
8BH30T	17	3	4	111	103	95	83	64	35
8BH40T	23	4	5,5	150	140	129	113	86	43
8BH55T	32	5,5	7,5	208	194	179	157	120	60
8BH75T	43	7,5	10	280	260	241	211	161	81

DIMENSIONS AND WEIGHTS AT 50 Hz

PUMP TYPE	N.OF STAGES	DN	L1 mm	L mm	PUMP WEIGHT kg	ELECTRIC PUMP WEIGHT kg
8BH07S	4	Rp2"	301	662	2,7	12,5
8BH07T				657		11,6
8BH11S	6		363	755	3,2	14,3
8BH11T				755		13,6
8BH15S	8		425	857	3,8	16,8
8BH15T				842		15,3
8BH22S	13		580	1125	5,2	22,9
8BH22T				1050		19,3
8BH30T	17		704	1224	6,3	22,8
8BH40T	23		928	1522	8,4	29,8
8BH55T	32		1207	1911	11	38,7
8BH75T	43		1585	2374	14,5	47,1

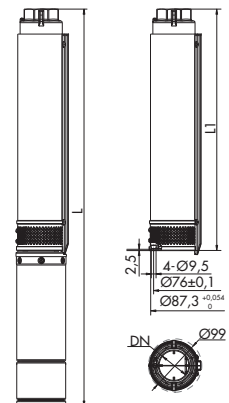

12BH SERIES

OPERATING CHARACTERISTICS AT 50 Hz

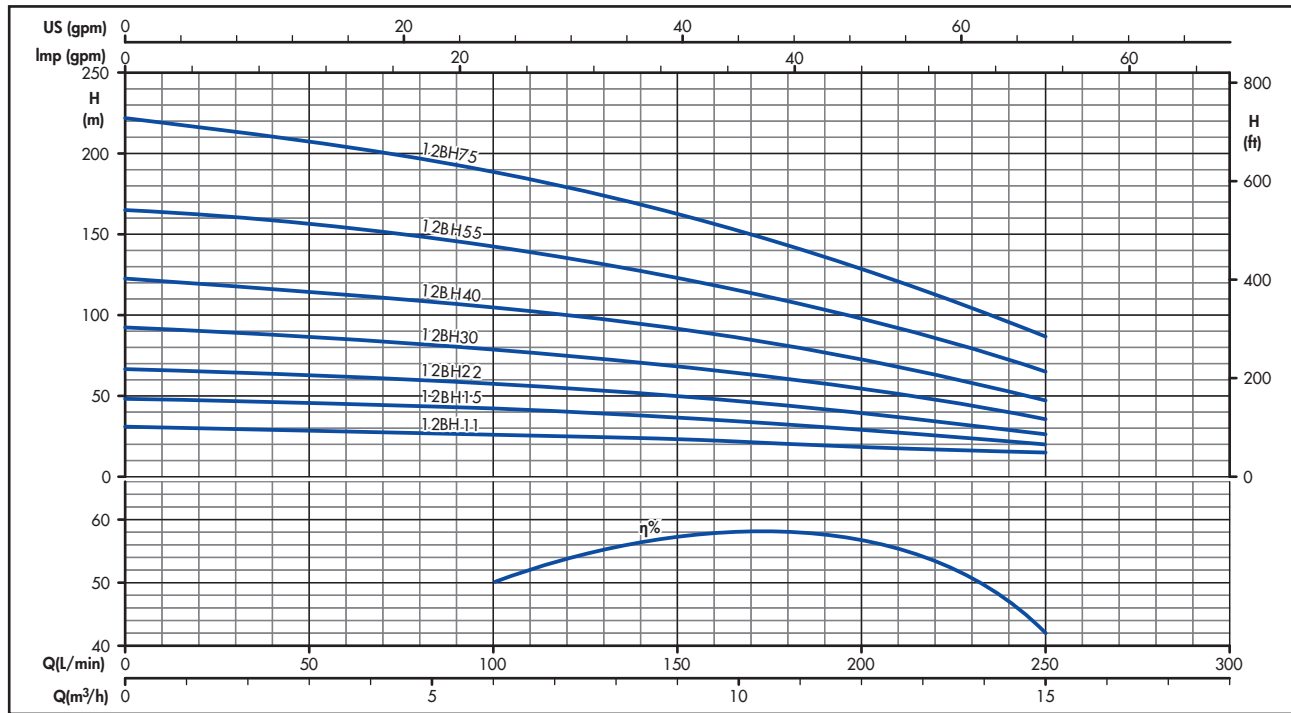

OPERATING CHARACTERISTICS AT 50 Hz

PUMP TYPE	N.OF STAGES	kW	Hp	Q=DELIVERY						
				l/min 0	100	120	140	160	200	250
				m³/h 0	6	7,2	8,4	9,6	12	15
H=TOTAL HEAD METERS COLUMN OF WATER										
12BH11S	5	1,1	1,5	31	26	25	24	21	18	12
12BH11T										
12BH15S	8	1,5	2	49	42	40	38	34	29	19
12BH15T										
12BH22S	11	2,2	3	67	58	55	52	47	40	26
12BH22T										
12BH30T	15	3	4	92	79	75	71	65	54	36
12BH40T	20	4	5,5	122	105	100	94	87	72	48
12BH55T	27	5,5	7,5	165	142	135	127	117	98	65
12BH75T	36	7,5	10	221	189	180	169	156	130	87

DIMENSIONS AND WEIGHTS AT 50 Hz

PUMP TYPE	N.OF STAGES	DN	L1 mm	L mm	PUMP WEIGHT kg	ELECTRIC PUMP WEIGHT kg
12BH11S	5	Rp2"	437	829	3,2	14,3
12BH11T				829		13,6
12BH15S	8		593	1025	4,7	17,7
12BH15T				1010		16,2
12BH22S	11		749	1294	6,1	23,8
12BH22T				1219		20,2
12BH30T	15		994	1514	8,5	25
12BH40T	20		1254	1848	10,8	32,2
12BH55T	27		1655	2359	14,7	42,4
12BH75T	36		2123	2912	19	51,6

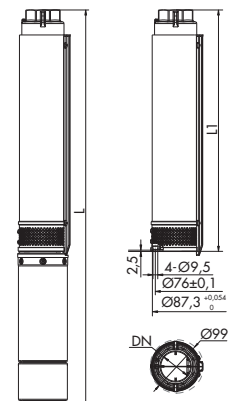

16BH SERIES

OPERATING CHARACTERISTICS AT 50 Hz

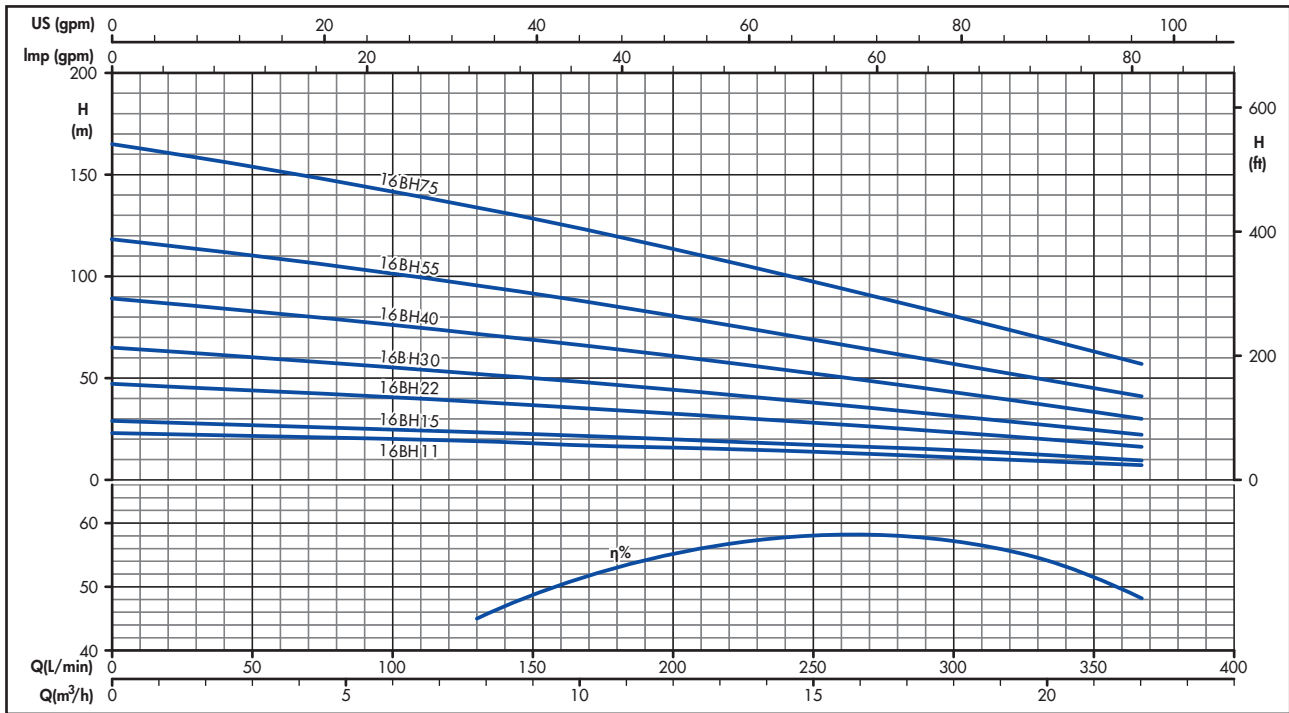

OPERATING CHARACTERISTICS AT 50 Hz

PUMP TYPE	N.OF STAGES	kW	Hp	Q=DELIVERY						
				l/min 0	140	160	200	250	300	367
				m ³ /h 0	8,4	9,6	12	15	18	22
				H=TOTAL HEAD METERS COLUMN OF WATER						
16BH11S	4	1,1	1,5	23	19	18	16,5	14	11	8
16BH11T										
16BH15S	5	1,5	2	29	23	22	20	17	14	10
16BH15T										
16BH22S	8	2,2	3	47	37	36	32	27	23	16
16BH22T										
16BH30T	11	3	4	65	51	49	44	38	31	22
16BH40T	15	4	5,5	89	70	67	60	51	43	30
16BH55T	20	5,5	7,5	118	97	89	80	69	57	41
16BH75T	28	7,5	10	165	131	125	112	96	80	57

DIMENSIONS AND WEIGHTS AT 50 Hz

PUMP TYPE	N.OF STAGES	DN	L1 mm	L mm	PUMP WEIGHT kg	ELECTRIC PUMP WEIGHT kg
16BH11S	4	Rp2"	449	841	3,5	14,6
16BH11T				841		13,9
16BH15S	5		517	949	4,1	17,1
16BH15T				934		15,6
16BH22S	8		721	1266	6	23,7
16BH22T				1191		20,1
16BH30T	11		962	1482	8,4	24,9
16BH40T	15		1234	1828	10,9	32,3
16BH55T	20		1611	2315	13,7	41,4
16BH75T	28		2155	2944	18,8	51,4

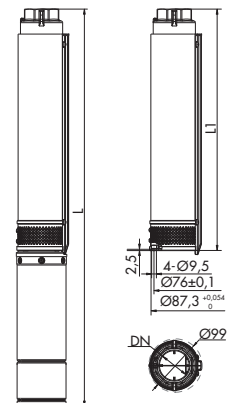

***COST-EFFECTIVE VERSION**

- Cost-effective submersible electric pumps ensure low cost, high efficiency, better performance and reliability.

APPLICATIONS

- Water supply from deep well.
- Agricultural irrigation.
- Pressure boosting.
- Fire-fighting.
- Industrial application.

SPECIFICATIONS

- Delivery: up to 22 m³/h at 2850 rpm.
- Head: up to 225 m at 2850 rpm.
- Maximum pump overall diameter (cable cover included): 99 mm.
- Maximum permissible quantity of sand: 150 g/m³.
- 1BM , 2BM , 3BM, 4BM , 6BM versions: delivery port Rp1"1/4.
- 8BM , 12BM , 16BM versions: delivery port Rp2".

MOTOR

- 4OS single-phase version:
from 0,25 to 2,2 kW, 220 V, 50 Hz.
- 4OS three-phase version:
from 0,37 to 2,2 kW, 220 V, 50 Hz.
from 0,37 to 3,0 kW, 380 V, 50 Hz.
- Horizontal operation: 4OS up to 2,2 kW.
- Maximum temperature of water in contact with motor: 35°C .

CONSTRUCTION & CHARACTERISTICS

- Cost-effective construction ensures low cost, high efficiency, better performance and reliability.
- Abrasion resistant construction, floating impellers ensure optimum resistance to abrasion.
- The delivery port and suction support are made of precision-cast stainless steel, guarantee resistance to corrosion, durability and a sturdy coupling to the motor.
- The hexagonal pump shaft guarantees an effective impeller driving.
- A non-return valve is fitted at the discharge to prevent back flow of water and alleviate water hammer to the pump, safeguarding impellers and diffusers.
- The BM series pumps can be coupled with the 4OS motors.
- Vertical and horizontal installation.
- Standard and special versions available.

OPTIONAL FEATURES

- Different voltage and frequency.
- Different materials.



BM SERIES

HYDRAULIC PERFORMANCE RANGE AT 50 Hz

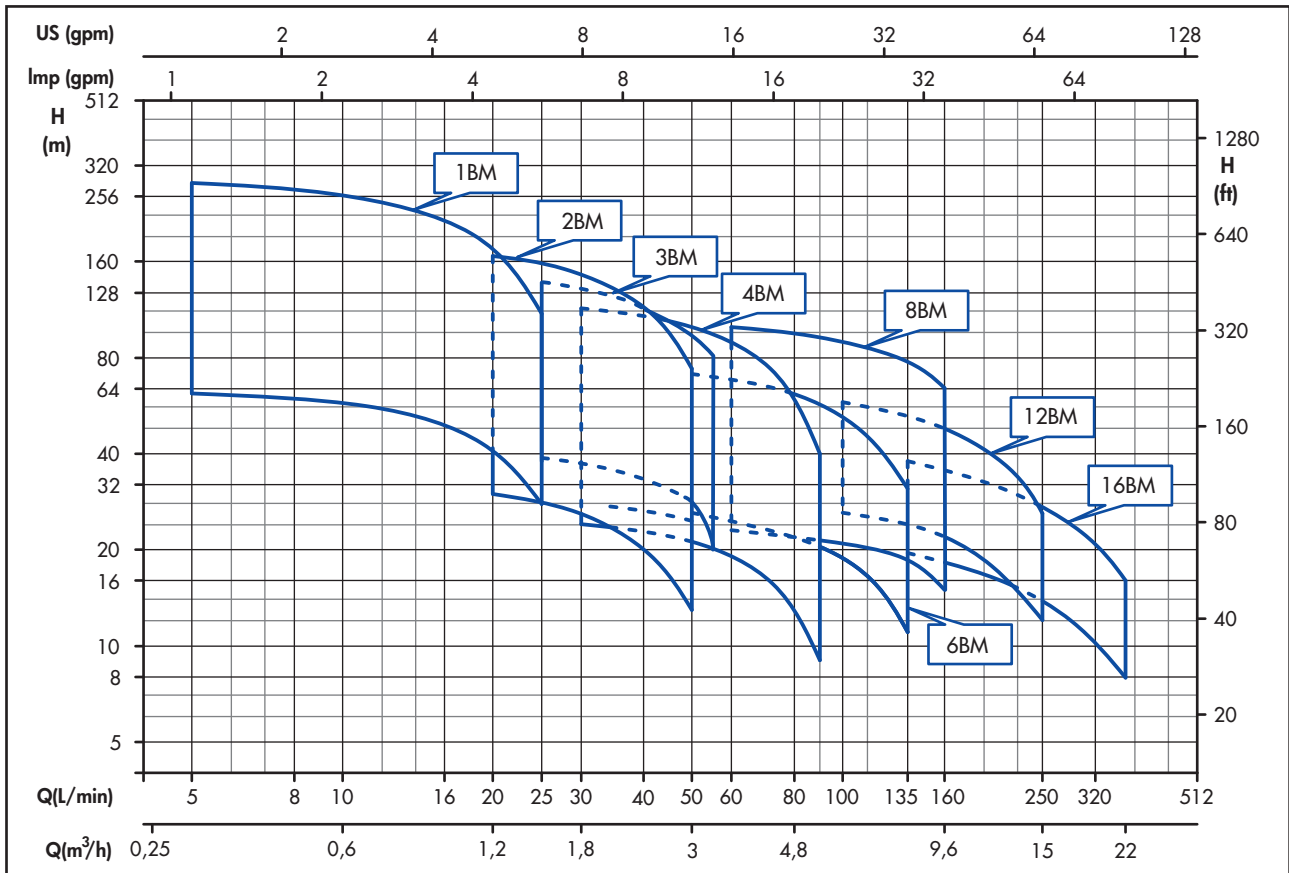

IDENTIFICATION CODE

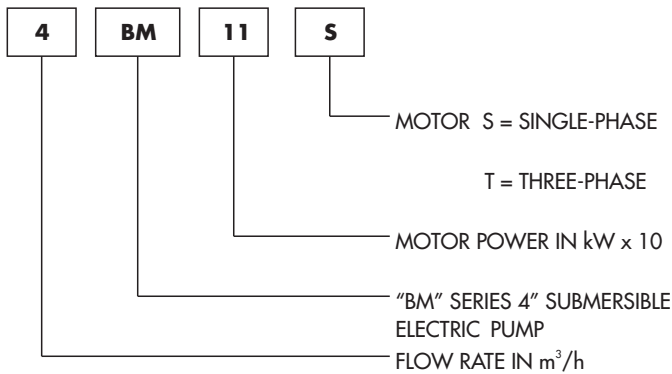

EXAMPLE OF PUMP TYPE

4BM11S

BM series 4" submersible electric pump with flow rate of 4 m³/h; and single-phase 1,1 kW (1,5 Hp) motor.



1BM-4BM SERIES

PUMP SECTION AND LIST OF MAIN COMPONENTS MATERIAL

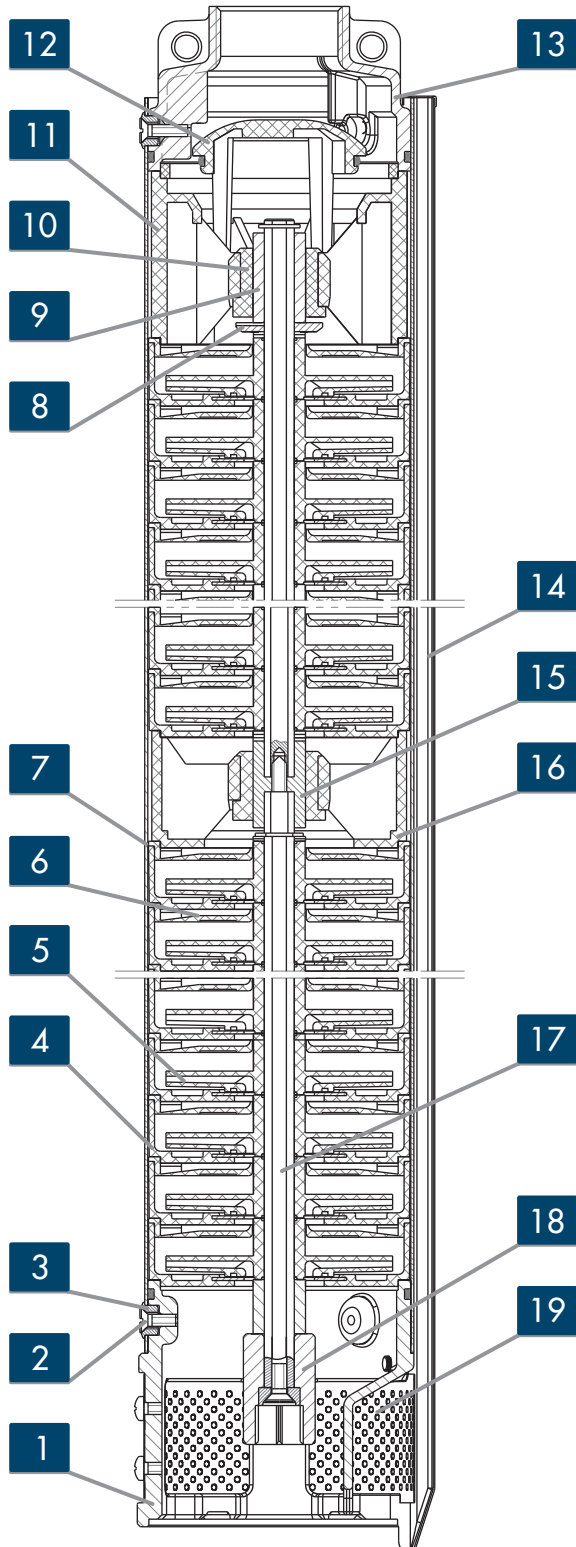

REF.N.	PART	MATERIAL	STANDARD
1	Lower support	Precision-cast stainless steel / cast iron	AISI 304 / ASTM 200A
2	Screw	Stainless steel	AISI 304
3	Pin	Stainless steel	AISI 304
4	Stage housing	ABS	-----
5	Impeller	ABS	-----
6	Diffuser	ABS	-----
7	Outer sleeve	Stainless steel	AISI 304
8	Thrust bearing	Stainless steel	AISI 304
9	Shaft sleeve	Stainless steel	AISI 304
10	Bush bearing	TPU	-----
11	Upper support	ABS	-----
12	Non-return valve	ABS	-----
13	Delivery port	Precision-cast stainless steel / cast iron	AISI 304 / ASTM 200A
14	Cable guard	Stainless steel	AISI 304
15	Intermediate shaft sleeve	Stainless steel	AISI 304
16	Intermediate support	ABS	-----
17	Shaft	Stainless steel	AISI 420
18	Coupling	Stainless steel	AISI 304
19	Filter	Stainless steel	AISI 304

6BM-8BM SERIES

PUMP SECTION AND LIST OF MAIN COMPONENTS MATERIAL

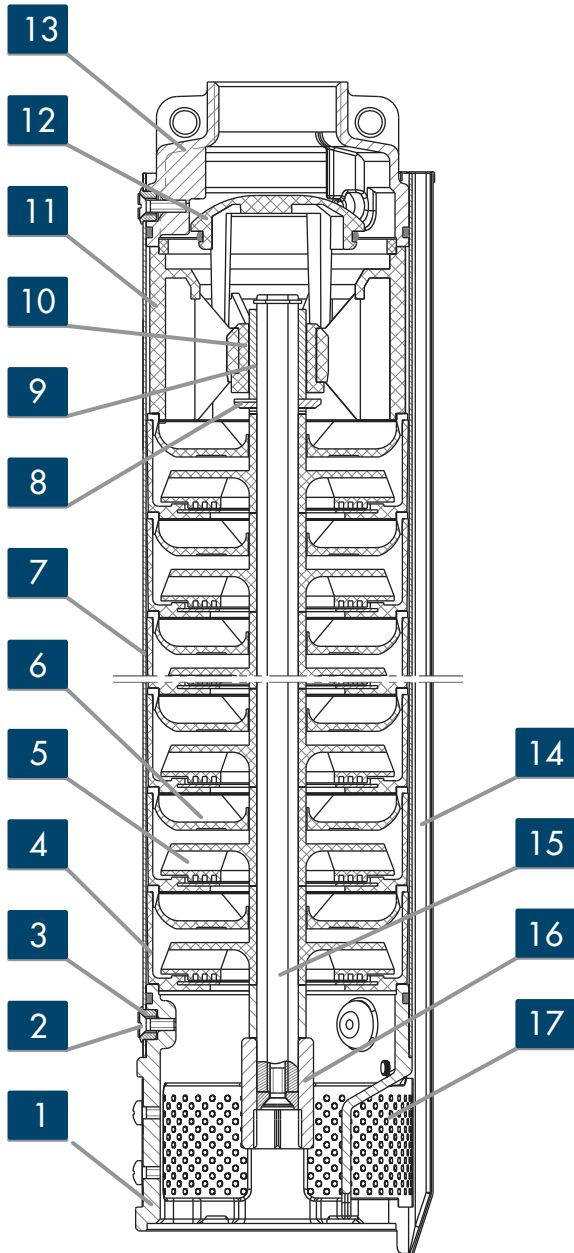

REF.N.	PART	MATERIAL	STANDARD
1	Lower support	Precision-cast stainless steel / cast iron	AISI 304 / ASTM 200A
2	Screw	Stainless steel	AISI 304
3	Pin	Stainless steel	AISI 304
4	Stage housing	ABS	-----
5	Impeller	ABS	-----
6	Diffuser	ABS	-----
7	Outer sleeve	Stainless steel	AISI 304
8	Thrust bearing	Stainless steel	AISI 304
9	Shaft sleeve	Stainless steel	AISI 304
10	Bush bearing	TPU	-----
11	Upper support	ABS	-----
12	Non-return valve	ABS	-----
13	Delivery port	Precision-cast stainless steel / cast iron	AISI 304 / ASTM 200A
14	Cable guard	Stainless steel	AISI 304
15	Shaft	Stainless steel	AISI 420
16	Coupling	Stainless steel	AISI 304
17	Filter	Stainless steel	AISI 304

12BM SERIES

PUMP SECTION AND LIST OF MAIN COMPONENTS MATERIAL

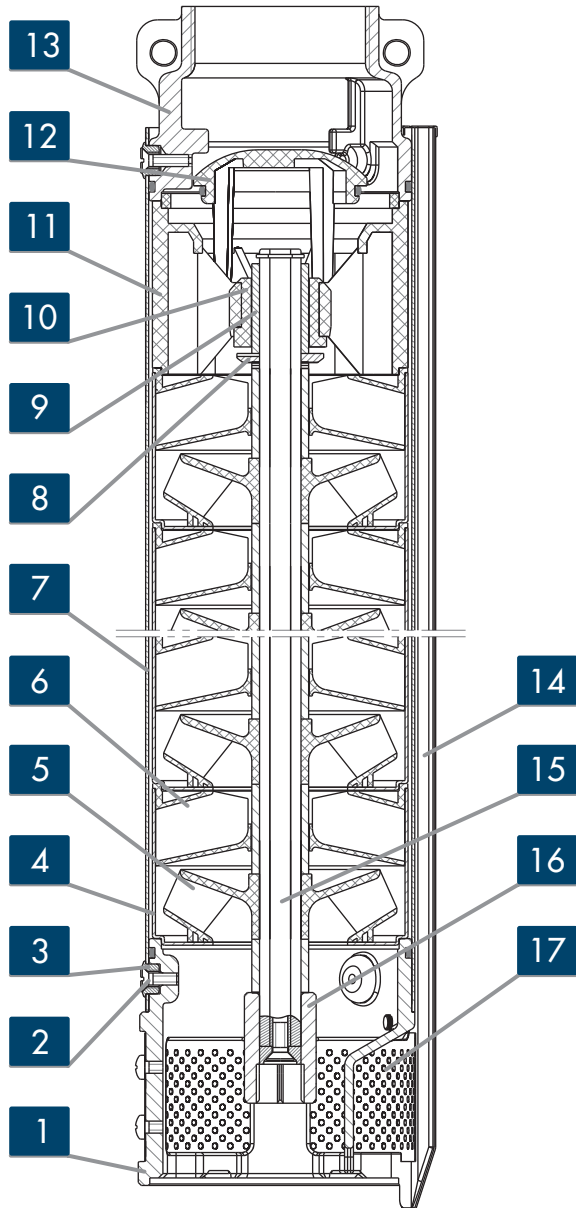

REF.N.	PART	MATERIAL	STANDARD
1	Lower support	Precision-cast stainless steel / cast iron	AISI 304
2	Screw	Stainless steel	AISI 304
3	Pin	Stainless steel	AISI 304
4	Stage housing	Stainless steel	AISI 304
5	Impeller	Noryl® PPO	-----
6	Diffuser	Noryl® PPO	-----
7	Outer sleeve	Stainless steel	AISI 304
8	Thrust bearing	Stainless steel	AISI 304
9	Shaft sleeve	Stainless steel	AISI 304
10	Bush bearing	TPU	-----
11	Upper support	ABS	-----
12	Non-return valve	ABS	-----
13	Delivery port	Precision-cast stainless steel / cast iron	AISI 304
14	Cable guard	Stainless steel	AISI 304
15	Shaft	Stainless steel	AISI 420
16	Coupling	Stainless steel	AISI 304
17	Filter	Stainless steel	AISI 304

16BM SERIES

PUMP SECTION AND LIST OF MAIN COMPONENTS MATERIAL

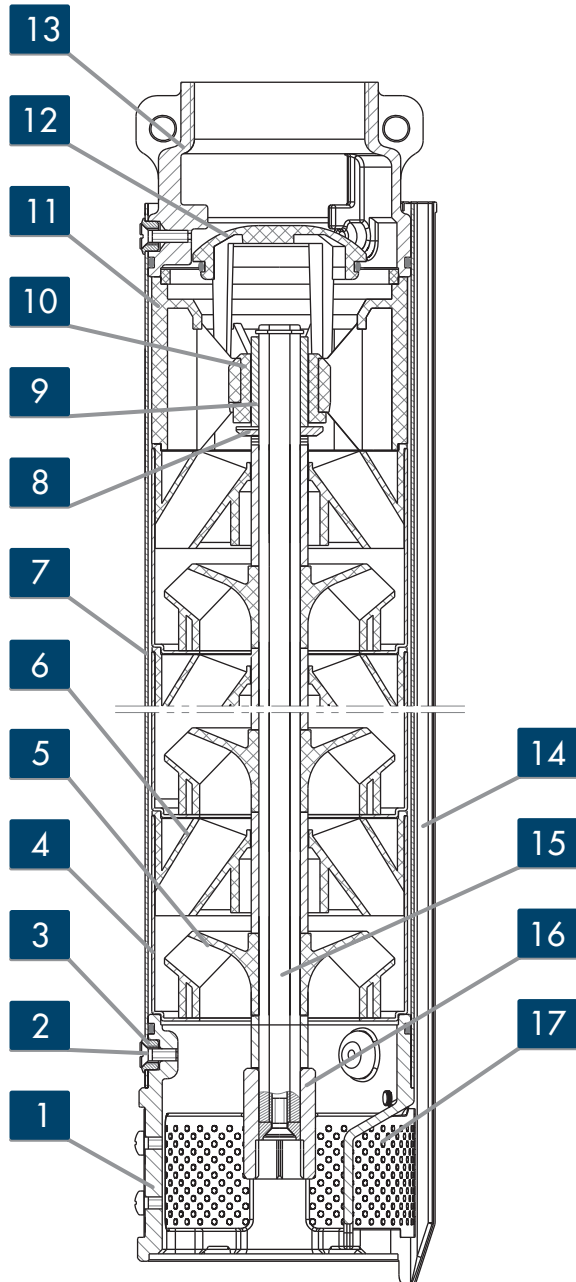

REF.N.	PART	MATERIAL	STANDARD
1	Lower support	Precision-cast stainless steel / cast iron	AISI 304 / ASTM 200A
2	Screw	Stainless steel	AISI 304
3	Pin	Stainless steel	AISI 304
4	Stage housing	Stainless steel	AISI 304
5	Impeller	Noryl® PPO	-----
6	Diffuser	Noryl® PPO	-----
7	Outer sleeve	Stainless steel	AISI 304
8	Thrust bearing	Stainless steel	AISI 304
9	Shaft sleeve	Stainless steel	AISI 304
10	Bush bearing	TPU	-----
11	Upper support	ABS	-----
12	Non-return valve	ABS	-----
13	Delivery port	Precision-cast stainless steel / cast iron	AISI 304 / ASTM 200A
14	Cable guard	Stainless steel	AISI 304
15	Shaft	Stainless steel	AISI 420
16	Coupling	Stainless steel	AISI 304
17	Filter	Stainless steel	AISI 304

1BM SERIES

OPERATING CHARACTERISTICS AT 50 Hz

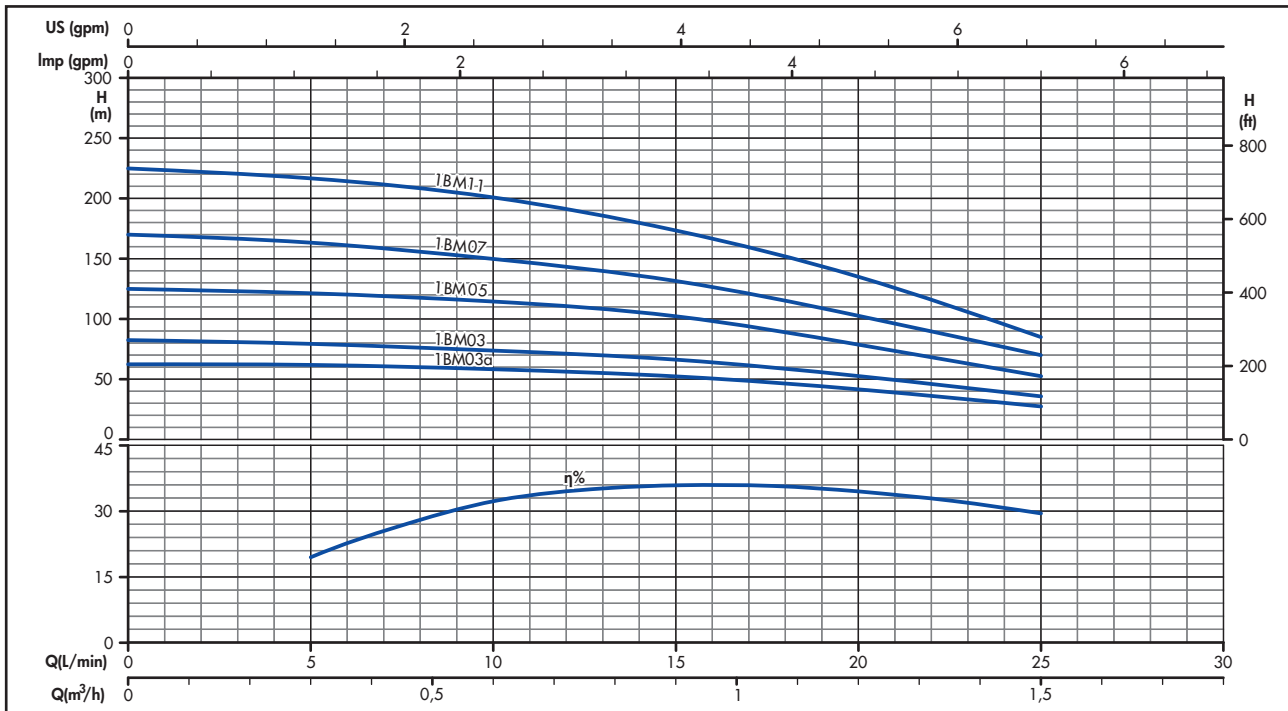

OPERATING CHARACTERISTICS AT 50 Hz

PUMP TYPE	N.OF STAGES	kW	Hp	Q=DELIVERY					
				l/min 0	5	10	15	20	25
				m³/h 0	0,3	0,6	0,9	1,2	1,5
H=TOTAL HEAD METERS COLUMN OF WATER									
1BM03Sa	10	0,37	0,5	64	62	57	52	40	28
1BM03S	13	0,37	0,5	82	80	73	68	52	36
1BM03T									
1BM05S	19	0,55	0,75	125	120	110	102	76	54
1BM05T									
1BM07S	26	0,75	1	169	163	149	131	100	70
1BM07T									
1BM11S	37	1,1	1,5	225	218	200	172	135	85
1BM11T									

DIMENSIONS AND WEIGHTS AT 50 Hz

PUMP TYPE	N.OF STAGES	DN	L1 mm	L mm	PUMP WEIGHT kg	ELECTRIC PUMP WEIGHT kg
1BM03Sa	10	Rp1"1/4	369	695	3,1	11,3
1BM03S	13		423	749	3,5	11,7
1BM03T			423	749		11,3
1BM05S	19		528	869	4,5	13,4
1BM05T			528	864		12,5
1BM07S	26		652	1013	5,4	15,2
1BM07T			652	1008		14,3
1BM11S	37		882	1274	7,1	18,2
1BM11T			882	1274		17,5

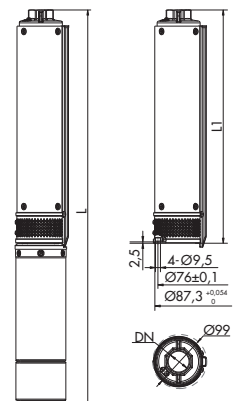

2BM SERIES

OPERATING CHARACTERISTICS AT 50 Hz

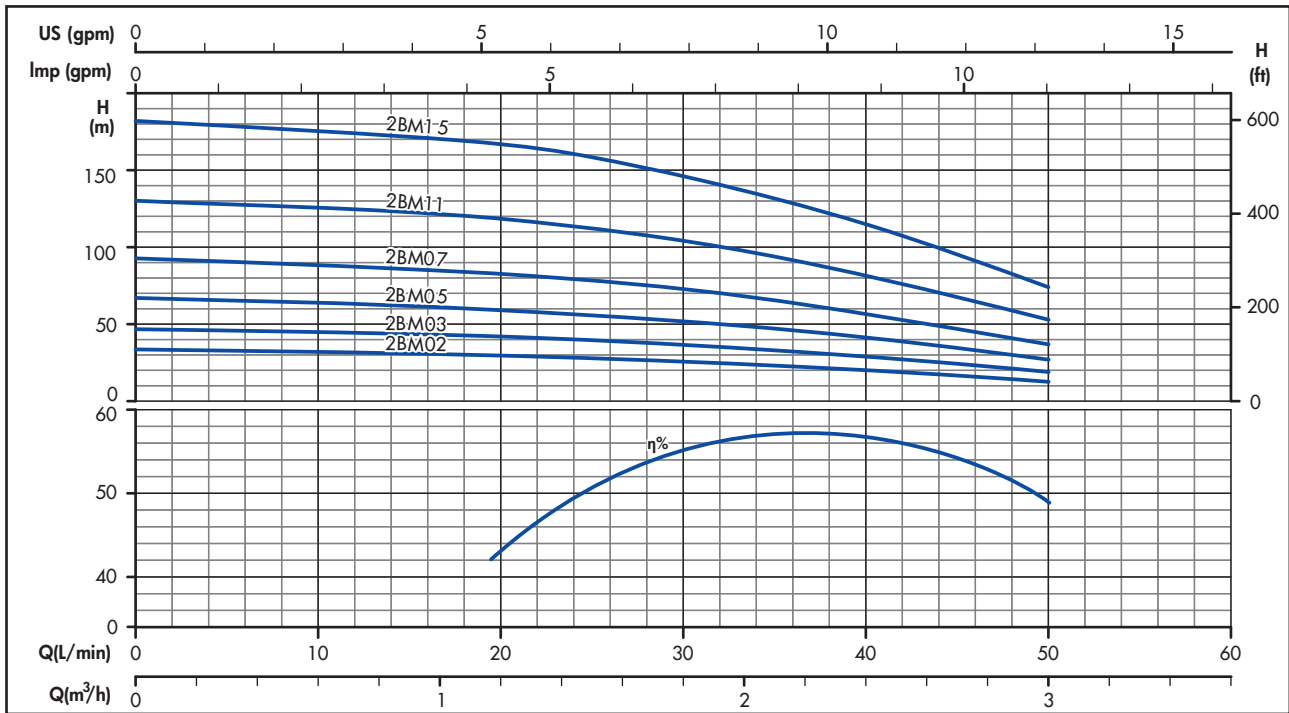

OPERATING CHARACTERISTICS AT 50 Hz

PUMP TYPE	N.OF STAGES	kW	Hp	Q=DELIVERY					
				l/min 0	20	25	30	40	50
				m³/h 0	1,2	1,5	1,8	2,4	3
H=TOTAL HEAD METERS COLUMN OF WATER									
2BM02S	5	0,25	0,33	33	30	28	26	20	13
2BM03S	7	0,37	0,5	47	42	40	36	29	19
2BM03T									
2BM05S	10	0,55	0,75	67	60	56	52	41	27
2BM05T									
2BM07S	14	0,75	1	93	83	79	73	57	37
2BM07T									
2BM11S	20	1,1	1,5	130	119	113	104	82	53
2BM11T									
2BM15S	28	1,5	2	182	167	158	146	115	74
2BM15T									

DIMENSIONS AND WEIGHTS AT 50 Hz

PUMP TYPE	N.OF STAGES	DN	L1 mm	L mm	PUMP WEIGHT kg	ELECTRIC PUMP WEIGHT kg
2BM02S	5	Rp1"1/4	299	615	2,6	10,4
2BM03S	7		341	667	2,8	11
2BM03T						
2BM05S	10		405	746	3,3	12,2
2BM05T						
2BM07S	14		489	850	3,8	13,6
2BM07T						
2BM11S	20		616	1008	4,7	15,8
2BM11T						
2BM15S	28		785	1217	5,7	18,7
2BM15T						

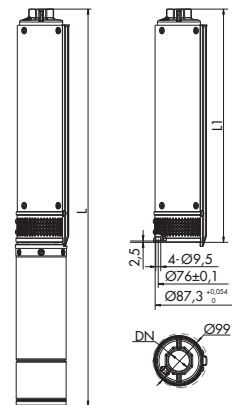

3BM SERIES

OPERATING CHARACTERISTICS AT 50 Hz

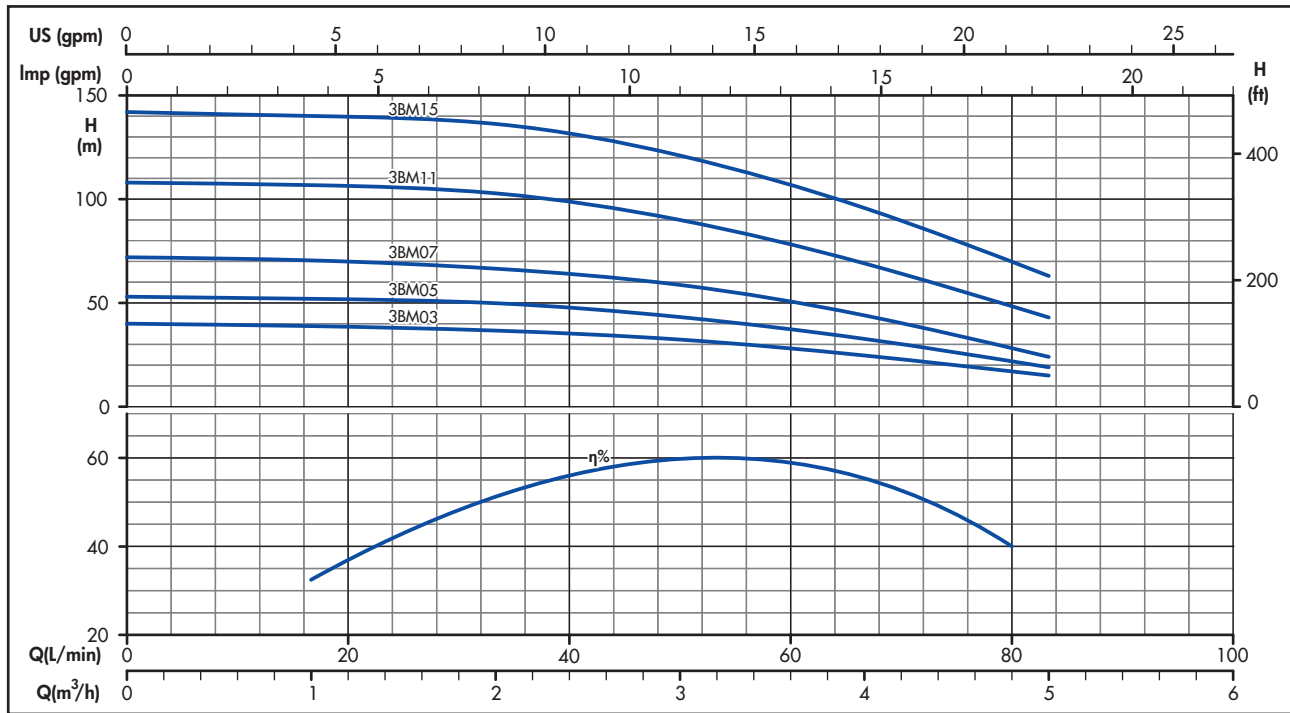

OPERATING CHARACTERISTICS AT 50 Hz

PUMP TYPE	N.OF STAGES	kW	Hp	Q=DELIVERY					
				l/min 0	17	33	50	67	84
				m³/h 0	1	2	3	4	5
H=TOTAL HEAD METERS COLUMN OF WATER									
3BM03S	6	0,37	0,5	40	39	37	33	25	15
3BM03T									
3BM05S	8	0,55	0,75	53	52	50	43	33	19
3BM05T									
3BM07S	11	0,75	1	72	71	67	59	44	24
3BM07T									
3BM11S	16	1,1	1,5	108	107	103	90	69	43
3BM11T									
3BM15S	21	1,5	2	142	141	136	121	96	63
3BM15T									

DIMENSIONS AND WEIGHTS AT 50 Hz

PUMP TYPE	N.OF STAGES	DN	L1 mm	L mm	PUMP WEIGHT kg	ELECTRIC PUMP WEIGHT kg
3BM03S	6	Rp1"1/4	347	673	4,2	12,4
3BM03T				673		12
3BM05S	8		398	739	4,6	13,5
3BM05T				734		12,6
3BM07S	11		474	835	5	14,8
3BM07T				830		13,9
3BM11S	16		602	994	5,7	16,8
3BM11T				994		16,1
3BM15S	21		729	1161	6,5	19,5
3BM15T				1146		18

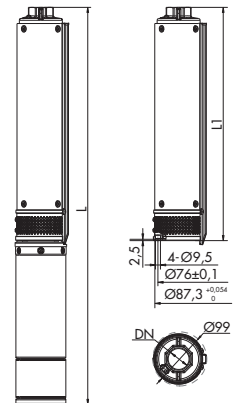

4BM SERIES

OPERATING CHARACTERISTICS AT 50 Hz

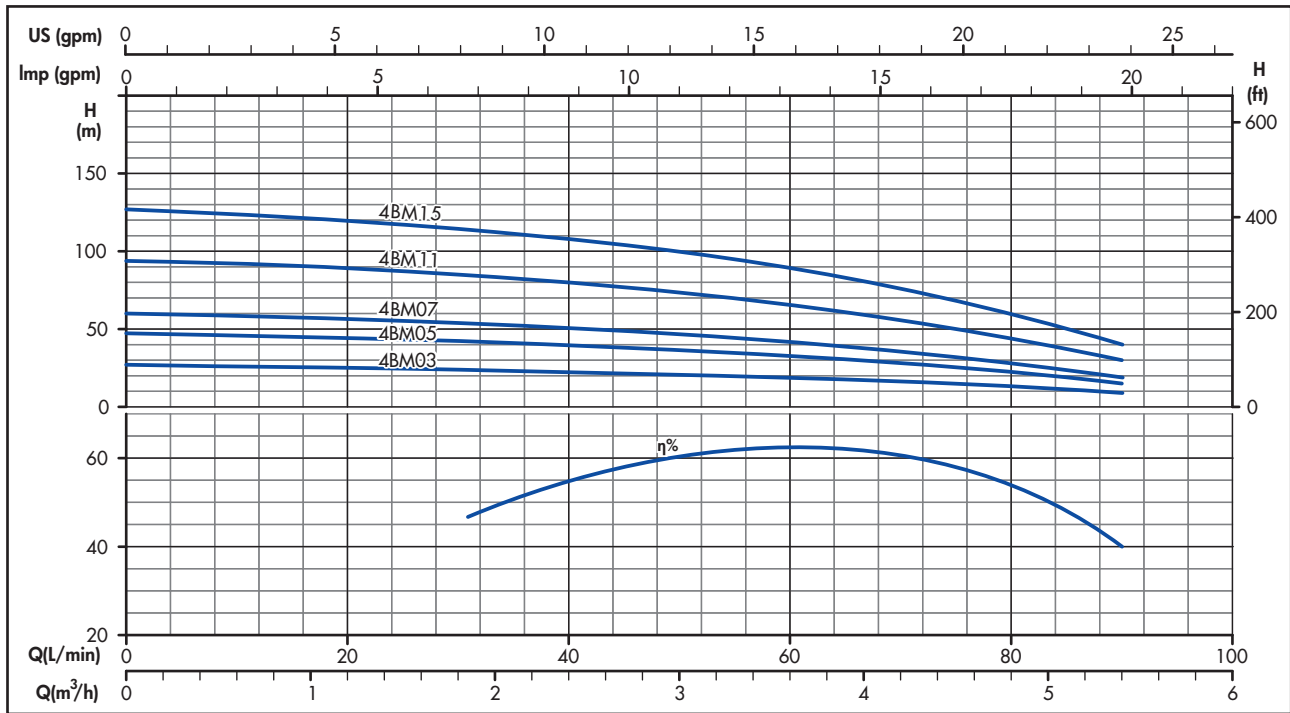

OPERATING CHARACTERISTICS AT 50 Hz

PUMP TYPE	N.OF STAGES	kW	Hp	Q=DELIVERY						
				l/min 0	30	40	50	60	80	90
				m³/h 0	1,8	2,4	3	3,6	4,8	5,4
H=TOTAL HEAD METERS COLUMN OF WATER										
4BM03S	4	0,37	0,5	27	24	23	21	19	13	9
4BM03T										
4BM05S	7	0,55	0,75	47	42	40	37	33	22	15
4BM05T										
4BM07S	9	0,75	1	60	54	51	47	42	28	19
4BM07T										
4BM11S	14	1,1	1,5	94	84	80	74	66	44	30
4BM11T										
4BM15S	19	1,5	2	127	114	108	100	89	60	40
4BM15T										

DIMENSIONS AND WEIGHTS AT 50 Hz

PUMP TYPE	N.OF STAGES	DN	L1 mm	L mm	PUMP WEIGHT kg	ELECTRIC PUMP WEIGHT kg
4BM03S	4	Rp1"1/4	296	622	2,5	10,7
4BM03T				622		10,3
4BM05S	7		371	712	3	11,9
4BM05T				707		11
4BM07S	9		423	784	3,4	13,2
4BM07T				779		12,3
4BM11S	14		550	942	4,3	15,4
4BM11T				942		14,7
4BM15S	19		677	1109	5,6	18,6
4BM15T				1094		17,1

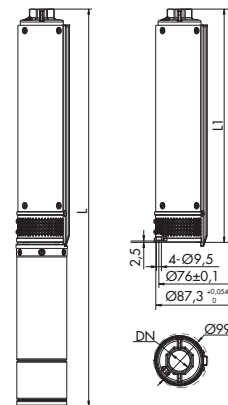

6BM SERIES

OPERATING CHARACTERISTICS AT 50 Hz

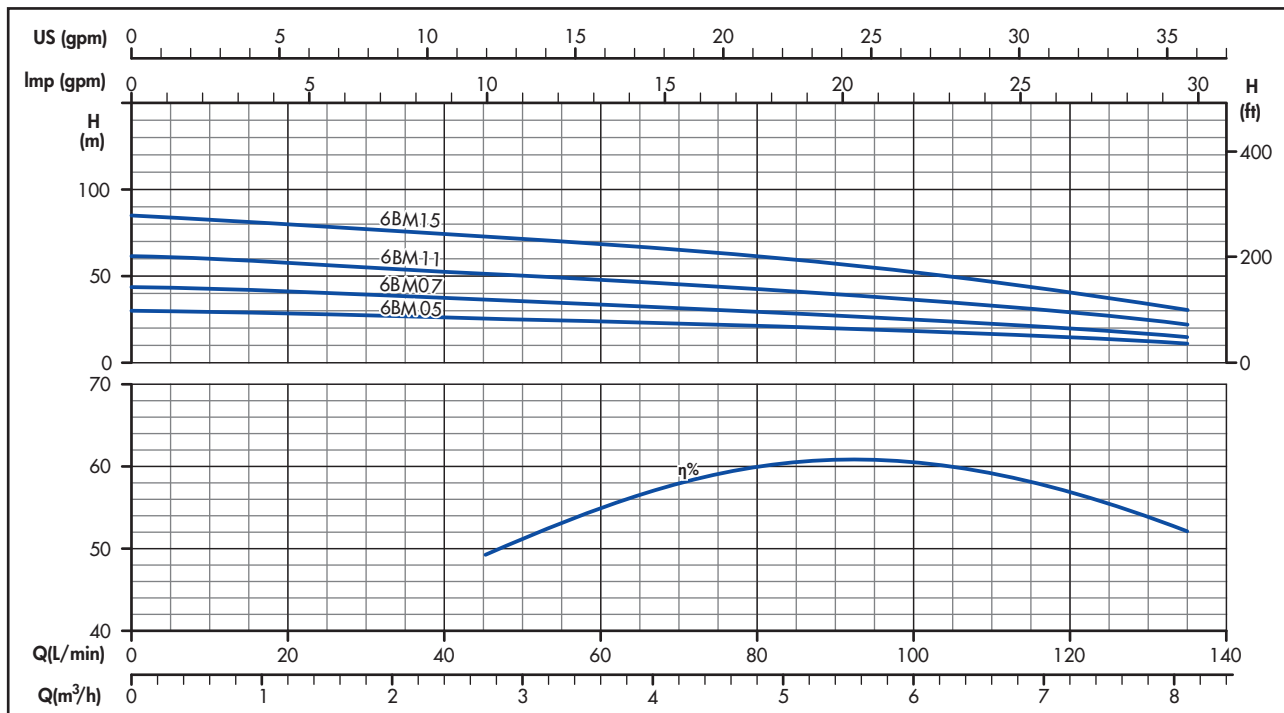

OPERATING CHARACTERISTICS AT 50 Hz

PUMP TYPE	N.OF STAGES	kW	Hp	Q=DELIVERY						
				l/min 0	60	75	90	105	120	135
				m³/h 0	3,6	4,5	5,4	6,3	7,2	8,1
H=TOTAL HEAD METERS COLUMN OF WATER										
6BM05S	5	0,55	0,75	30	25	23	20	18	15	11
6BM05T										
6BM07S	7	0,75	1	43	35	32	28	24	20	15
6BM07T										
6BM11S	10	1,1	1,5	61	49	46	41	35	30	22
6BM11T										
6BM15S	14	1,5	2	85	69	64	57	50	41	31
6BM15T										

DIMENSIONS AND WEIGHTS AT 50 Hz

PUMP TYPE	N.OF STAGES	DN	L1 mm	L mm	PUMP WEIGHT kg	ELECTRIC PUMP WEIGHT kg
6BM05S	5	Rp1"1/4	357	698	3	11,9
6BM05T				693		11
6BM07S	7		423	784	3,4	13,2
6BM07T				779		12,3
6BM11S	10		522	914	4,1	15,2
6BM11T				914		14,5
6BM15S	14		655	1087	4,9	17,9
6BM15T				1072		16,4

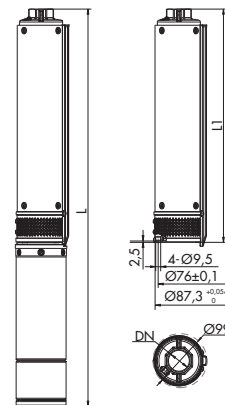

8BM SERIES

OPERATING CHARACTERISTICS AT 50 Hz

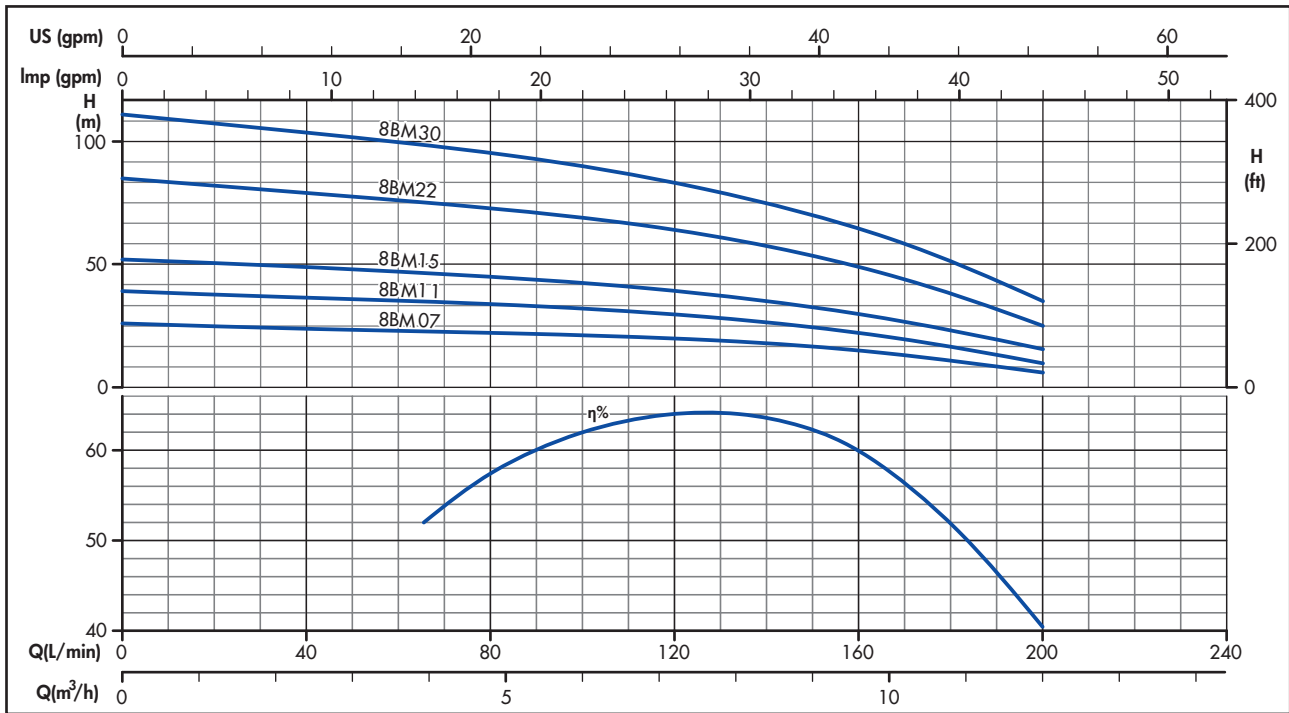

OPERATING CHARACTERISTICS AT 50 Hz

PUMP TYPE	N.OF STAGES	kW	Hp	Q=DELIVERY					
				l/min 0	40	80	120	160	200
				m ³ /h 0	2,4	4,8	7,2	9,6	12
H=TOTAL HEAD METERS COLUMN OF WATER									
8BM07S	4	0,75	1	26	24	22	20	15	6
8BM07T									
8BM11S	6	1,1	1,5	39	36	34	29	22	10
8BM11T									
8BM15S	8	1,5	2	52	49	45	39	30	15
8BM15T									
8BM22S	13	2,2	3	85	79	73	64	49	25
8BM22T									
8BM30T	17	3	4	111	103	95	83	64	35

DIMENSIONS AND WEIGHTS AT 50 Hz

PUMP TYPE	N.OF STAGES	DN	L1 mm	L mm	PUMP WEIGHT kg	ELECTRIC PUMP WEIGHT kg
8BM07S	4	Rp2"	334	695	2,7	12,5
8BM07T				690		11,6
8BM11S	6		400	792	3,2	14,3
8BM11T				792		13,6
8BM15S	8		466	898	3,6	16,6
8BM15T				883		15,1
8BM22S	13		631	1176	4,7	22,4
8BM22T				1101		18,8
8BM30T	17		764	1284	5,6	22

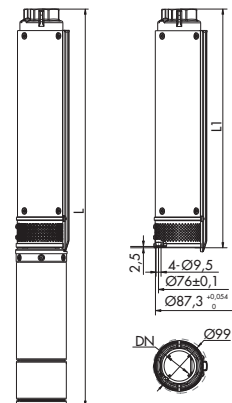

12BM SERIES

OPERATING CHARACTERISTICS AT 50 Hz

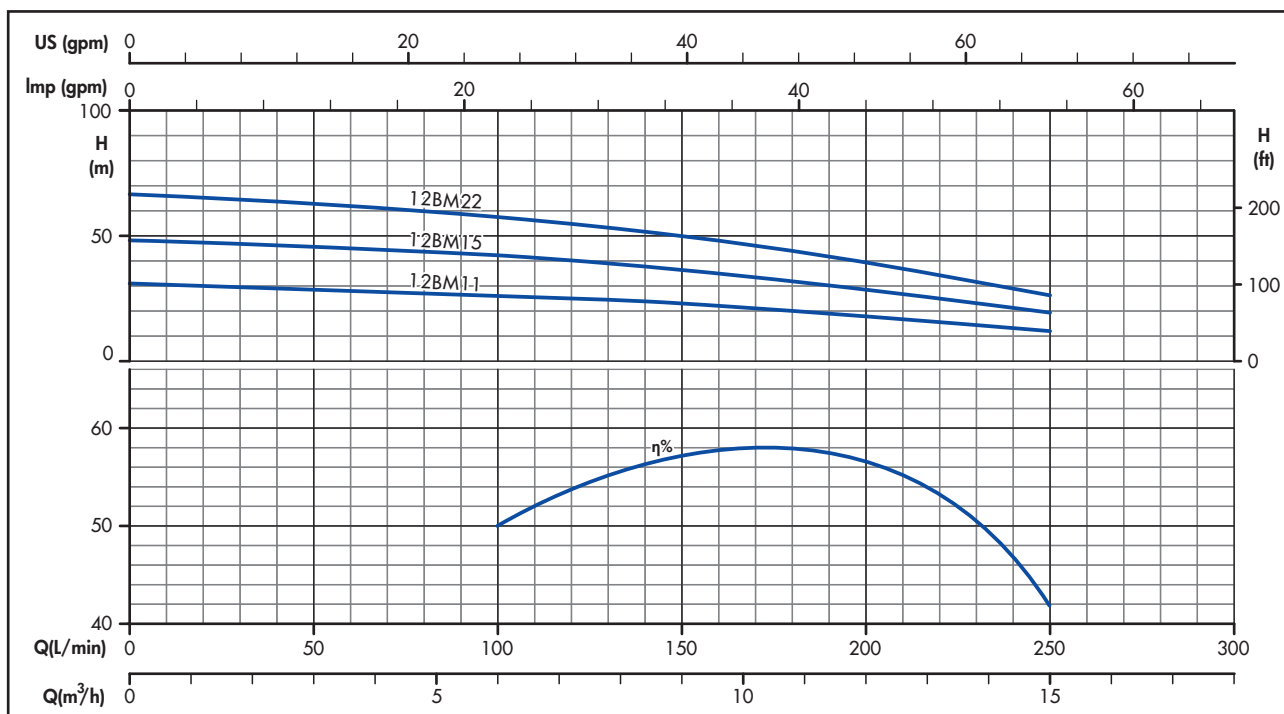

OPERATING CHARACTERISTICS AT 50 Hz

PUMP TYPE	N.OF STAGES	kW	Hp	Q=DELIVERY						
				l/min 0	100	120	140	160	200	250
				m³/h 0	6	7,2	8,4	9,6	12	15
H=TOTAL HEAD METERS COLUMN OF WATER										
12BM11S	5	1,1	1,5	31	26	25	24	21	18	12
12BM11T										
12BM15S	8	1,5	2	49	42	40	38	34	29	19
12BM15T										
12BM22S	11	2,2	3	67	58	55	52	47	40	26
12BM22T										

DIMENSIONS AND WEIGHTS AT 50 Hz

PUMP TYPE	N.OF STAGES	DN	L1 mm	L mm	PUMP WEIGHT kg	ELECTRIC PUMP WEIGHT kg
12BM11S	5	Rp2"	464	856	3,9	15
12BM11T				856		14,3
12BM15S	8		620	1052	5,2	18,2
12BM15T				1037		16,7
12BM22S	11		776	1321	6,4	24,1
12BM22T				1246		20,5

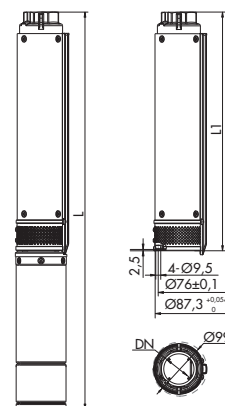

16BM SERIES

OPERATING CHARACTERISTICS AT 50 Hz

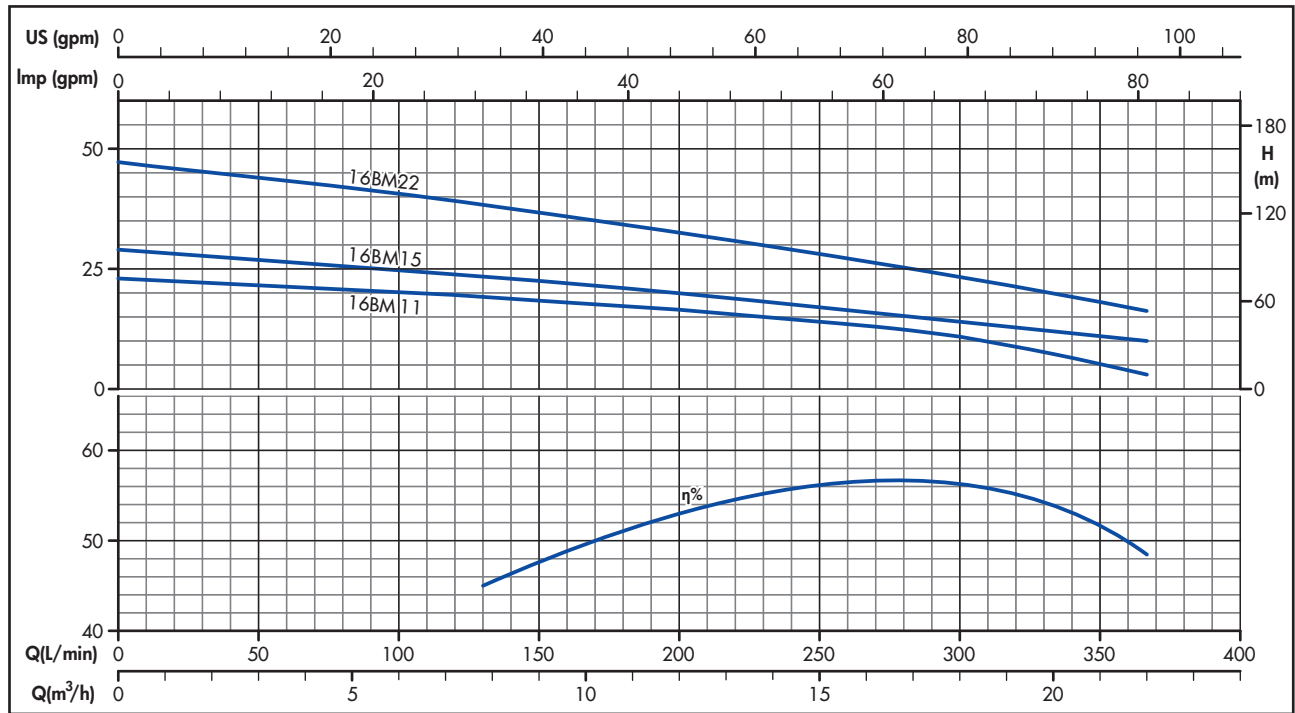

OPERATING CHARACTERISTICS AT 50 Hz

PUMP TYPE	N.OF STAGES	kW	Hp	Q=DELIVERY						
				l/min 0	140	160	200	250	300	367
				m³/h 0	8,4	9,6	12	15	18	22
H=TOTAL HEAD METERS COLUMN OF WATER										
16BM11S	4	1,1	1,5	23	19	18	16,5	14	11	8
16BM11T										
16BM15S	5	1,5	2	29	23	22	20	17	14	10
16BM15T										
16BM22S	8	2,2	3	47	37	36	32	27	23	16
16BM22T										

DIMENSIONS AND WEIGHTS AT 50 Hz

PUMP TYPE	N.OF STAGES	DN	L1 mm	L mm	PUMP WEIGHT kg	ELECTRIC PUMP WEIGHT kg
16BM11S	4	Rp2"	475	867	3,9	15
16BM11T				867		14,3
16BM15S	5		543	975	4,4	17,4
16BM15T				960		15,9
16BM22S	8		747	1292	6	23,7
16BM22T				1217		20,1

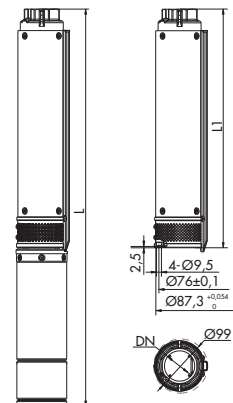

- The state-of-art design and choice of component materials ensure optimum operating performances, superior quality, reliability and ease of installation.

SPECIFICATIONS

- Shaft extension and couplings meet NEMA standards.
- Rewindable stator.
- Winding insulation: Class F .
- Protection grade: IP68.
- Filling fluid in compliance with standards concerning oils contact with foodstuffs and with the purity requirements specified by the annex to G.U. no. 104 of 20/04/1973; it also complies with F.D.A. (FOOD AND DRUG ADMINISTRATION) standards.
- Large compensation bellows for the expansion of the internal liquid.
- Oversized thrust bearings: Shaft supported by oversized angular bearings which can support thrust load up to 10000N.
- Mechanical seal with sand protection.
- Maximum immersion depth: 150 m .
- Maximum water temperature: 35°C.
- Max temperature applies to motors working in a installation capable of delivering a flow of water around the motor jacket of at least 0,16 m/s.
- Maximum number of starts per hour at regular intervals: 30 for direct start.
- Maximum allowable voltage fluctuations over the rated voltage: 380 V \pm 10 %.

MODELS

- Three-phase:
from 3 to 15 kW, 380 V, 50 Hz.

OPTIONAL FEATURES

- Different voltage and frequency.
- Different materials.

IDENTIFICATION CODE

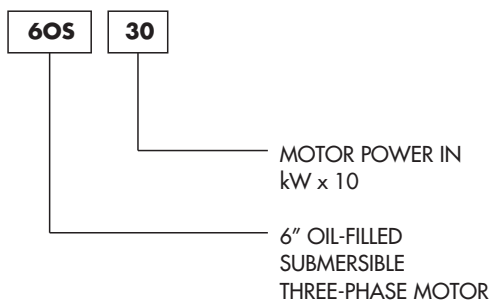

EXAMPLE OF MOTOR TYPE

6OS30

6" oil-filled submersible motor, three-phase, 3 kW (4 Hp).



60S SERIES MOTOR CROSS SECTION AND TABLE OF MATERIAL

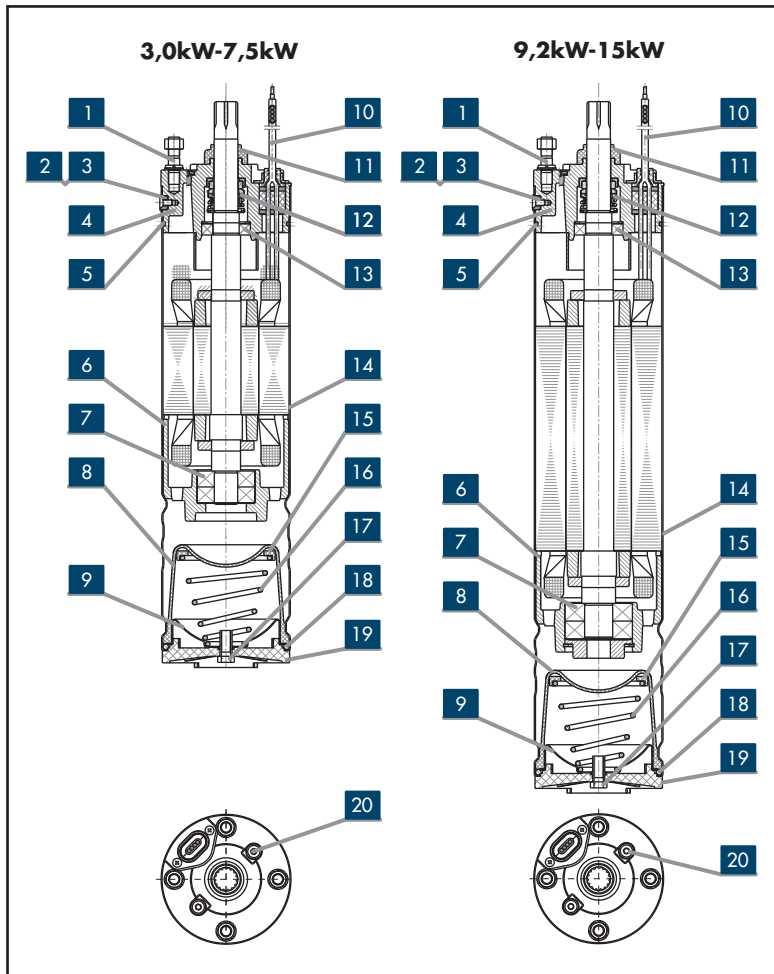

DIMENSIONS AND WEIGHTS AT 50 Hz

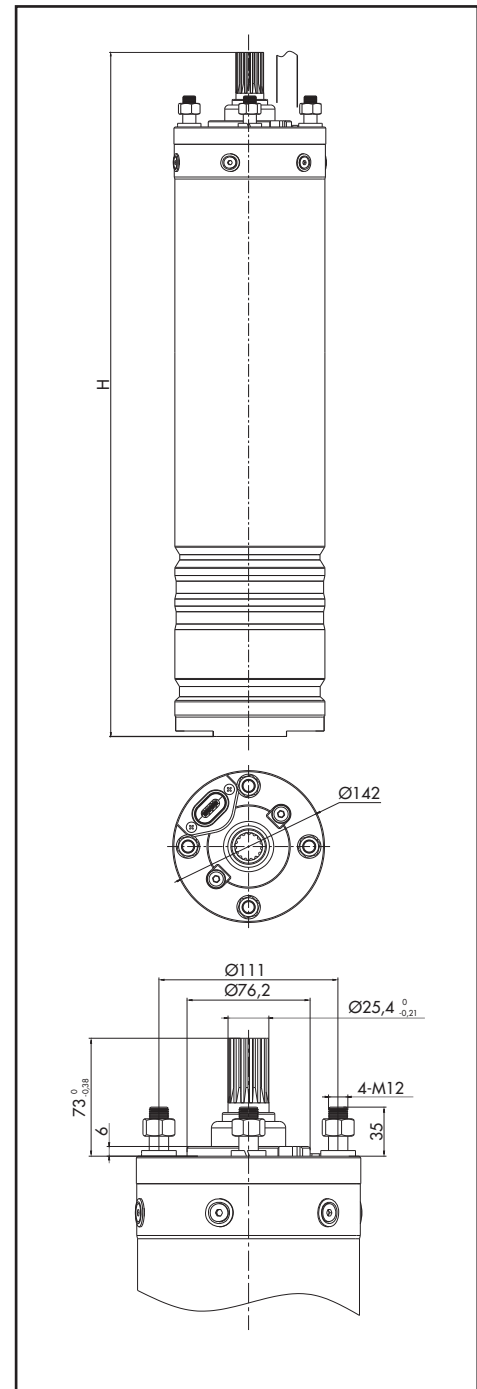

REF.N.	PART	MATERIAL	STANDARD
1	Double ends studs	Stainless steel	AISI 304
2	Pin	Stainless steel	AISI 304
3	Screw	Stainless steel	AISI 304
4	Upper support	Cast iron	ASTM 200A
5	O-ring	NBR	-----
6	Lower support	Cast iron	ASTM 200A
7	Angular bearing	-----	-----
8	Compensation bellow	NBR	-----
9	Lower protection	Stainless steel	AISI 304
10	Cable	-----	-----
11	Sand protection	NBR	-----
12	Mechanical seal	Carbon/Ceramic	-----
13	Ball bearing	-----	-----
14	Motor shell	Stainless steel	AISI 304
15	Spring base	PA66	-----
16	Spring	Stainless steel	-----
17	Bolt	Stainless steel	AISI 304
18	Snap ring	Stainless steel	AISI 304
19	Protection support	ABS	-----
20	Filling screw	Stainless steel	AISI 304

MOTOR TYPE	POWER		H mm	WEIGHT kg
	kW	Hp		
60S30	3	4	605,5	27
60S40	4	5,5	625,5	29
60S55	5,5	7,5	655,5	32
60S75	7,5	10	695,5	36
60S92	9,2	12,5	738,5	41
60S110	11	15	768,5	44
60S130	13	17,5	798,5	46,5
60S150	15	20	848,5	51,5

- The robust design and choice of component materials ensure optimum operating performances, superior quality, reliability and ease of installation.

SPECIFICATIONS

- Shaft extension and couplings meet NEMA standards.
- Rewindable stator.
- Winding insulation: class Y.
- Protection grade: IP68.
- Standard compensation bellows for internal liquid expansion for regular operation.
- Oversized thrust bearings: Shaft supported by oversized thrust bearings which can support thrust load up to 15500 N.
- Filling fluid: water mixed with non-toxic anti-freeze glycol, provides cooling and lubrication, also protects and prevents parts inside from corrosion.
- Maximum immersion depth: 200 m .
- Maximum number of starts per hour at regular intervals: 10.
- Maximum allowable voltage fluctuations over the rated voltage: $\pm 7\%$.

VERSION

- Three-phase from 3 to 45 kW, 380 V/50 Hz.

OPTIONAL FEATURES

- Different voltage and frequency.
- Different material.
- Motors with double cable outlets for star/delta start.



IDENTIFICATION CODE

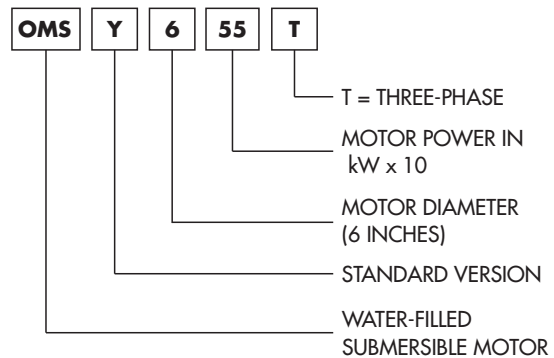

EXAMPLE OF MOTOR TYPE

OMSY655T

6" water-filled submersible motor, standard version, three-phase, 5,5kW (7.5HP).

OMSY6 SERIES MOTOR CROSS SECTION AND TABLE OF MATERIAL

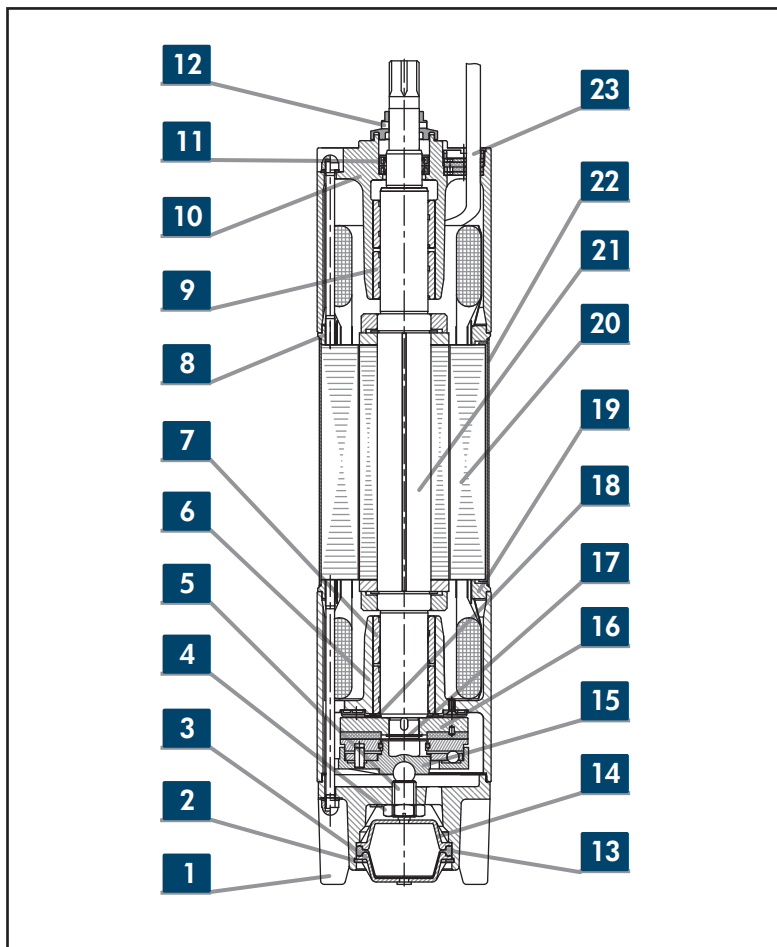

REF.N.	PART	MATERIAL	STANDARD
1	Base	Cast iron	ASTM 35A
2	Snap ring	Steel	---
3	Cover	Cast iron	ASTM 20A
4	Nut	Steel	---
5	Screw	Steel	---
6	Lower support	Cast iron	ASTM 30A
7	Bush bearing	Graphite	---
8	Upper flange	Stainless steel	AISI 304
9	Bush bearing	Graphite	---
10	Upper support	Cast iron	ASTM 30A
11	Lip seal	---	---
12	Sand protection	Stainless steel	---
13	Compensation bellow	NBR	---
14	Cover	---	---
15	Thrust bearing	---	---
16	Thrust disk	---	---
17	Ring	Steel	---
18	Plate	---	---
19	Lower flange	Stainless steel	AISI 304
20	Stator	---	---
21	Rotor	---	---
22	Motor casing	Stainless steel	---
23	Cable	---	---

DIMENSIONS AND WEIGHTS AT 50 Hz

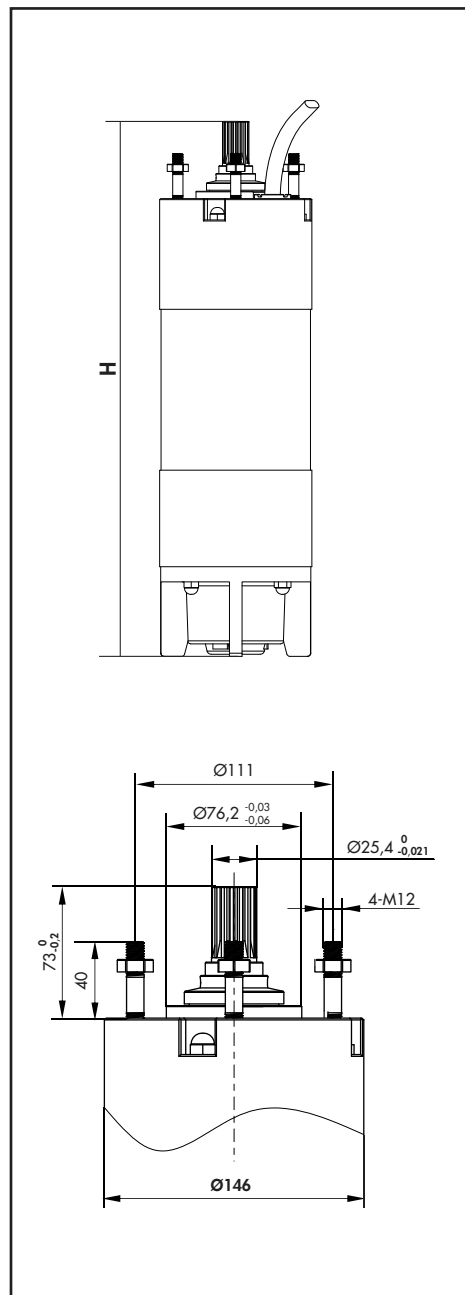

MOTOR TYPE	RATED POWER		H mm	WEIGHT kg
	kW	Hp		
OMSY630T	3	4	654	39
OMSY640T	4	5,5	684	43
OMSY655T	5,5	7,5	684	43
OMSY675T	7,5	10	704	45
OMSY692T	9,2	12,5	754	50
OMSY6110T	11	15	764	53
OMSY6130T	13	17,5	794	56
OMSY6150T	15	20	874	65
OMSY6185T	18,5	25	934	73
OMSY6220T	22	30	1019	83
OMSY6250T	25	35	1084	90
OMSY6300T	30	40	1169	100
OMSY6370T	37	50	1334	118
OMSY6450T	45	60	1394	125

- The robust design and choice of component materials ensure optimum operating performances, superior quality, reliability and ease of installation.

SPECIFICATIONS

- Shaft extension and couplings meet NEMA standards.
- Rewindable stator.
- Winding insulation: Class Y.
- Protection grade: IP68.
- Bigger compensation bellows for internal liquid expansion for severe operation condition.
- Oversized thrust bearings: Shaft supported by oversized thrust bearings which can support thrust load up to 15500 N.
- Mechanical seal: reliable, long service, more resistant to sand.
- Filling fluid: water mixed with non-toxic anti-freeze glycol, provides cooling and lubrication, also protects and prevents parts inside from corrosion.
- Maximum immersion depth: 200 m .
- Maximum number of starts per hour at regular intervals: 10.
- Maximum allowable voltage fluctuations over the rated voltage: $\pm 7\%$.

VERSION

- Three-phase from 3 to 45 kW, 380 V/50 Hz.

OPTIONAL FEATURES

- Different voltage and frequency.
- Different material.
- Motors with double cable outlets for star/delta start.



IDENTIFICATION CODE

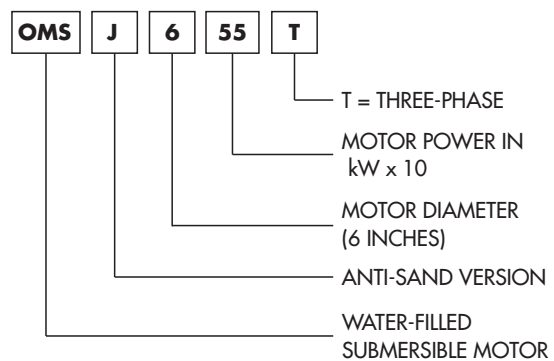

EXAMPLE OF MOTOR TYPE

OMSJ655T

6" water-filled submersible motor, anti-sand version , three-phase, 5,5kW(7.5HP).

OMSJ6 SERIES MOTOR CROSS SECTION AND TABLE OF MATERIAL

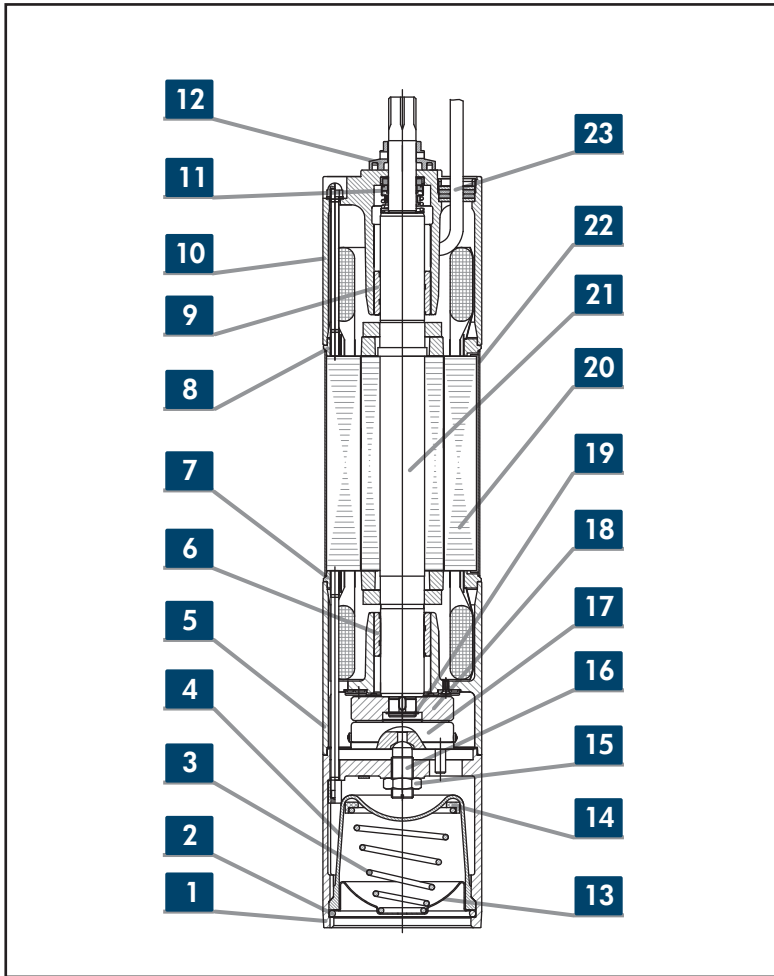

REF.N.	PART	MATERIAL	STANDARD
1	Base	Cast iron	ASTM 35A
2	Snap ring	Stainless steel	AISI 304
3	Conical spring	Stainless steel	AISI 304
4	Compensation bellow	NBR	----
5	Lower support	Cast iron	ASTM 30A
6	Bush bearing	Graphite	----
7	Upper flange	Stainless steel	AISI 304
8	Upper flange	Stainless steel	AISI 304
9	Bush bearing	Graphite	----
10	Upper support	Cast iron	ASTM 30A
11	Mechanical seal	----	----
12	Sand protection	Stainless steel	----
13	Gland	Stainless steel	AISI 304
14	Tower spring seat	----	----
15	Nut	Steel	----
16	Ball Screw	Steel	----
17	Thrust bearing	----	----
18	Thrust disk	----	----
19	Ring	Stainless steel	AISI 304
20	Stator	----	----
21	Rotor	----	----
22	Motor casing	Stainless steel	----
23	Cable	----	----

DIMENSIONS AND WEIGHTS AT 50 Hz

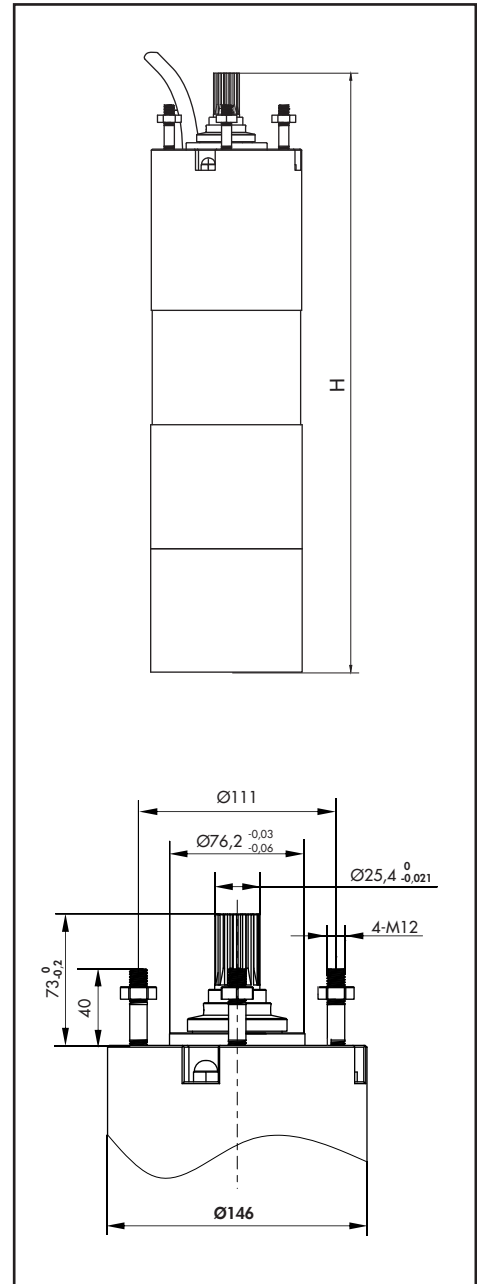

MOTOR TYPE	RATED POWER		H mm	WEIGHT kg
	kW	Hp		
OMSJ630T	3	4	726,4	41
OMSJ640T	4	5,5	756,4	45
OMSJ655T	5,5	7,5	756,4	45
OMSJ675T	7,5	10	776,4	47
OMSJ692T	9,2	12,5	826,4	52
OMSJ6110T	11	15	836,4	55
OMSJ6130T	13	17,5	866,4	58
OMSJ6150T	15	20	946,4	67
OMSJ6185T	18,5	25	1006,4	75
OMSJ6220T	22	30	1091,4	85
OMSJ6250T	25	35	1156,4	92
OMSJ6300T	30	40	1241,4	102
OMSJ6370T	37	50	1406,4	120
OMSJ6450T	45	60	1466,4	127

APPLICATIONS

- Water supply from deep well.
- Agricultural irrigation.
- Pressure boosting.
- Fire-fighting.
- Industrial application.

SPECIFICATIONS

- Delivery: up to 48 m³/h at 2850 rpm.
- Head: up to 373 m at 2850 rpm.
- Maximum pump overall diameter (cable cover included): 143 mm.
- Maximum permissible quantity of sand: 150 g/m³.
- Delivery port GAS 3".
- Maximum temperature of water in contact with motor: 35 °C.

CONSTRUCTION & CHARACTERISTICS

- Sturdy and lightweight, easy to disassemble and resistant to corrosion in non-aggressive environments.
- The delivery port and lower support are made of precision-cast stainless steel, ensuring resistance to corrosion, durability and a sturdy coupling to the motor.
- The impellers and diffusers are made of Noryl® PPO.
- The hexagonal pump shaft guarantees an effective impeller driving.
- A stainless steel non-return valve is fitted in the discharge to prevent back flow of water and alleviate water hammer to the pump, safeguarding impellers and diffusers.
- The guide bearings made of special TPU, ensure high resistance to wear and guarantee the constant and long-lasting using.
- Coupling and flange mounting dimensions meet NEMA standards.
- The B series pumps can be coupled to the 4" or 6" motors.
- Simple maintenance, rapid installation and dismantling.
- Standard and special versions available .

OPTIONAL FEATURES

- Different voltage and frequency.
- Dual cable outlet for star/delta starting.
- Cast iron lower support and delivery port (2,2 kW to 7,5 kW)



B SERIES

HYDRAULIC PERFORMANCE RANGE AT 50 Hz

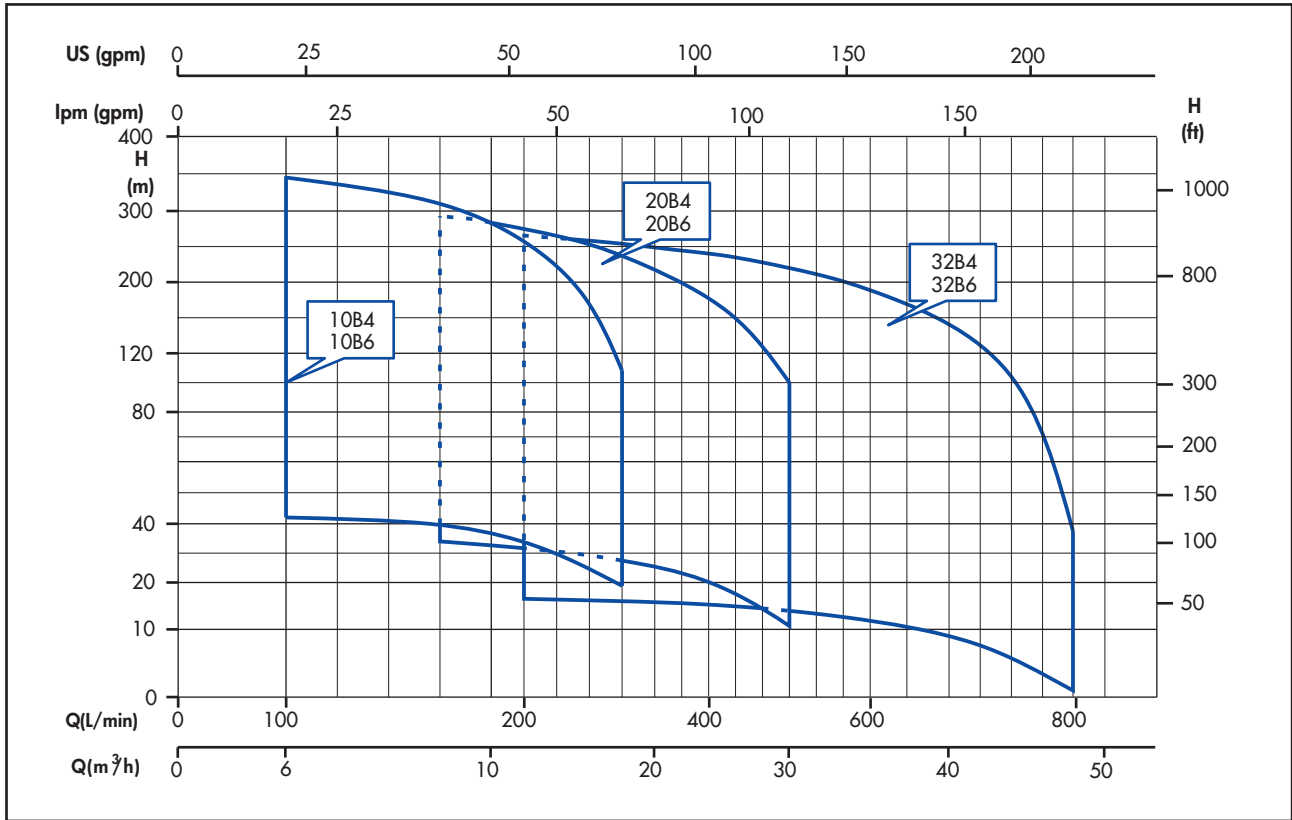

IDENTIFICATION CODE

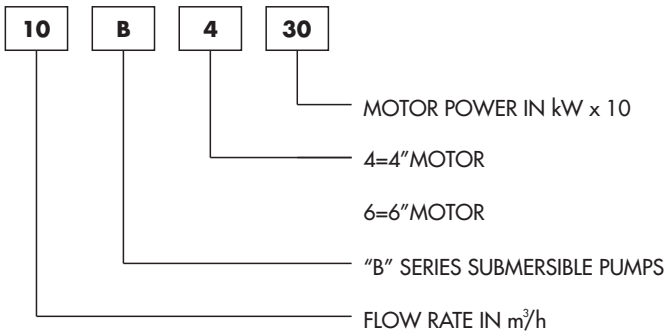

EXAMPLE OF PUMP TYPE

10B430
 B series submersible pump with flow rate in 10 m³/h and 4" motor 3 kW (4 Hp).

PUMP SECTION AND LIST OF MAIN COMPONENTS MATERIAL

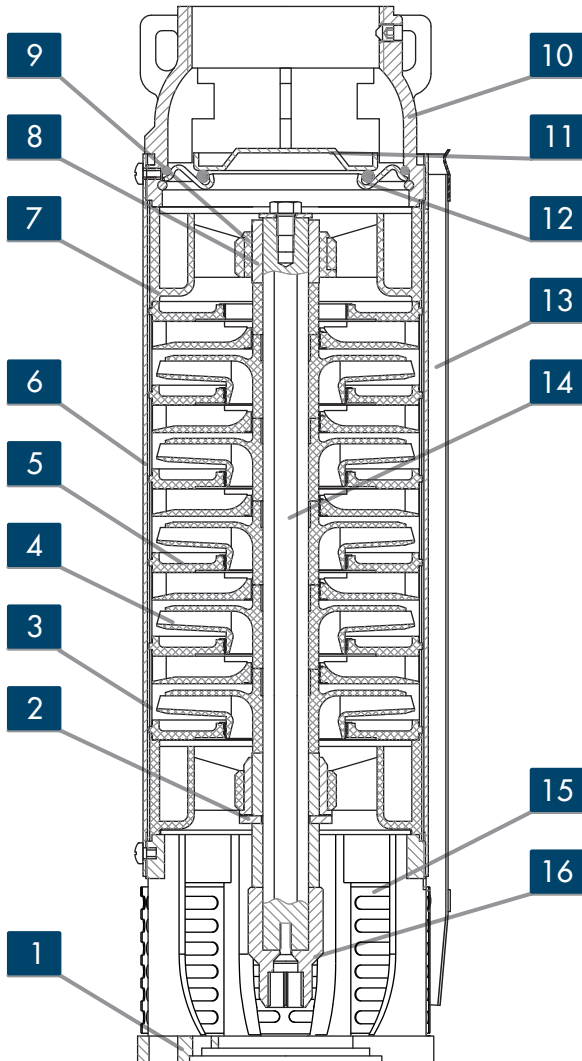

10B4-20B4 SERIES

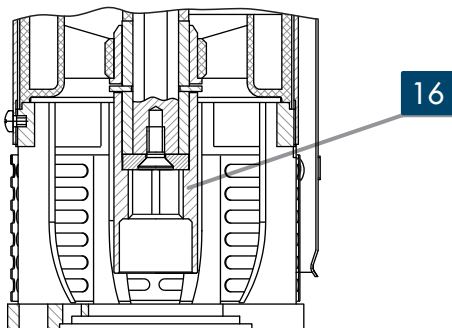

10B6-20B6 SERIES

REF.N.	PART	MATERIAL	STANDARD
1	Lower support	Precision-cast stainless steel / cast iron	AISI 304 / ASTM 200A
2	Thrust bearing	Stainless steel	AISI 304
3	Stage housing	Stainless steel	AISI 304
4	Impeller	Noryl® PPO	-----
5	Diffuser	Noryl® PPO	-----
6	Outer sleeve	Stainless steel	AISI 304
7	Upper support	Noryl® PPO	-----
8	Shaft sleeve	Stainless steel	AISI 304
9	Bush bearing	TPU	-----
10	Delivery port	Precision-cast stainless steel / cast iron	AISI 304 / ASTM 200A
11	Non-return valve	Stainless steel	AISI 304
12	Valve support with O ring	Stainless steel & NBR	AISI 304 & -----
13	Cable guard	Stainless steel	AISI 304
14	Shaft	Stainless steel	AISI 420
15	Filter	Stainless steel	AISI 304
16	Coupling	Stainless steel	AISI 304

32B SERIES

PUMP SECTION AND LIST OF MAIN COMPONENTS MATERIAL

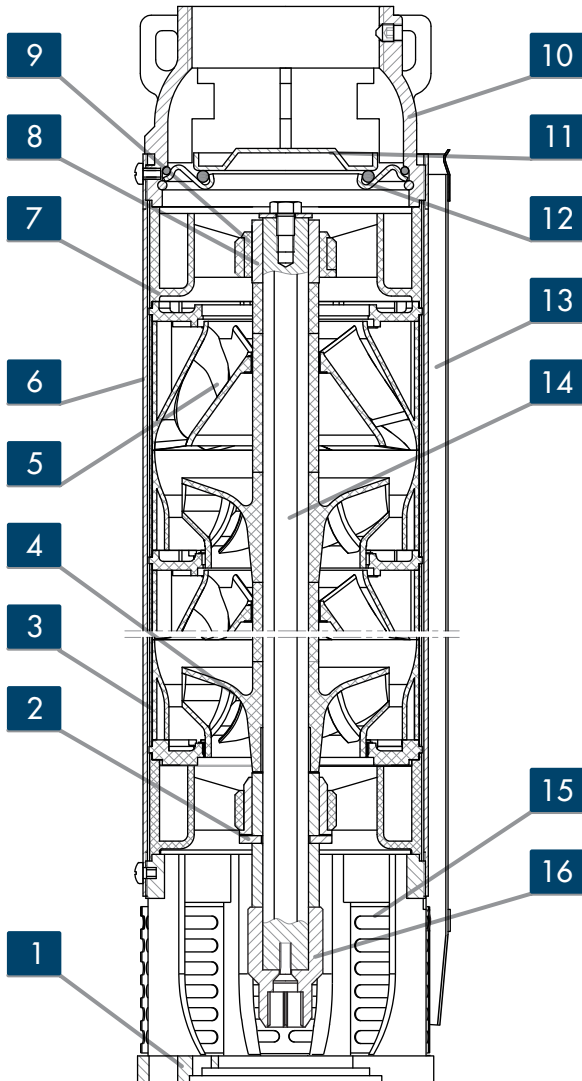

32B4 SERIES

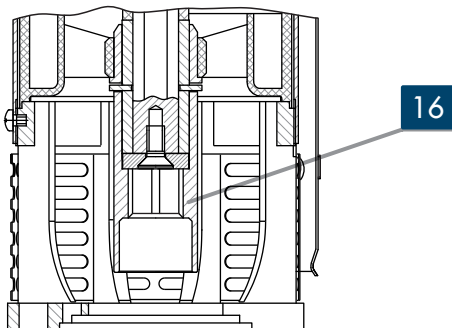

32B6 SERIES

REF.N.	PART	MATERIAL	STANDARD
1	Lower support	Precision-cast stainless steel / cast iron	AISI 304 / ASTM 200A
2	Thrust bearing	Stainless steel	AISI 304
3	Stage housing	Stainless steel	AISI 304
4	Impeller	Noryl® PPO	-----
5	Diffuser	Noryl® PPO	-----
6	Outer sleeve	Stainless steel	AISI 304
7	Upper support	Noryl® PPO	-----
8	Shaft sleeve	Stainless steel	AISI 304
9	Bush bearing	TPU	-----
10	Delivery port	Precision-cast stainless steel / cast iron	AISI 304 / ASTM 200A
11	Non-return valve	Stainless steel	AISI 304
12	Valve support with O ring	Stainless steel & NBR	AISI 304 & -----
13	Cable guard	Stainless steel	AISI 304
14	Shaft	Stainless steel	AISI 420
15	Filter	Stainless steel	AISI 304
16	Coupling	Stainless steel	AISI 304

OPERATING CHARACTERISTICS AT 50 Hz

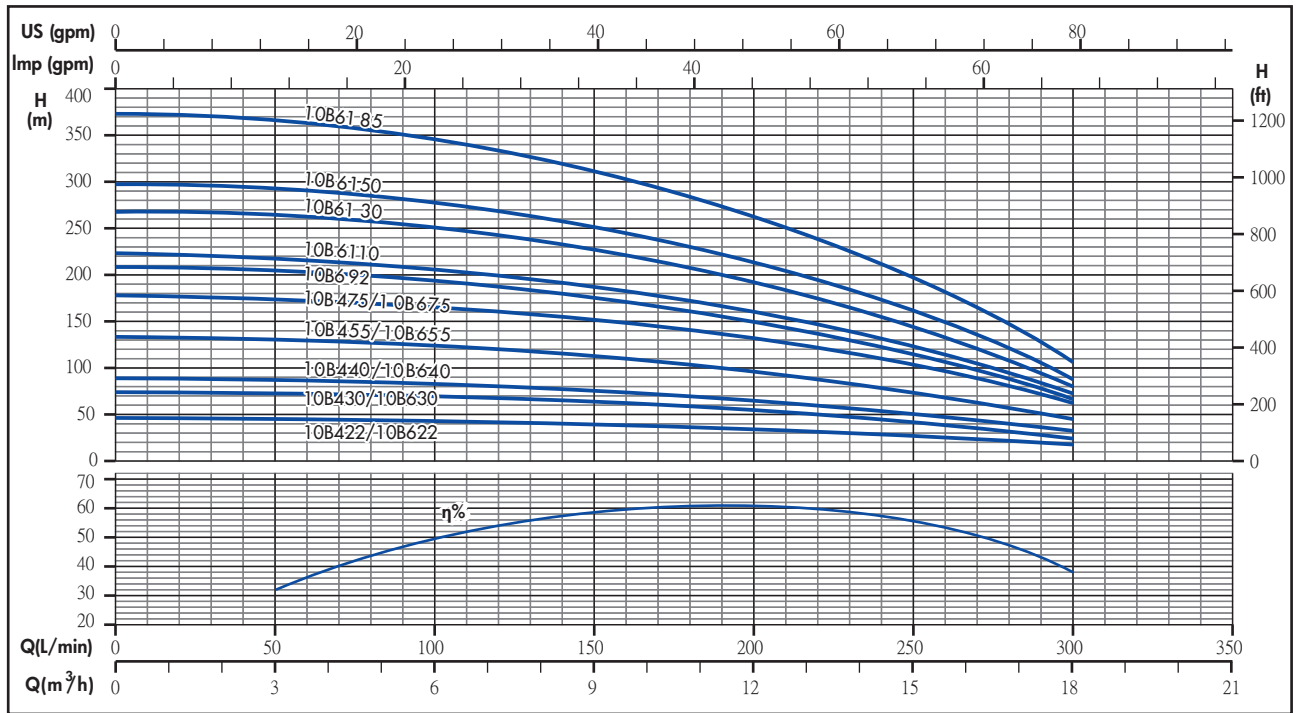

OPERATING CHARACTERISTICS AT 50 Hz

PUMP TYPE	N.OF STAGES	kW	Hp	Q=DELIVERY					
				l/min 0	100	150	200	250	300
				m ³ /h 0					
				6					
				9					
				12					
				15					
				18					
				H=TOTAL HEAD METERS COLUMN OF WATER					
10B422	3	2,2	3	46	42	40	34	27	19
10B622									
10B430	5	3	4	74	70	64	54	42	26
10B630									
10B440	6	4	5,5	89	82	76	64	49	32
10B640									
10B455	9	5,5	7,5	133	124	113	96	72	45
10B655									
10B475	12	7,5	10	178	165	153	130	102	62
10B675									
10B692	14	9,2	12,5	208	193	176	149	116	67
10B6110	15	11	15	223	207	189	160	124	72
10B6130	18	13	17,5	268	251	226	192	145	80
10B6150	20	15	20	298	279	251	213	161	89
10B6185	25	18,5	25	373	347	310	260	198	106

DIMENSIONS AND WEIGHTS AT 50 Hz

PUMP TYPE	N.OF STAGES	DN	L mm	PUMP WEIGHT kg
10B422	3	GAS 3"	409,5	8,5
10B622				9
10B430	5		488,5	9,5
10B630				10
10B440	6		528	10
10B640				10,5
10B455	9		646,5	12
10B655				12,5
10B475	12		765,5	14
10B675				14,5
10B692	14		844,5	16
10B6110	15		884,5	16,5
10B6130	18	1003	18,5	
10B6150	20	1082,5	19,5	
10B6185	25	1332,5	23,5	

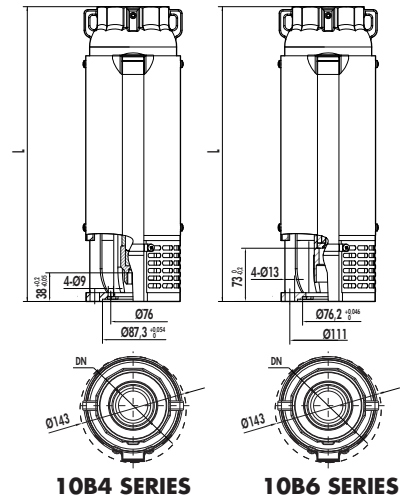

20B SERIES

OPERATING CHARACTERISTICS AT 50 Hz

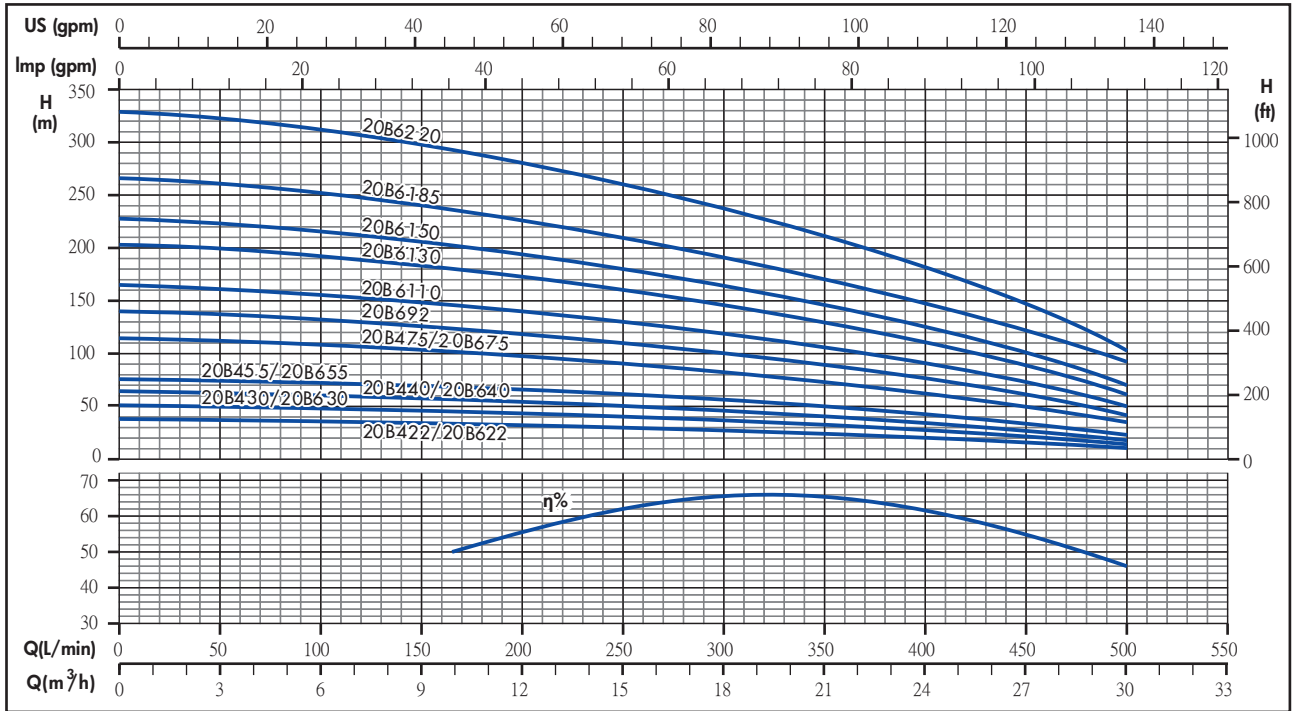

OPERATING CHARACTERISTICS AT 50 Hz

PUMP TYPE	N.OF STAGES	kW	Hp	Q=DELIVERY					
				l/min 0	150	250	350	400	500
				m³/h 0	9	15	21	24	30
H=TOTAL HEAD METERS COLUMN OF WATER									
20B422	3	2,2	3	38	34	30	24	20	11
20B622									
20B430	4	3	4	51	46	40	32	27	14,5
20B630									
20B440	5	4	5,5	64	57	50	40	34	18
20B640									
20B455	6	5,5	7,5	76	68	61	49	42	23
20B655									
20B475	9	7,5	10	114	103	90	73	63	35
20B675									
20B692	11	9,2	12,5	139	126	110	89	77	42
20B6110	13	11	15	165	149	130	105	91	50
20B6130	16	13	17,5	204	183	160	130	112	62
20B6150	18	15	20	228	206	180	146	126	70
20B6185	21	18,5	25	266	240	210	170	147	82
20B6220	26	22	30	329	298	260	211	182	101

DIMENSIONS AND WEIGHTS AT 50 Hz

PUMP TYPE	N.OF STAGES	DN	L mm	PUMP WEIGHT kg
20B422	3	GAS 3"	445,5	8
20B622				8,5
20B430	4		495,5	9
20B630				9,5
20B440	5		545,5	9,5
20B640				10
20B455	6		595,5	10,5
20B655				11
20B475	9		746	12,5
20B675				13
20B692	11		846	15
20B6110	13		946	16,5
20B6130	16	1096	18,5	
20B6150	18	1196,5	20	
20B6185	21	1403	23,5	
20B6220	26	1653,5	27,5	

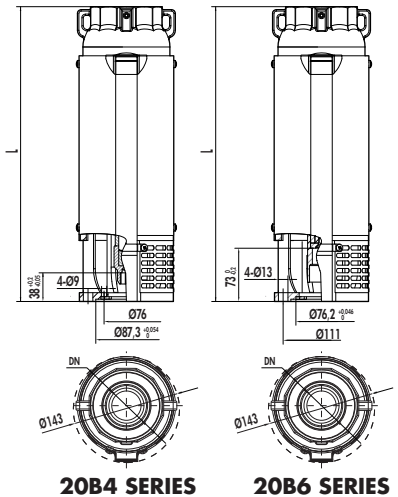

32B SERIES

OPERATING CHARACTERISTICS AT 50 Hz

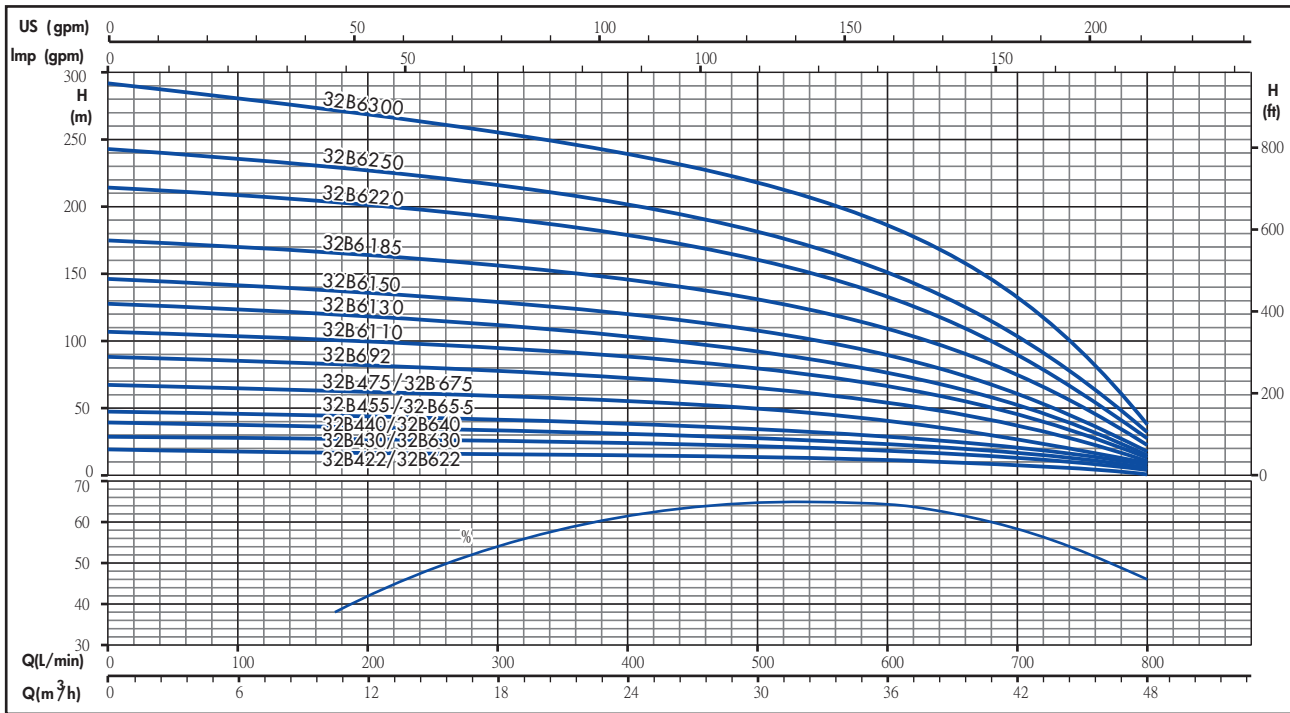

OPERATING CHARACTERISTICS AT 50 Hz

PUMP TYPE	N.OF STAGES	kW	Hp	Q=DELIVERY							
				l/min 0	200	300	400	500	600	700	800
				m³/h 0 12 18 24 30 36 42 48							
				H=TOTAL HEAD METERS COLUMN OF WATER							
32B422	2	2,2	3	19	17	16,5	15	14	11	8	2,5
32B622				19	17	16,5	15	14	11	8	2,5
32B430	3	3	4	29	26	25	23	21	17	12	4
32B630				29	26	25	23	21	17	12	4
32B440	4	4	5,5	39	35	33	31	28	23	16	5
32B640				39	35	33	31	28	23	16	5
32B455	5	5,5	7,5	48	43	42	38	35	28	20	7
32B655				48	43	42	38	35	28	20	7
32B475	7	7,5	10	68	61	58	54	49	40	28	9
32B675				68	61	58	54	49	40	28	9
32B692	9	9,2	12,5	84	82	78	73	63	55	37	11
32B6110	11	11	15	107	100	95	89	77	67	45	14
32B6130	13	13	17,5	125	118	112	104	91	78	52	16
32B6150	15	15	20	146	136	129	120	105	90	60	19
32B6185	18	18,5	25	175	165	156	146	126	110	75	23
32B6220	22	22	30	214	201	192	179	154	133	90	28
32B6250	25	25	34	243	230	215	201	175	151	103	32
32B6300	30	30	40	292	270	255	240	210	187	133	38

DIMENSIONS AND WEIGHTS AT 50 Hz

PUMP TYPE	N.OF STAGES	DN	L mm	PUMP WEIGHT kg
32B422	2	GAS 3"	521	9
32B622				9,5
32B430	3		634	11
32B630				11,5
32B440	4		747	12,5
32B640				13
32B455	5		860,5	14,5
32B655				15
32B475	7		1086,5	17,5
32B675				18
32B692	9		1312,5	22
32B6110	11		1595,5	26
32B6130	13	1821,5	30	
32B6150	15	2047,5	33	
32B6185	18	2443,5	39,5	
32B6220	22	2895,5	46,5	
32B6250	25	3234,5	52	
32B6300	30	3856,5	60,5	

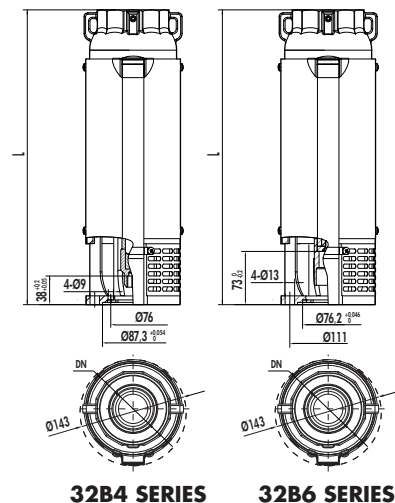



www.sistema.it