



6" Floating Impeller Submersible Pumps

Made in Italy



Catalogo 50 Hz

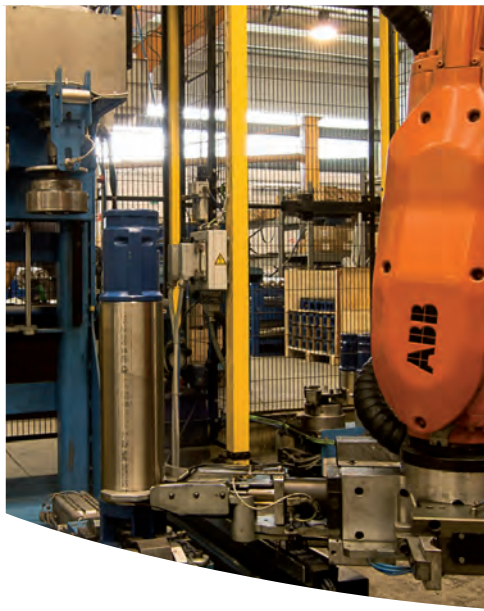

6" 140 PR/PRX - HIGH CAPACITY SUBMERSIBLE PUMP WITH SEMIAXIAL IMPELLER

Floating Impeller Patented

Robotized assembly

Maximum sand content: 400 gr/m³

Noryl Impeller and Diffuser Stainless Steel Casing AISI 304

Rubber globe version

Stainless Steel Cap Valve Version AISI 304



ELECTRIC SUBMERSIBLE PUMPS CASED VERSION 6" (SERIES 140 PR N - 140 PRX N)

The submersible pumps serie 140 PR N, in the range of 6" submersible pumps, are unique in the world to have a floating impeller with front shim adjustement. This innovative and patented concept provides to face continuous applications without renouncing to performances and efficiencies at the summit of this field, with a great competitiveness of the product in all range also to a economic level.

Suitable for clean water supply in domestic, industrial, pressure boosters, firefighting systems, irrigation and water system networks.

ADVANTAGES

- High Efficiency
- High wear resistance to sand
- Longer pump life thanks to the high quality of materials and to the specific floating impeller design
- Very low maintenance need
- Components F.D.A approved

MATERIALS

The materials of standard execution are: Impeller in technopolymer (Lexan) Diffuser in technopolymer (Lexan) Intermediate casing in Stainless Steel AISI 304 External sleeve in Stainless Steel AISI 304 Delivery bowl and suction cage in mechanical cast iron G25 Non return valve (rubber globe) included. Besides standard construction the pumps can be manufactured with the Delivery Bowl and suction cage in precision Stainless Steel AISI 304. Also Available with suction cage and delivery bowl in AISI 304 Stainless steel.

HYDRAULIC PERFORMANCES

Capacity up to 48 m³/h Manometric head up to 630 m.

Power up to 37 Kw - 50 HP.

Maximum quantity of sand suspended in the water: 400g/m³



6" 140 PR / PRX 6 - HYDRAULIC PERFORMANCES

Motor		50 Hz - 2900 rpm			Q = Capacity							
Type	Power		V 400	l/min	0	60	80	100	120	140	160	180
	kW	HP	A	l/sec	0	1	1,33	1,67	2	2,33	2,67	3
				m³/h	0	3,6	4,8	6	7,2	8,4	9,6	10,8
140 PR6 N/05	2,20	3	5,5	H[m]	73	68	64	57	48	39	30	15
140 PR6 N/07	3	4	6,7		102	95	90	79	67	54	42	21
140 PR6 N/10	4	5,5	10		146	136	128	113	96	77	60	30
140 PR6 N/14	5,50	7,5	12,5		204	190	179	158	134	108	84	42
140 PR6 N/19	7,50	10	17,5		277	258	243	215	182	146	114	57
140 PR6 N/23	9,20	12,5	21		336	313	294	260	221	177	138	69
140 PR6 N/28	11	15	24,5		409	381	358	316	269	216	168	84
140 PR6 N/33	13	17,5	28		482	449	422	373	317	254	198	99

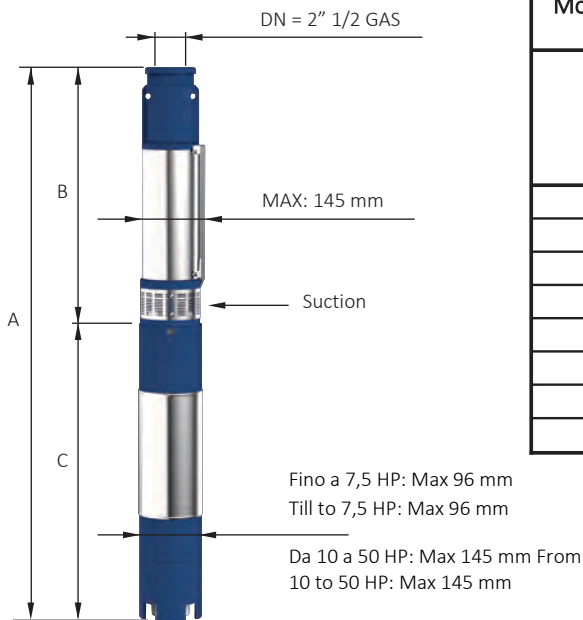

Motor 50 Hz - 2900 rpm	Overall dimensions and weights				
Type	A mm Tri	B mm	C mm Tri	M kg Tri	P kg
140 PR6 N/05	947	495	452	15	14
140 PR6 N/07	1104	547	557	19	16
140 PR6 N/10	1222	625	597	22	18
140 PR6 N/14	1427	729	698	27	21
140 PR6 N/19	1592	891	701	55	25
140 PR6 N/23	1746	995	751	60	28
140 PR6 N/28	1936	1125	811	65	32
140 PR6 N/33	2096	1255	841	70	36



140 PRX

Suction cage and delivery bowl
(with cap valve) in AISI 304 casted

n% = Pump efficiency
W/st = Stage absorption

Max 54%
Max 400

6" 140 PR / PRX 6 - HYDRAULIC PERFORMANCES

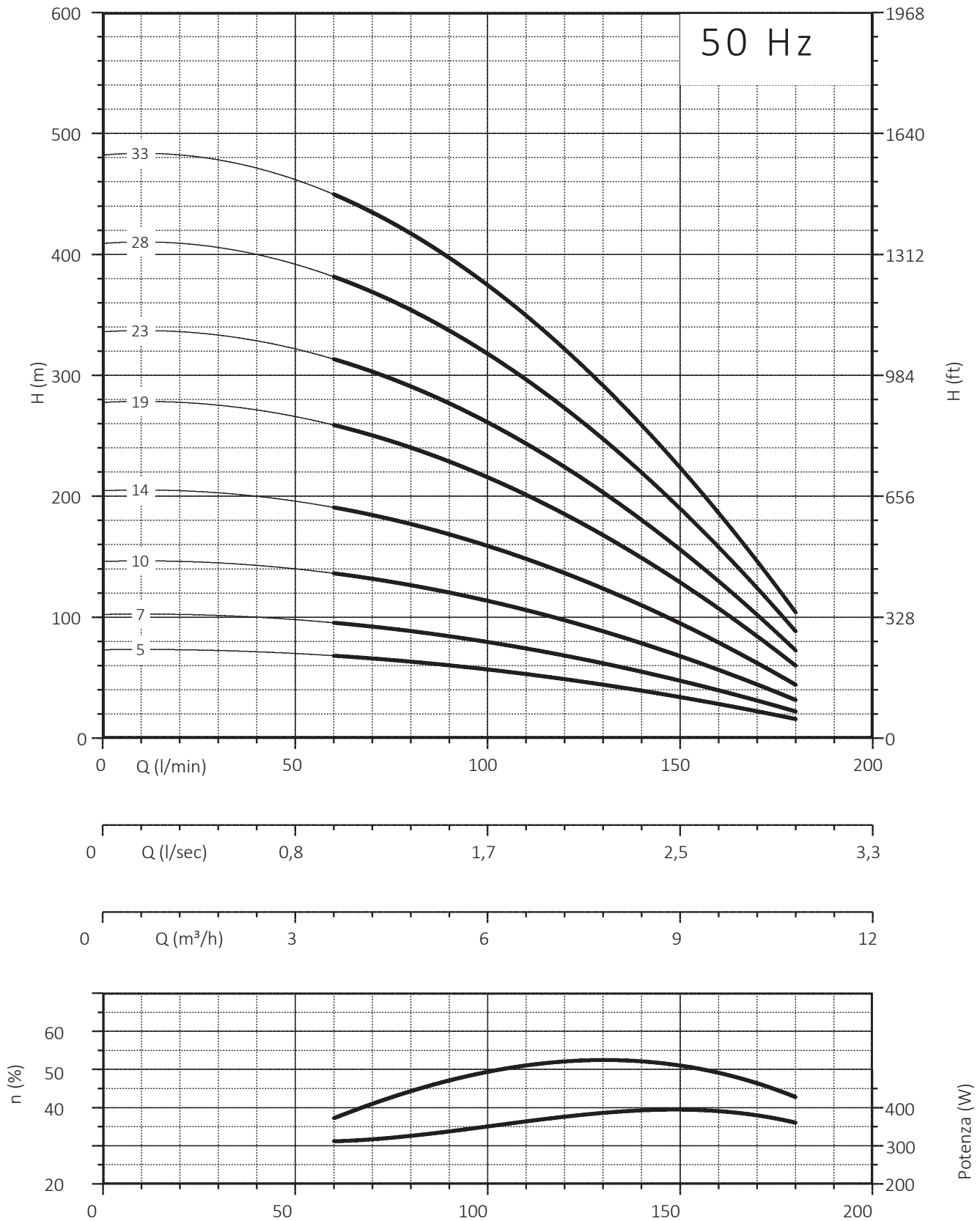

NPSH (m)	25%	50%	75%	100%
140 PR 6 - 140 PRX6	2,2	2,2	2,7	3,5

Maximum Sand Content :400gr/m³

6" 140 PR / PRX 8 - HYDRAULIC PERFORMANCES

Motor		50 Hz - 2900 rpm			Q = Capacity								
Type	Power		V 400	l/min	0	80	100	120	140	160	180	200	220
	kW	HP	A	l/sec	0	1,33	1,67	2,00	2,33	2,67	3,00	3,33	3,67
				m³/h	0	4,8	6	7,2	8,4	9,6	10,8	12,0	13,2
140 PR8 N/05	2,20	3	5,5	H[m]	75	68	64	58	52	44	36	27	18
140 PR8 N/07	3	4	6,7		105	95	90	81	72	62	50	37	25
140 PR8 N/10	4	5,5	10		150	136	128	116	103	88	71	53	35
140 PR8 N/13	5,50	7,5	12,5		195	177	166	151	134	114	92	69	46
140 PR8 N/18	7,50	10	17,5		270	245	230	209	185	158	128	95	63
140 PR8 N/22	9,20	12,5	21		330	299	282	255	227	194	156	117	77
140 PR8 N/27	11	15	24,5		405	367	346	313	278	238	192	143	95
140 PR8 N/32	13	17,5	28		480	435	410	371	330	282	227	170	112
140 PR8 N/36	15	20	32		540	490	461	418	371	317	256	191	126

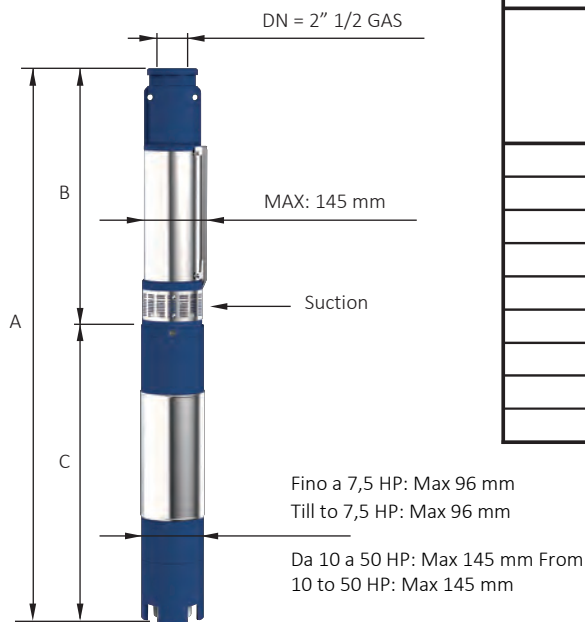

Motor 50 Hz - 2900 rpm	Overall dimensions and weights				
Type	A mm Tri	B mm	C mm Tri	M kg Tri	P kg
140 PR8 N/05	947	495	452	15	14
140 PR8 N/07	1104	547	557	19	16
140 PR8 N/10	1222	625	597	22	18
140 PR8 N/13	1401	703	698	27	21
140 PR8 N/18	1651	833	818	32	25
140 PR8 N/22	1720	969	751	60	28
140 PR8 N/27	1910	1099	811	65	32
140 PR8 N/32	2070	1229	841	70	36
140 PR8 N/36	2264	1333	931	75	40



140 PRX

Suction cage and delivery bowl
(with cap valve) in AISI 304 casted

n% = Pump efficiency
W/st = Stage absorption

Max 59%
Max 410

6" 140 PR / PRX 8 - HYDRAULIC PERFORMANCES

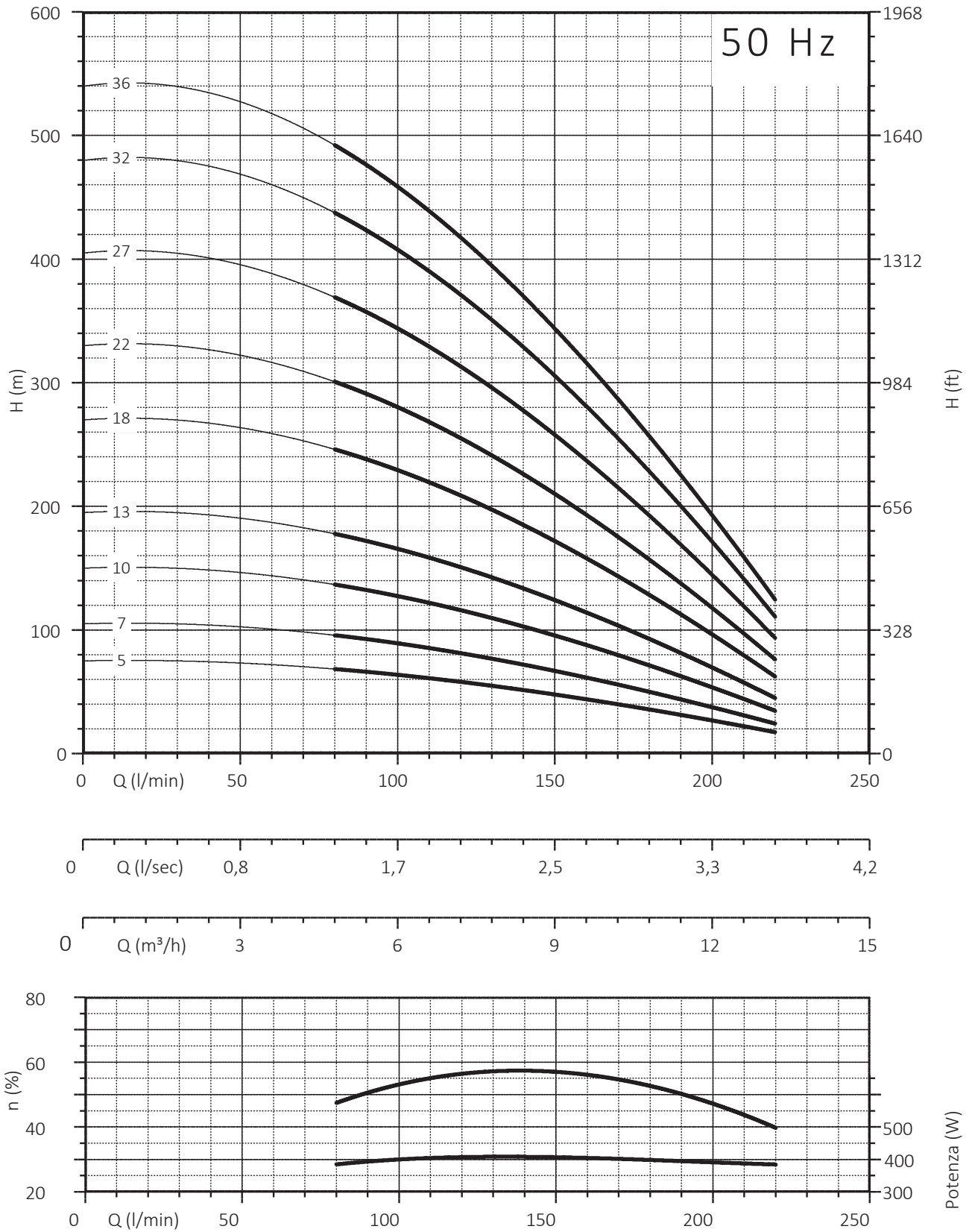

NPSH (m)	25%	50%	75%	100%
140 PR 8 - 140 PRX 8	2,2	2,2	3	4,8

Maximum Sand Content :400gr/m³

6" 140 PR / PRX 9 - HYDRAULIC PERFORMANCES

Motor		50 Hz - 2900 rpm			Q = Capacity							
Type	Power		V 400	l/min	0	80	110	140	170	200	230	260
	kW	HP	A	l/sec	0	1,33	1,83	2,33	2,83	3,33	3,83	4,33
				m³/h	0	4,8	6,6	8,4	10,2	12	13,8	15,6
140 PR9 N/04	2,20	3	5,5	H[m]	64	62	59	56	51	45	37	26
140 PR9 N/06	3	4	6,7		96	93	89	84	77	68	56	39
140 PR9 N/08	4	5,5	10		128	124	118	112	102	90	74	52
140 PR9 N/11	5,50	7,5	12,5		176	171	162	154	140	124	102	72
140 PR9 N/15	7,50	10	17,5		240	233	221	210	191	169	139	98
140 PR9 N/18	9,20	12,5	21		288	279	266	252	230	203	167	117
140 PR9 N/22	11	15	24,5		352	341	325	308	281	248	204	143
140 PR9 N/26	13	17,5	28		416	403	384	364	332	293	241	169
140 PR9 N/30	15	20	32		480	465	443	420	383	338	278	195

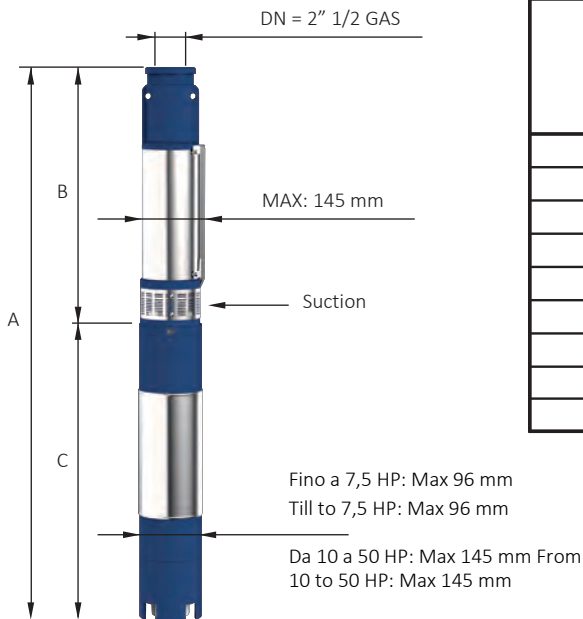

Motor 50 Hz - 2900 rpm	Overall dimensions and weights				
Type	A mm Tri	B mm	C mm Tri	M kg Tri	P kg
140 PR9 N/04	921	469	452	15	14
140 PR9 N/06	1078	521	557	19	16
140 PR9 N/08	1170	573	597	22	18
140 PR9 N/11	1349	651	698	27	21
140 PR9 N/15	1456	755	701	55	25
140 PR9 N/18	1584	833	751	60	28
140 PR9 N/22	1780	969	811	65	32
140 PR9 N/26	1914	1073	841	70	36
140 PR9 N/30	2108	1177	931	75	40



140 PRX

Suction cage and delivery bowl
(with cap valve) in AISI 304 casted

n% = Pump efficiency
kW/st = Stage absorption

Max 77%
Max 0,49

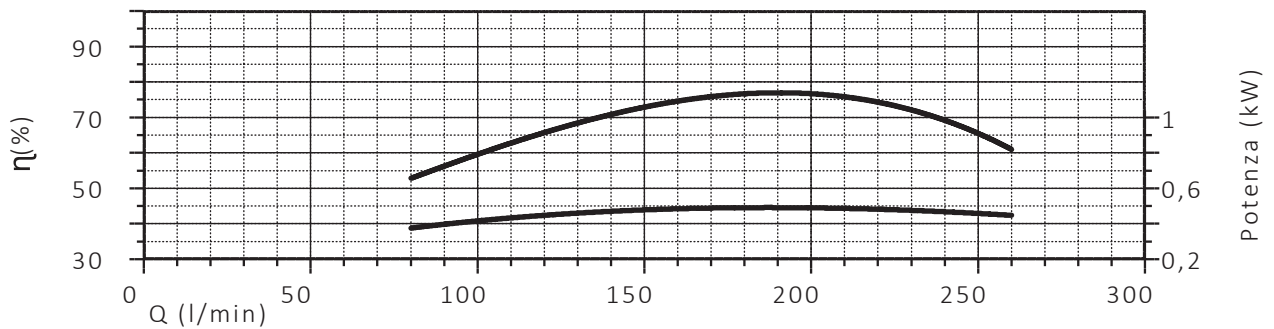
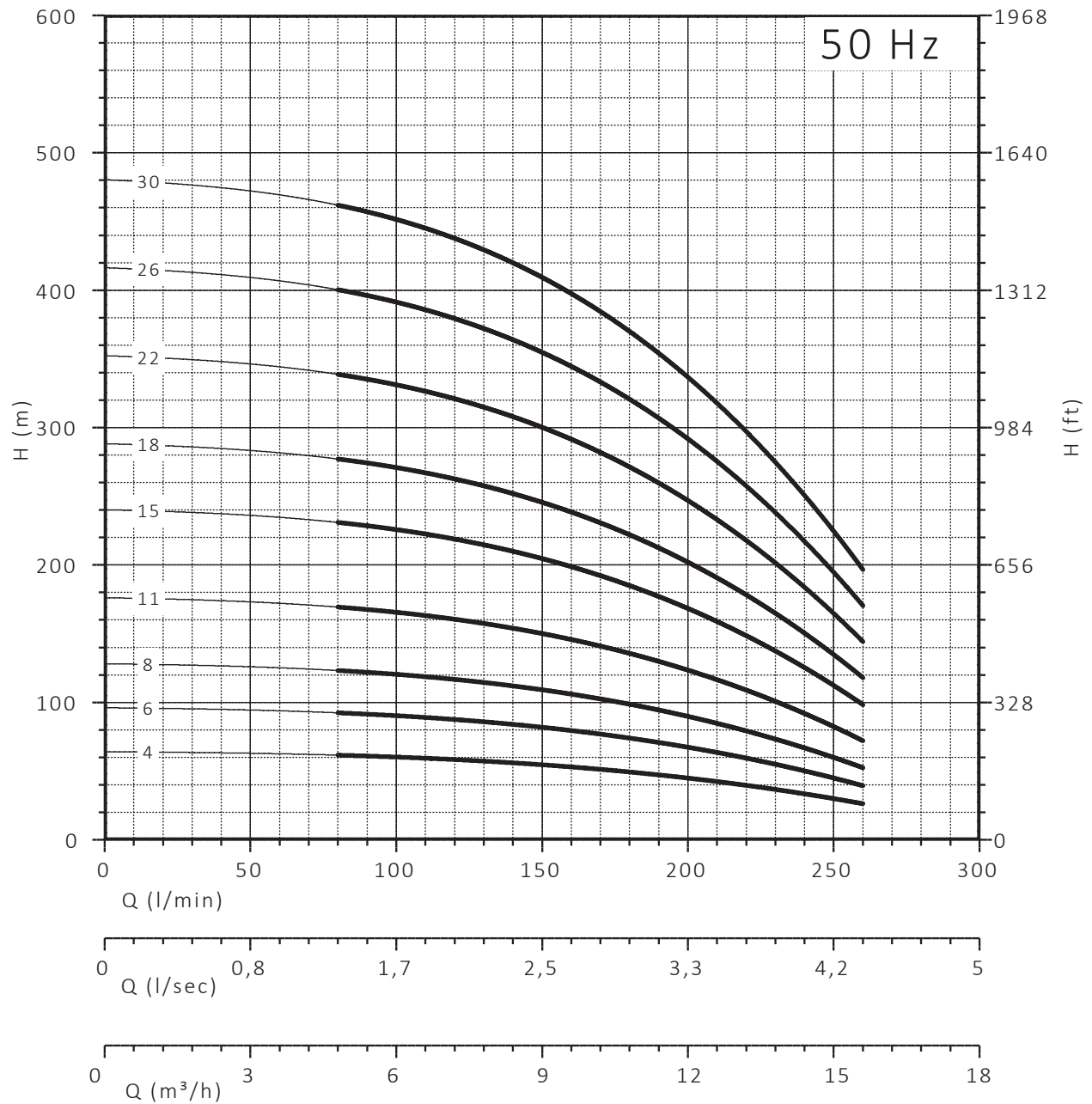
6" 140 PR / PRX 9 - HYDRAULIC PERFORMANCES



NPSH (m)	25%	50%	75%	100%
140 PR 9 - 140 PRX 9	2,2	2,2	3	4,8

Maximum Sand Content :400gr/m³

6" 140 PR / PRX 12 - HYDRAULIC PERFORMANCES

Motor		50 Hz - 2900 rpm			Q = Capacity					
Type	Power		V 400	l/min	0	100	150	200	250	300
	kW	HP	A	l/sec	0	1,67	2,50	3,33	4,17	5
				m³/h	0	6	9	12	15	18
140 PR12 N/06	3	4	6,7	H[m]	82	78	74	66	54	38
140 PR12 N/08	4,00	5,5	10		109	104	99	88	72	51
140 PR12 N/11	5,50	7,5	12,5		150	143	136	121	99	70
140 PR12 N/14	7,50	10	17,5		191	182	173	154	126	89
140 PR12 N/18	9,20	12,5	21		246	234	222	198	162	114
140 PR12 N/20	11	15	24,5		273	260	247	220	180	127
140 PR12 N/25	13	17,5	28		342	325	308	275	225	158
140 PR12 N/30	15	20	32		410	390	370	330	270	190
140 PR12 N/35	18,50	25	40		478	455	432	385	315	222
140 PR12 N/40	22	30	47,5		546	520	493	440	360	253

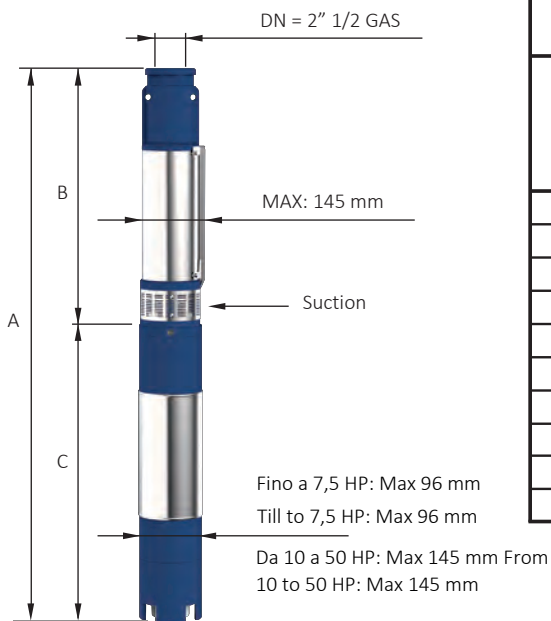

Motor 50 Hz - 2900 rpm	Overall dimensions and weights				
Type	A mm Tri	B mm	C mm Tri	M kg Tri	P kg
140 PR12 N/06	1078	521	557	19	16
140 PR12 N/08	1170	573	597	22	18
140 PR12 N/11	1349	651	698	27	21
140 PR12 N/14	1430	729	701	55	25
140 PR12 N/18	1616	865	751	60	29
140 PR12 N/20	1728	917	811	65	31
140 PR12 N/25	1888	1047	841	70	37
140 PR12 N/30	2108	1177	931	75	42
140 PR12 N/35	2330	1339	991	83	47
140 PR12 N/40	2540	1469	1071	92	52



140 PRX

Suction cage and delivery bowl
(with cap valve) in AISI 304 casted

n% = Pump efficiency
kW/st = Stage absorption

Max 72,6%
Max 0,50

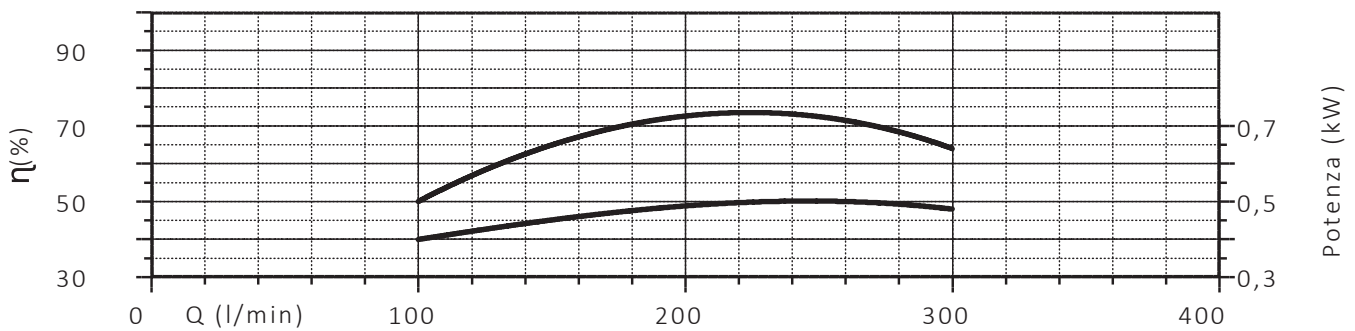
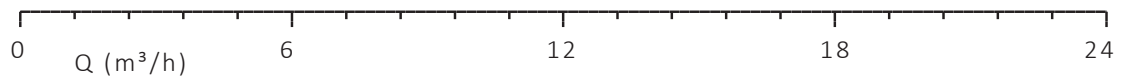
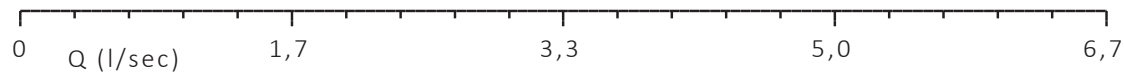
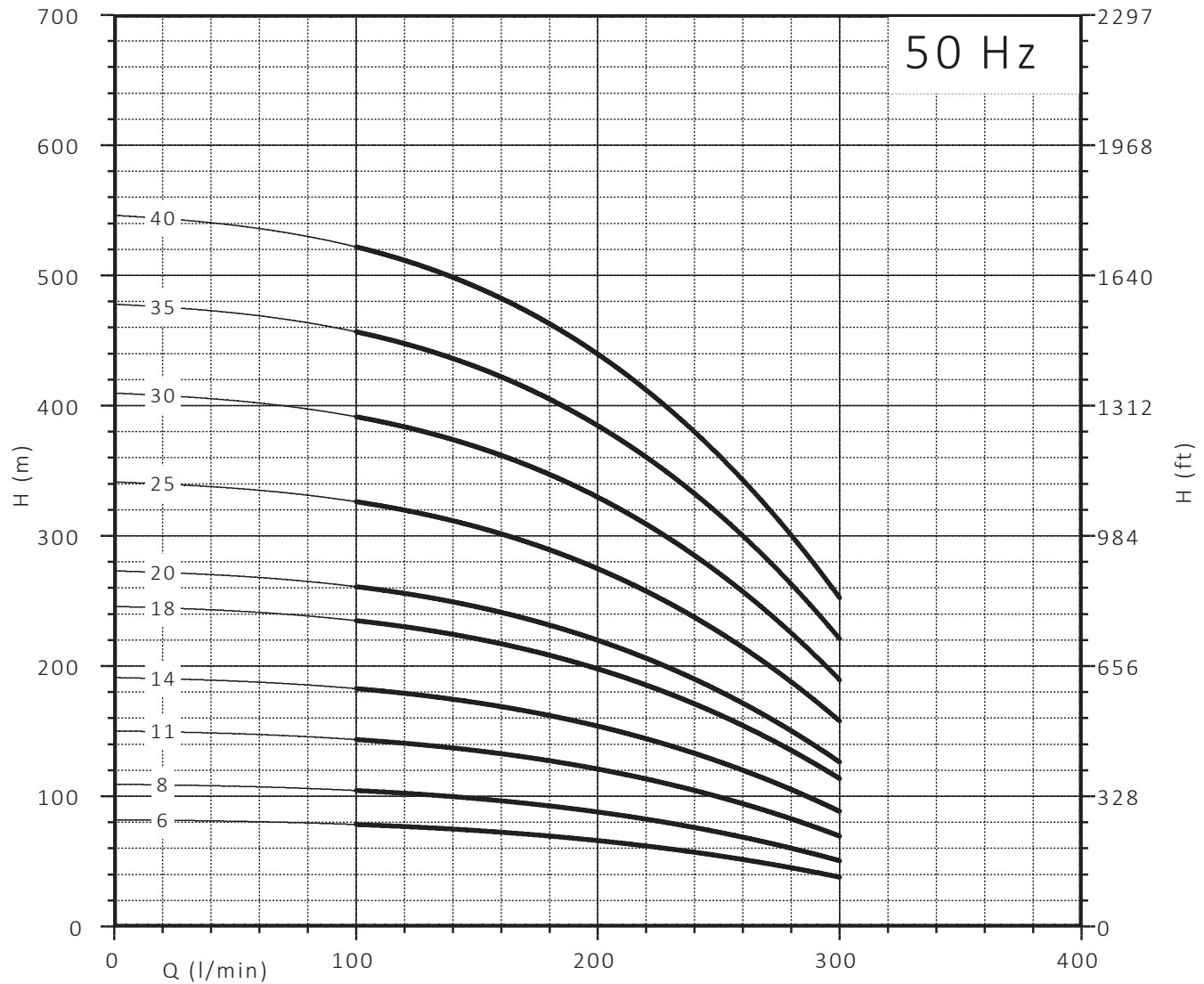
6" 140 PR / PRX 12 - HYDRAULIC PERFORMANCES



NPSH (m)	25%	50%	75%	100%
140 PR 12 - 140 PRX 12	2,2	2,2	3	4,8

Maximum Sand Content :400gr/m³

6" 140 PR / PRX 16 - HYDRAULIC PERFORMANCES

Motor		50 Hz - 2900 rpm			Q = Capacity							
Type	Power		V 400	l/min	0	150	200	250	300	350	400	450
	kW	HP	A	l/sec	0	2,50	3,33	4,17	5	5,83	6,67	7,50
				m³/h	0	9	12	15	18	21	24	27
140 PR16 N/03	3	4	6,7	H[m]	51	47	44	42	36	30	23	14
140 PR16 N/05	4	5,5	10		84	78	74	69	60	50	38	23
140 PR16 N/06	5,50	7,5	12,5		101	93	89	83	72	60	45	28
140 PR16 N/09	7,50	10	17,5		152	140	133	125	108	89	68	41
140 PR16 N/11	9,20	12,5	21		185	171	162	152	132	109	83	51
140 PR16 N/13	11	15	24,5		219	202	192	180	156	129	98	60
140 PR16 N/15	13	17,5	28		253	234	221	208	180	149	113	69
140 PR16 N/18	15	20	32		303	280	266	249	217	179	135	83
140 PR16 N/22	18,50	25	40		370	343	325	304	265	218	165	101
140 PR16 N/26	22	30	47,5		438	405	384	360	313	258	195	120
140 PR16 N/31	26	35	55		522	483	458	429	373	308	233	143
140 PR16 N/36	30	40	62,5		606	561	531	498	433	357	270	166

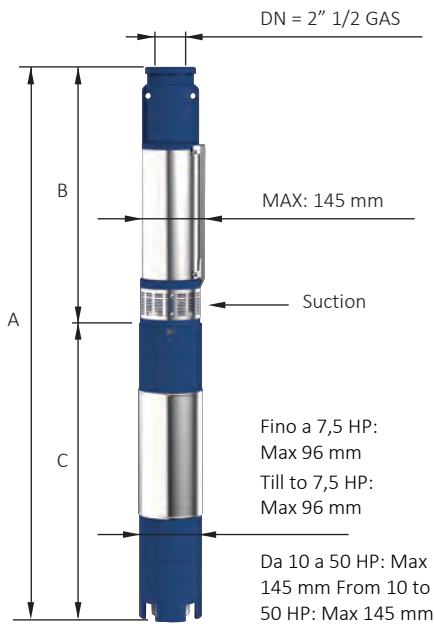

Motor 50 Hz - 2900 rpm	Overall dimensions and weights				
Type	A mm Tri	B mm	C mm Tri	M kg Tri	P kg
140 PR16 N/03	1022,5	465,5	557	19	14
140 PR16 N/05	1129,5	532,5	597	22	15
140 PR16 N/06	1264	566	698	27	16
140 PR16 N/09	1484,5	666,5	818	32	18
140 PR16 N/11	1484,5	733,5	751	60	22
140 PR16 N/13	1611,5	800,5	811	65	24
140 PR16 N/15	1708,5	867,5	841	70	27
140 PR16 N/18	1899	968	931	75	31
140 PR16 N/22	2093	1102	991	83	34
140 PR16 N/26	2307	1236	1071	92	38
140 PR16 N/31	2584,5	1403,5	1181	100	40
140 PR16 N/36	2822	1571	1251	108	42

140 PRX
*Suction cage and delivery bowl
(with cap valve) in AISI 304 casted*

n% = Pump efficiency kW/st
= Stage absorption

Max 69%
Max 0,84

6" 140 PR / PRX 16 - HYDRAULIC PERFORMANCES

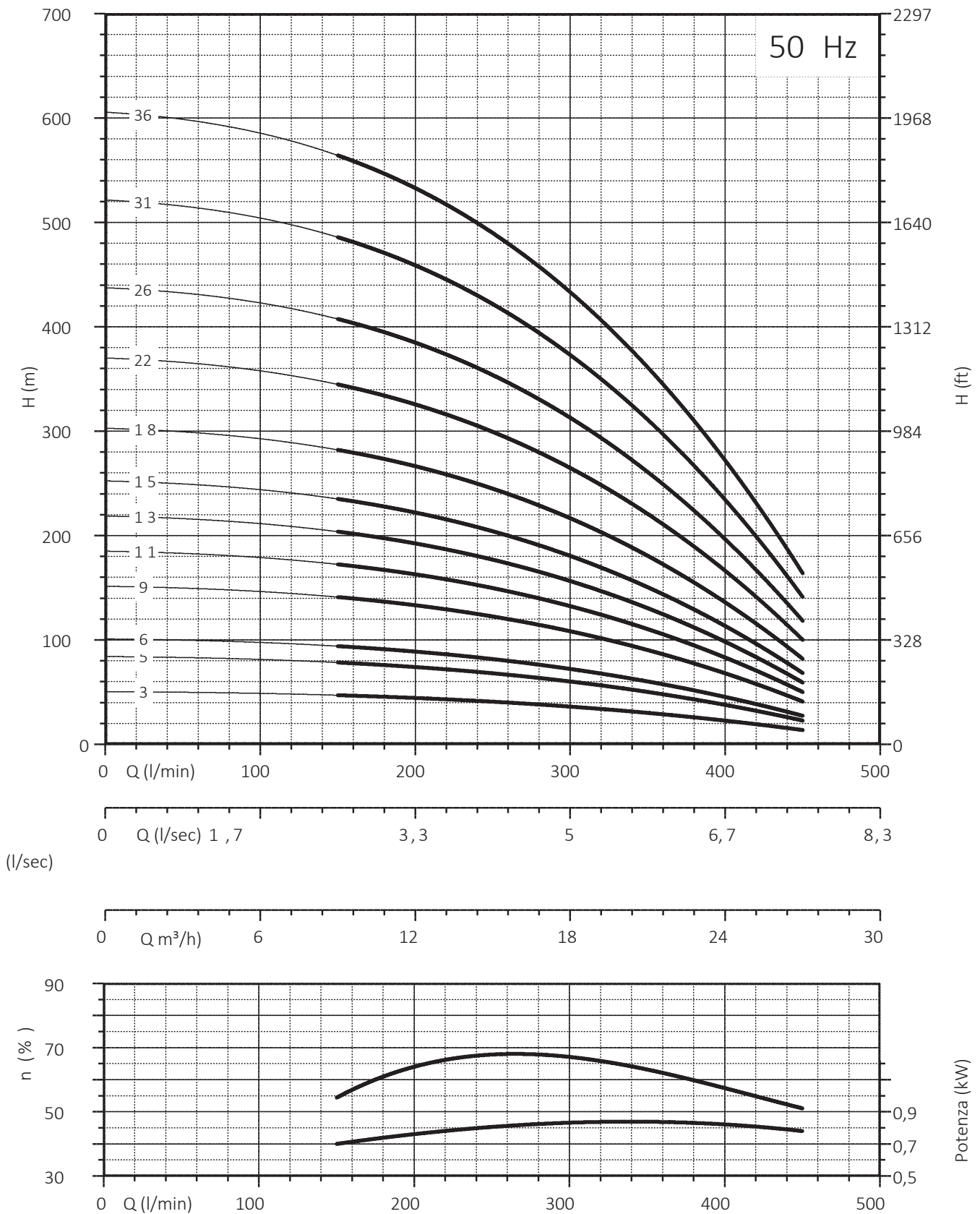

NPSH (m)	25%	50%	75%	100%
140 PR 16 - 140 PRX 16	3	3	4	6

Maximum Sand Content :400gr/m³

6" 140 PR / PRX 24 - HYDRAULIC PERFORMANCES

Motor				50 Hz - 2900 rpm						Q = Capacity							
Type	Power		V 400	l/min	0	200	300	400	500	600	H[m]	0	3,33	5	6,67	8,33	10
	kW	HP	A	l/sec	0	3,33	5	6,67	8,33	10							
				m³/h	0	12	18	24	30	36							
140 PR24 N/04	3	4	6,7		54	47	43	35	24	11							
140 PR24 N/05	4	5,5	10		68	59	54	44	30	14							
140 PR24 N/07	5,50	7,5	12,5		95	82	75	61	41	20							
140 PR24 N/09	7,50	10	17,5		122	105	96	78	53	26							
140 PR24 N/11	9,20	12,5	21		149	129	118	96	65	31							
140 PR24 N/13	11	15	24,5		176	152	139	113	77	37							
140 PR24 N/16	13	17,5	28		217	187	171	139	95	46							
140 PR24 N/18	15	20	32		244	211	193	157	107	51							
140 PR24 N/22	18,50	25	40		299	257	236	192	130	63							
140 PR24 N/26	22	30	47,5		353	304	278	226	154	74							
140 PR24 N/31	26	35	55		421	363	332	270	184	88							
140 PR24 N/36	30	40	62,5		489	421	386	314	213	103							

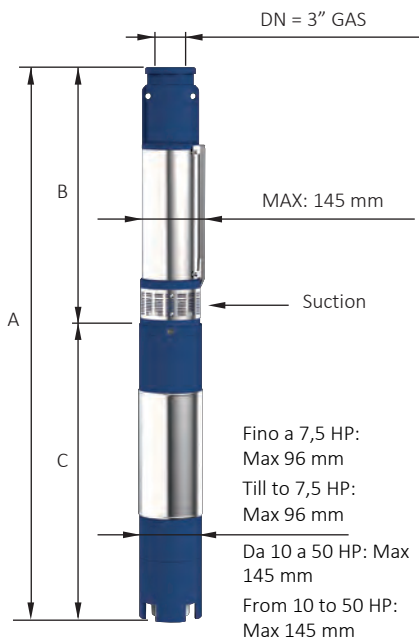

Motor 50 Hz - 2900 rpm	Overall dimensions and weights				
Type	A mm Tri	B mm	C mm Tri	M kg Tri	P kg
140 PR24 N/04	1102	545	557	19	14
140 PR24 N/05	1187	590	597	22	16
140 PR24 N/07	1378	680	698	27	17
140 PR24 N/09	1588	770	818	32	18
140 PR24 N/11	1611	860	751	60	21
140 PR24 N/13	1761	950	811	65	23
140 PR24 N/16	1926	1085	841	70	26
140 PR24 N/18	2106	1175	931	75	28
140 PR24 N/22	2346	1355	991	83	31
140 PR24 N/26	2606	1535	1071	92	35
140 PR24 N/31	2941	1760	1181	100	39
140 PR24 N/36	3236	1985	1251	108	45



140 PRX

Suction cage and delivery bowl
(with cap valve) in AISI 304 casted

n% = Pump efficiency kW/st
= Stage absorption

Max 69,5%
Max 0,83

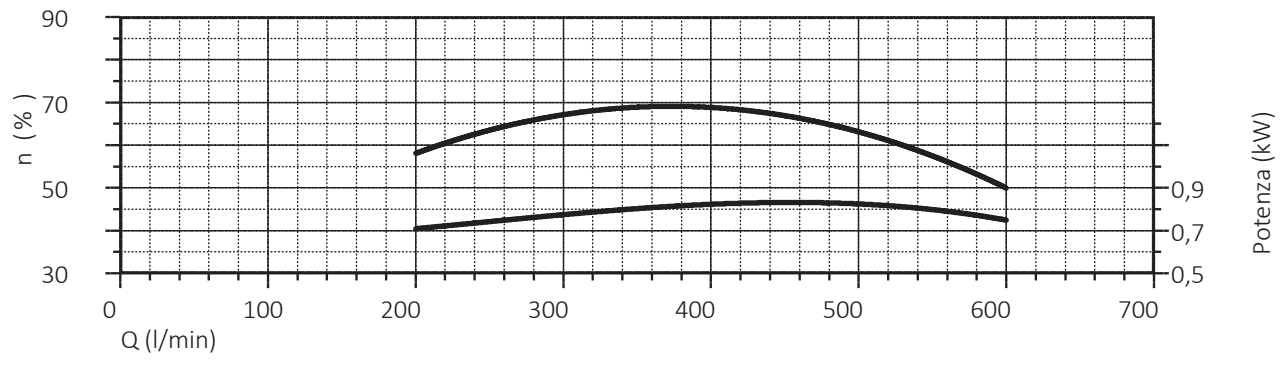
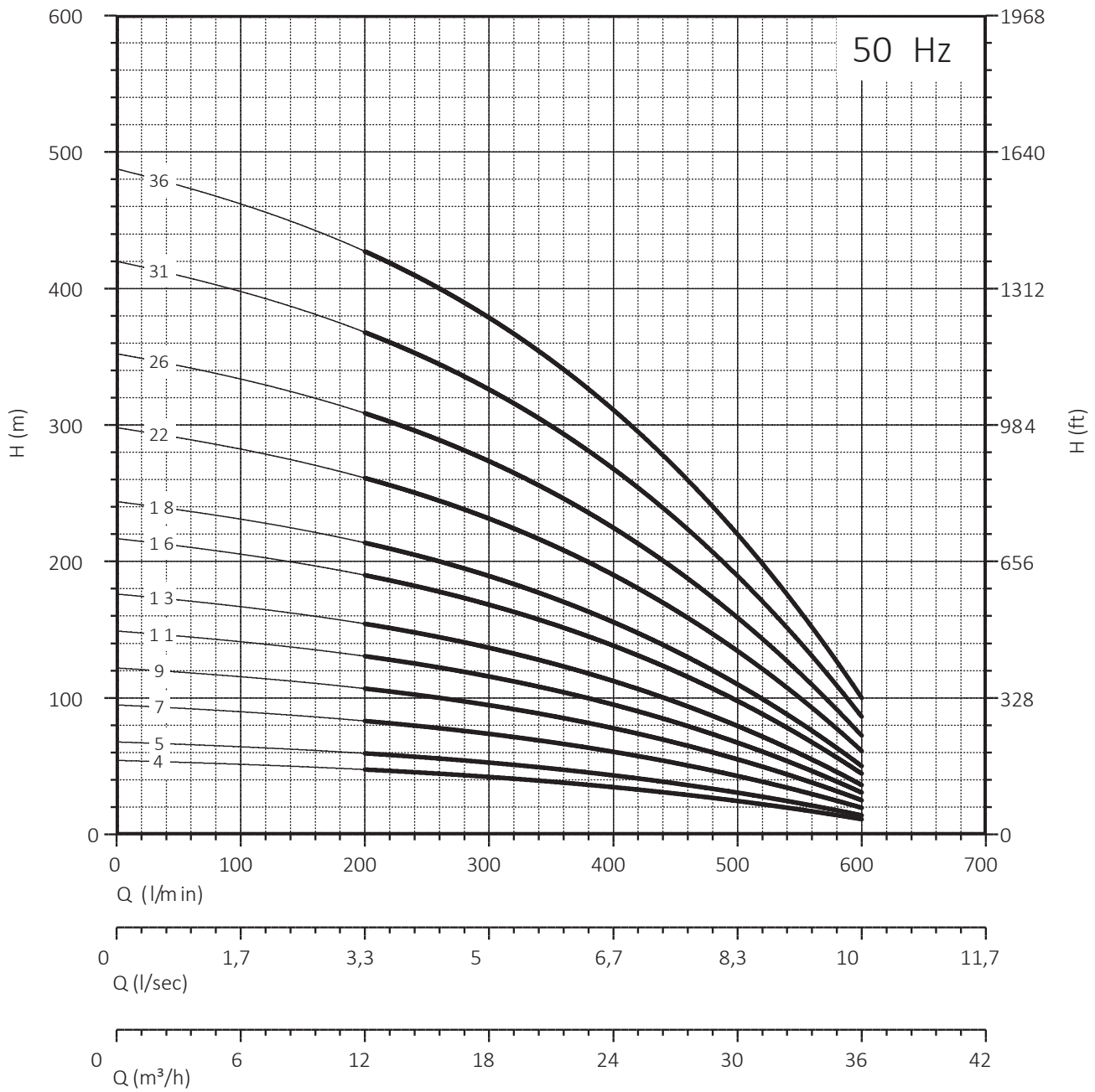
6" 140 PR / PRX 24 - HYDRAULIC PERFORMANCES



NPSH (m)	25%	50%	75%	100%
140 PR 24 - 140 PRX 24	3	3	4,5	6,6

Maximum Sand Content :400gr/m³

6" 140 PR / PRX 34 - HYDRAULIC PERFORMANCES

Motor				50 Hz - 2900 rpm		Q = Capacity					
Type	Power		V 400	l/min	0	300	400	500	600	700	800
	kW	HP	A	l/sec	0	5	6,67	8,33	10	11,67	13,33
				m ³ /h	0	18	24	30	36	42	48
140 PR34 N/04	5,50	7,5	12,5	H[m]	56	53	49	44	37	29	17
140 PR34 N/05	7,50	10	17,5		71	67	62	55	47	36	22
140 PR34 N/06	9,20	12,5	21		85	80	74	66	56	43	26
140 PR34 N/08	11	15	24,5		113	106	98	88	74	57	35
140 PR34 N/09	13	17,5	28		127	120	111	99	84	64	39
140 PR34 N/10	15	20	32		141	133	123	110	93	72	43
140 PR34 N/13	18,50	25	40		183	173	160	143	121	93	56
140 PR34 N/16	22	30	47,5		226	213	197	176	149	115	69
140 PR34 N/19	26	35	55		268	253	234	209	177	136	82
140 PR34 N/21	30	40	62,5		296	279	258	231	195	150	91
140 PR34 N/26	37	50	78		367	346	320	286	242	186	113

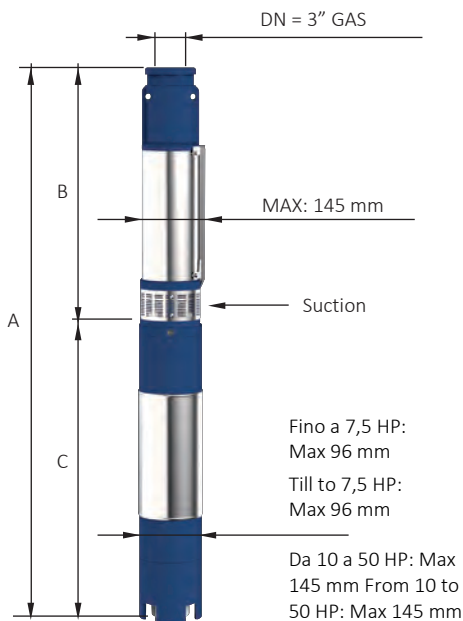

Motor 50 Hz - 2900 rpm	Overall dimensions and weights				
Type	A mm Tri	B mm	C mm Tri	M kg Tri	P kg
140 PR34 N/04	1307	609	698	27	16,5
140 PR34 N/05	1371	670	701	55	17
140 PR34 N/06	1482	731	751	60	18
140 PR34 N/08	1664	853	811	65	19
140 PR34 N/09	1755	914	841	70	20
140 PR34 N/10	1938	1007	931	75	21
140 PR34 N/13	2181	1190	991	83	23
140 PR34 N/16	2444	1373	1071	92	26
140 PR34 N/19	2769	1588	1181	100	28
140 PR34 N/21	2961	1710	1251	108	30
140 PR34 N/26	3356	2015	1341	118	33



140 PRX

Suction cage and delivery bowl
(with cap valve) in AISI 304 casted

n% = Pump efficiency kW/st
= Stage absorption

Max 67,5%
Max 1,40

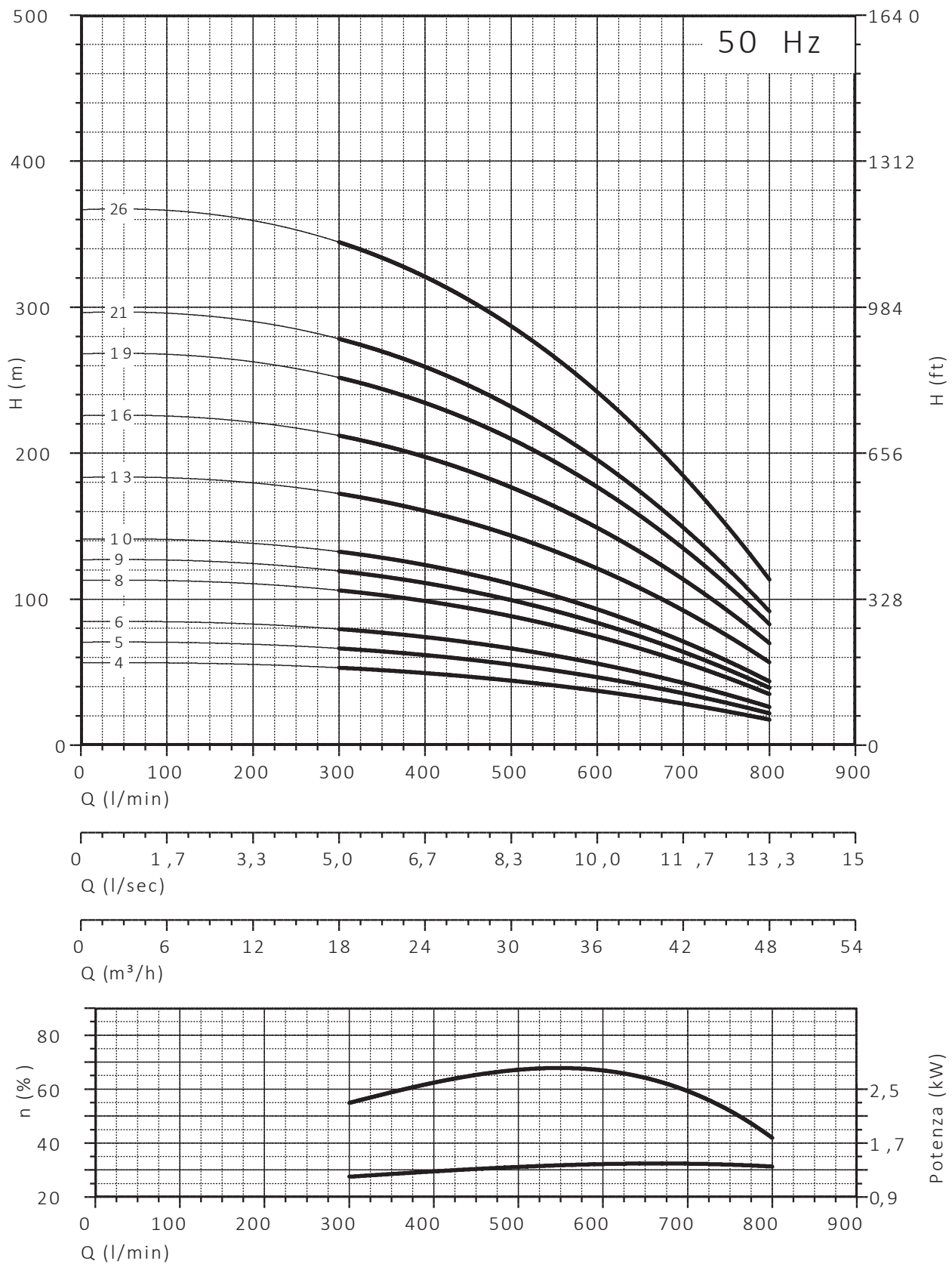
6" 140 PR / PRX 34 - HYDRAULIC PERFORMANCES



NPSH (m)	25%	50%	75%	100%
140 PR 34 - 140 PRX 34	3,4	3,4	3,8	8

Maximum Sand Content :400gr/m³

SPARE PARTS - 6" 140 PR /PRX

140 PRX

(AISI 304)

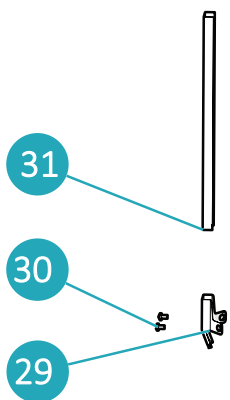
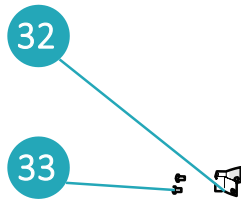
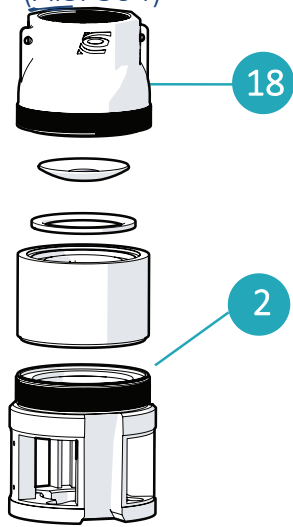

140 PR

with cap valve
(cast iron)

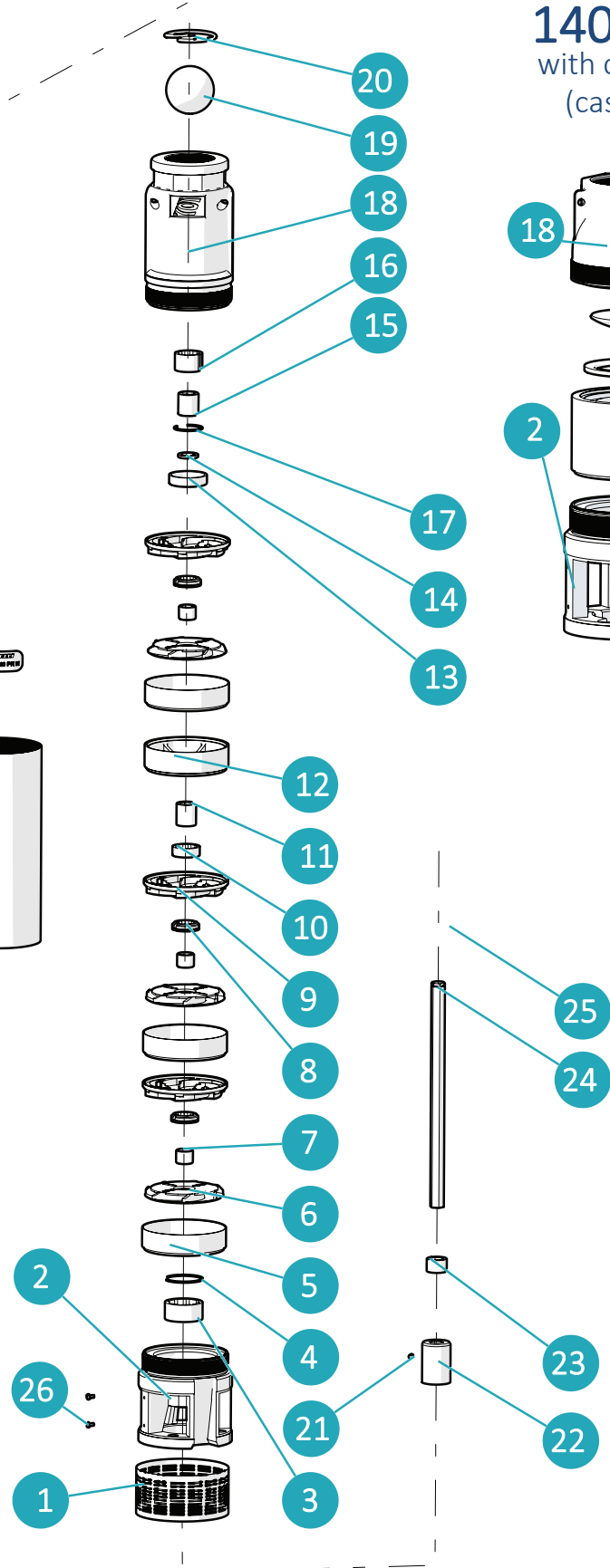
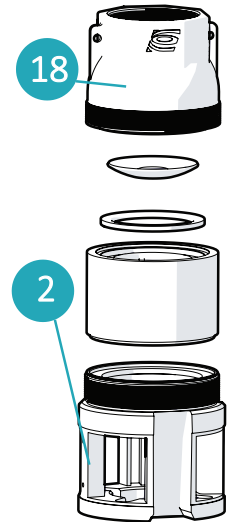

SPARE PARTS - 6" 140 PR / PRX

140 PR				
N.CODE	DESCRIZIONE (Italiano)	MATERIALE (Italiano)	DESCRIPTION (English)	MATERIAL (English)
1	SUCCHERUOLA	ACCIAIO INOX AISI 304	SUCTION STRAINER	AISI 304
2 *	GABBIA DI ASPIRAZIONE	GHISA	SUCTION CAGE	CAST IRON
3	BRONZINA PER GABBIA	GOMMA	BEARING BUSH FOR SUCTION CAGE	RUBBER NBR
4	SEEGER BRONZINA	ACCIAIO INOX AISI 304	SEEGER BEARING BUSH	AISI 304
5	ELEMENTO INTERMEDIO	ACCIAIO INOX AISI 304	INTERMEDIATE CASING	AISI 304
6	GIRANTE	NORYL GFN2	IMPELLER	NORYL GFN2
7	DISTANZIATORE INTERMEDIO	ACCIAIO INOX AISI 304	INTERMEDIATE SPACER	AISI 304
8	BRONZINA DIFFUSORE	GOMMA	DIFFUSER BEARING BUSH	RUBBER NBR
9	DIFFUSORE	NORYL GFN2	DIFFUSER	NORYL GFN2
10	BRONZINA SUPPORTO INTERMEDIO	GOMMA	INTERMEDIATE BEARING BUSH	RUBBER NBR
11	DISTANZIATORE INTERMEDIO	ACCIAIO INOX AISI 304	INTERMEDIATE SPACER	AISI 304
12	SUPPORTO INTERMEDIO	NORYL GFN2	INTERMEDIATE SUPPORT	NORYL GFN2
13	PARASABBIA	NORYL GFN2	SAND GUARD	NORYL GFN2
14	ANELLO DISTANZIALE PARASABBIA	POLICARBONATO	SPACER RING SAND GUARD	POLYCARBONATE
15	DISTANZIATORE SUPERIORE	ACCIAIO INOX AISI 304	UPPER SPACER	AISI 304
16	BRONZINA MANDATA	GOMMA	BEARING BUSH FOR DELIVERY BOWL	RUBBER NBR
17	SEEGER BLOCCA BRONZINA	ACCIAIO INOX AISI 304	SEEGER BEARING BUSH	AISI 304
18 *	MANDATA	GHISA	DELIVERY BOWL	CAST IRON
19	SFERA	GOMMA 70 SHORE	BALL	RUBBER NBR 70 SHORE
20	ANELLO TENUTA SFERA	ACCIAIO INOX AISI 304	STOP RING FOR DELIVERY BOWL	AISI 304
21	GRANO PER GIUNTO	ACCIAIO INOX AISI 304	SCREW	AISI 304
22	GIUNTO DI TRAINO	ACCIAIO INOX AISI 304	JOINT	AISI 304
23	DISTANZIATORE PRIMA GIRANTE	POLICARBONATO	SPACER FIRST IMPELLER	POLYCARBONATE
24	ALBERO POMPA	ACCIAIO INOX AISI 304	PUMP SHAFT	AISI 420
25	SEEGER	ACCIAIO INOX AISI 304	SEEGER	AISI 304
26	N.2 VITI M4 X 8 PER SUCCHERUOLA	ACCIAIO INOX AISI 304	N.2 SCREW M4X8 SUCTION STRAINER	AISI 304
27	CAMICIA	ACCIAIO INOX AISI 304	SLEEVE	AISI 304
28	ETICHETTA ADESIVA	POLIESTERE	ADHESIVE LABEL	POLYESTER
29	STAFFETTA INFERIORE	ACCIAIO INOX AISI 304	LOWER FLANGE	AISI 304
30	N.2 VITI M4 X 10 PER STAFFETTA INFERIORE	ACCIAIO INOX AISI 304	N.2 SCREW M4X10 FOR LOWER FLANGE	AISI 304
31	COPRICAVO	ACCIAIO INOX AISI 304	COVER CABLE	AISI 304
32	STAFFETTA SUPERIORE	ACCIAIO INOX AISI 304	UPPER FLANGE	AISI 304
33	N.2 VITI M4 X 10 PER STAFFETTA SUPERIORE	ACCIAIO INOX AISI 304	N.2 SCREW M4X10 FOR UPPER FLANGE	AISI 304

N.CODE	DESCRIPTION (Français)	MATÉRIEL (Français)	DESCRIPCIÓN (Español)	MATERIAL (Español)
1	CREPINE	ACIER INOXYDABLE AISI 304	REJILLA	ACERO INOXYDABLE AISI 304
2 *	CAGE D'ASPIRATION	FORTE	CUERPO DE ASPIRACION	HIERRO FUNDIDO
3	BEARING BUSH POUR CAGE D'ASPIRATION	CAOUTCHOUC	COJINETE CUERPO DE ASPIRACION	GOMA NBR
4	SEEGER BEARING BUSH	ACIER INOXYDABLE AISI 304	SEEGER POR COJINETE	ACERO INOXYDABLE AISI 304
5	ELEMENT INTERMEDIARE	ACIER INOXYDABLE AISI 304	ELEMENTO INTERMEDIO	ACERO INOXYDABLE AISI 304
6	ROUE	NORYL GFN2	IMPULSOR	NORYL GFN2
7	ENTRETOISE INTERMEDIARE	ACIER INOXYDABLE AISI 304	DISTANCIADOR INTERMEDIO	ACERO INOXYDABLE AISI 304
8	DIFFUSEUR BEARING BUSH	CAOUTCHOUC	COJINETE DIFUSOR	GOMA NBR
9	DIFFUSEUR	NORYL GFN2	DIFUSOR	NORYL GFN2
10	COUSSINET BEARING BUSH	CAOUTCHOUC	COJINETE SOPORTE INTERMEDIO	GOMA NBR
11	ENTRETOISE INTERMEDIARE	ACIER INOXYDABLE AISI 304	DISTANCIADOR INTERMEDIO	ACERO INOXYDABLE AISI 304
12	SUPPORT INTERMEDIARE	NORYL GFN2	SOPORTE INTERMEDIO	NORYL GFN2
13	PARA SABLE	NORYL GFN2	PROTECTOR ARENA	NORYL GFN2
14	BAGUE ENTRETOISE PARA SABLE	TECHNOPOLYMER	ANILLO DISTANCIADOR PROTECTOR ARENA	TECHNOPOLYMER
15	BRIDE ENTRETOISE	ACIER INOXYDABLE AISI 304	DISTANCIADOR SUPERIOR	ACERO INOXYDABLE AISI 304
16	BEARING BUSH POUR REFOULEMENT	CAOUTCHOUC	COJINETE CUERPO DE IMPULSION	RUBBER NBR
17	SEEGER BEARING BUSH	ACIER INOXYDABLE AISI 304	SEEGER COJINETE	ACERO INOXYDABLE AISI 304
18 *	REFOULEMENT	FORTE	CUERPO DE IMPULSION	HIERRO FUNDIDO
19	BOULE	CAOUTCHOUC 70 SHORE	ESFERA	RUBBER NBR 70 SHORE
20	ANNEAU DE SUBSISTANCE	ACIER INOXYDABLE AISI 304	ANILLO PARA ESFERA	ACERO INOXYDABLE AISI 304
21	VIS	ACIER INOXYDABLE AISI 304	TORNILLO POR ACOPLAMIENTO	ACERO INOXYDABLE AISI 304
22	JOINT	ACIER INOXYDABLE AISI 304	ACOPLAMIENTO	ACERO INOXYDABLE AISI 304
23	ENTRETOISE PREMIERE ROUE	TECHNOPOLYMER	DISTANCIADOR PRIMER IMPULSOR	TECHNOPOLYMER
24	ARBRE POMPE	ACIER INOXYDABLE AISI 304	EJE DE BOMBA	ACERO INOXYDABLE AISI 420
25	SEEGER	ACIER INOXYDABLE AISI 304	SEEGER	ACERO INOXYDABLE AISI 304
26	N.2 VIS M4X8 POUR CREPINE	ACIER INOXYDABLE AISI 304	N.2 TORNILLOS REJILLA	ACERO INOXYDABLE AISI 304
27	CHEMISE	ACIER INOXYDABLE AISI 304	CAMISA	ACERO INOXYDABLE AISI 304
28	ADHESIVE ÉTIQUETTE	PLASTIQUE	ETIQUETA	PLASTICO
29	BRIDE INFERIEURE	ACIER INOXYDABLE AISI 304	GRAPA INFERIOR	ACERO INOXYDABLE AISI 304
30	N.2 VIS M4X10 POUR BRIDE INFERIEURE	ACIER INOXYDABLE AISI 304	N.2 TORNILLOS GRAPA INFERIOR	ACERO INOXYDABLE AISI 304
31	PROTECTION CABLE	ACIER INOXYDABLE AISI 304	PARACABLE	ACERO INOXYDABLE AISI 304
32	BRIDE SUPERIEURE	ACIER INOXYDABLE AISI 304	GRAPA SUPERIOR	ACERO INOXYDABLE AISI 304
33	N.2 VIS M4X10 POUR BRIDE SUPERIEURE	ACIER INOXYDABLE AISI 304	N.2 TORNILLOS GRAPA SUPERIOR	ACERO INOXYDABLE AISI 304

*** 140 PRX**

ACCIAIO INOX AISI 304
 AISI 304
 ACIER INOXYDABLE AISI 304 ACERO
 INOXYDABLE AISI 304

SPARE PARTS - 6" 140 PS /PSX

140 PR
with cap valve
(cast iron)

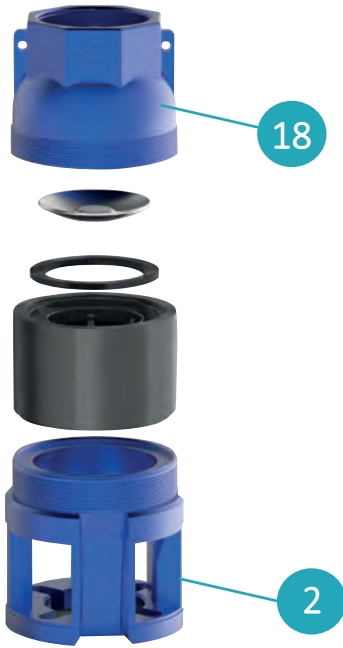

140 PRX
AISI 304

